



P.O. Box 65
No. 4 Executive Circle
Arkadelphia, AR 71923
(870)246-5757
FAX 1-870-246-3341
E-mail: arkadelphia@kingwoodforestry.com



Other Kingwood Locations:
P.O. Box 1290
145 Greenfield Drive
Monticello, AR 71657
(870)367-8567
FAX 1-870-367-8424

4414 Galleria Oaks
P.O. Box 5887
Texarkana, TX 75505
(903)831-5200
FAX 1-903-831-9988

**Listings #
4653**

NOTICE OF LAND SALE

CANFIELD EAST TRACT

-Mature Pine and Hardwood Tract near Lake Erling-

Kingwood Forestry Services, Inc. has been authorized to manage the sale of 40 acres, more or less, in Lafayette County, Arkansas. Please visit our website at www.kingwoodforestry.com to view maps and photographs listing #4653.

Location: The **Canfield East Tract** (Listing #4653) is located one and one-half (1½) miles east of Canfield and is further described as NW¼ of SE¼, Section 17, Township 18 South, Range 24 West, containing 40 acres, more or less, Lafayette County, Arkansas (see attached maps).

Tract Description: **Canfield East Tract (#4653)** can be accessed via woods roads through adjoining timberland from Highway 360. Neighbor has given permission for access to inspect tract but will meet with successful buyer to coordinate future access. Merchantable timber consists of good quality mature pine and hardwood. Site index for loblolly pine averages 90 feet (base age 50) on Guyton silt loam soils. Kingwood Forestry conducted a twenty-percent (20%) inventory of merchantable timber (8 cruise lines running north-south) in June 2018. Based on the inventory, estimated tree counts and timber volumes are as follows:

Pine Sawtimber	710 Trees	87,607 Board Feet	683 Tons
Pine Chip n' Saw	498 Trees	20,257 Board Feet	239 Tons
Oak Sawtimber	255 Trees	37,650 Board Feet	301 Tons
Misc. Sawtimber	282 Trees	37,928 Board Feet	304 Tons
Pine Pulpwood	1,564 Trees	-----	381 Tons
Hardwood Pulpwood	3,961 Trees	-----	1,051 Tons

Due to variations in cruising methods, utilization standards and scaling practices, tree counts and volume estimates cannot be guaranteed. Volume reports in Tons and Board Feet are included. Additional timber volume reports (tree counts by species, diameter, and height) are available on our website at: <http://www.kingwoodforestry.com/real-estate.html>

Method of Sale: This land and timber is offered for sale for \$139,000.00. An offer form is attached. Mailed offers should be addressed to Kingwood Forestry Services, Inc., P.O. Box 65, Arkadelphia, AR 71923 with **"Canfield East Land Sale"** clearly marked in the lower left corner of the envelope to protect security of the offer. On mailed offers, please call our office to confirm receipt of offer. Completed offer forms may also be hand-delivered to **#4 Executive Circle, Arkadelphia, AR 71923**, sent by fax to **870-246-3341** or by e-mail to arkadelphia@kingwoodforestry.com. All faxed/e-mailed offers will be immediately acknowledged; please await confirmation that your faxed/e-mailed offer has been received. No verbal telephone offers will be accepted.

— Continued on back of this page —

NOTICE OF LAND SALE
- CANFIELD EAST TRACT -
LAFAYETTE COUNTY, ARKANSAS

Conditions of Sale:

1. The landowner reserves the right to accept or reject any offer or to reject all offers.
2. Offers submitted will remain valid for five (5) business days. Upon acceptance of an offer a Contract of Sale, with earnest money in the amount of ten percent (10%) of purchase price, will be executed between the successful bidder and landowner within seven (7) business days. A sample Contract of Sale may be provided in advance upon request. Terms are cash at closing. Closing is expected to be held within forty-five (45) days of offer acceptance.
3. Only offers for a specific dollar amount will be accepted. The parcel is being sold in their entirety for single sum and not on a per-acre basis. Advertised acreage is believed to be correct, but is not guaranteed. Offer price is for entire tract, regardless of acreage. Seller will not provide survey. The attached tract map is thought to be accurate but should not be considered survey plat.
4. Conveyance will be by Warranty Deed, subject to all previous mineral conveyances, reservations and exceptions, to any valid rights-of-way, easements, leaseholds, and to any protective covenants or restrictions, which may have been recorded affecting the property, with title assured through seller-provided title insurance policy. No environmental inspection or representation has been or will be made by seller. Owner will reserve any mineral rights they may own.
5. Seller will pay prorated property taxes (to date of closing), deed preparation, and one-half (½) of deed stamps. Buyer will pay recording fees and one-half (½) of deed stamps.
6. Local title company will conduct the closing with buyer and seller each paying one-half (½) of settlement / closing fees.
7. If prospective buyers or their agents wish to inspect the property, such property inspections shall be done at reasonable times during daylight hours. Prospective buyers and their agents understand and acknowledge that while on the property, prospective buyers and their agents assume all liability and shall indemnify Seller and its agents, property managers and Kingwood Forestry Services from and against all claims, demands, or causes of action, of every kind, nature and description relating to its access to or presence on the property.
8. Hunting equipment (such as deer stands, feeders, trail cameras, etc.) and any other man-made items found on the property do not convey unless stated otherwise.
9. Kingwood Forestry is the real estate firm acting as agent for the seller. All information presented in this prospectus is believed to be accurate. Prospective buyers are advised to verify information presented in this sale notice.
10. Questions regarding the land sale should be directed to licensed broker Pete Prutzman or licensed agents Drew Griffin, Jimmy Don Thomas or Brian Clark of Kingwood Forestry Services at 870-246-5757 or e-mail: arkadelphia@kingwoodforestry.com



NOTICE OF LAND SALE
"Canfield East (Section 17) Tract" - Listing #4653
NW¼ of SE¼, Sec. 17, T18S, R24W, Lafayette County, Arkansas
Containing 40 acres, more or less

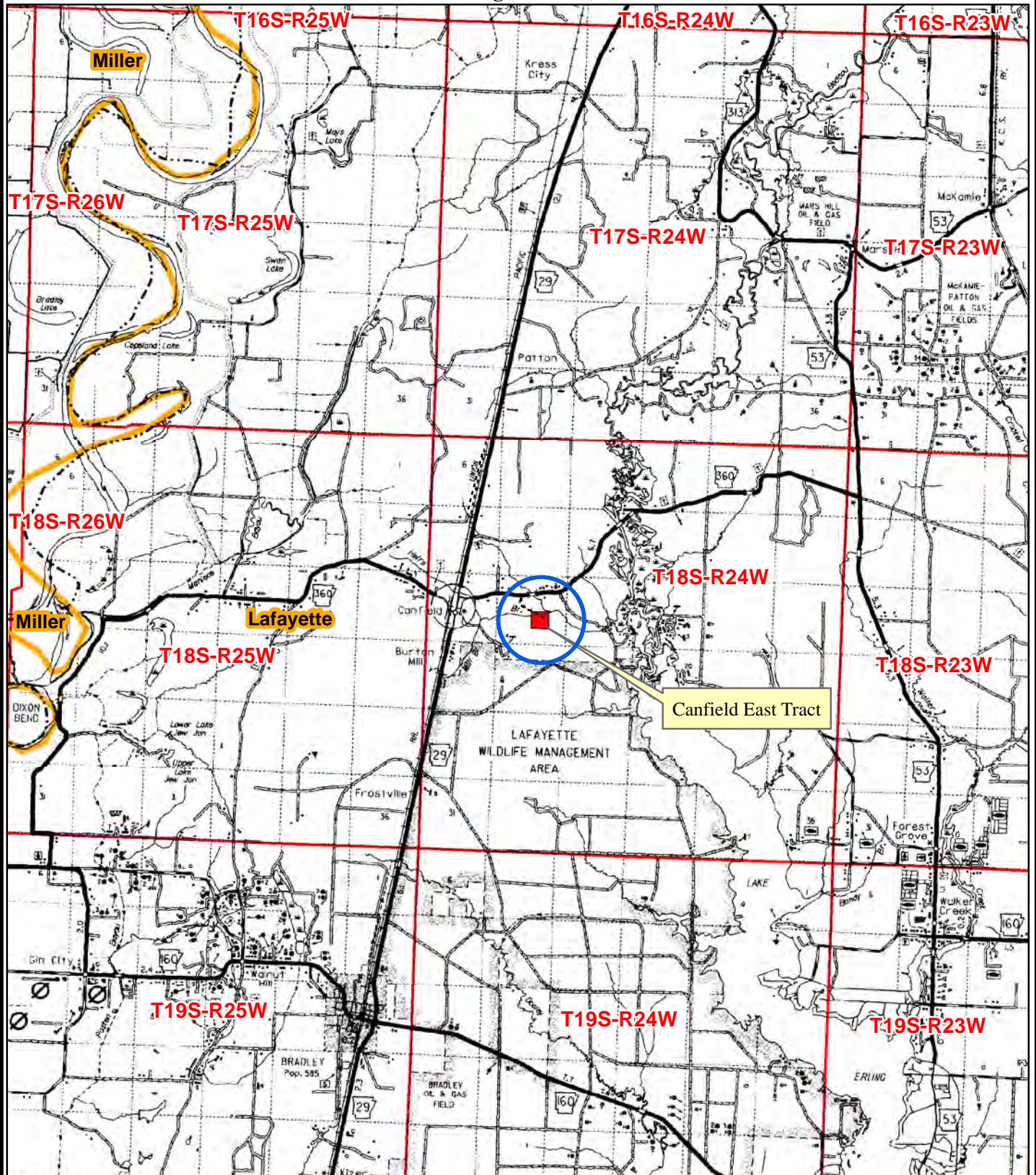

0 0.5 1 2 3 4
Miles



Date: 8/1/2018
Drawn By: JDT

NOTICE OF LAND SALE - Listing #4653
"Canfield East (Section 17) Tract"
 NW¼ of SE¼, Sec. 17, T18S, R24W, Lafayette County, Arkansas
 Containing 40 acres, more or less

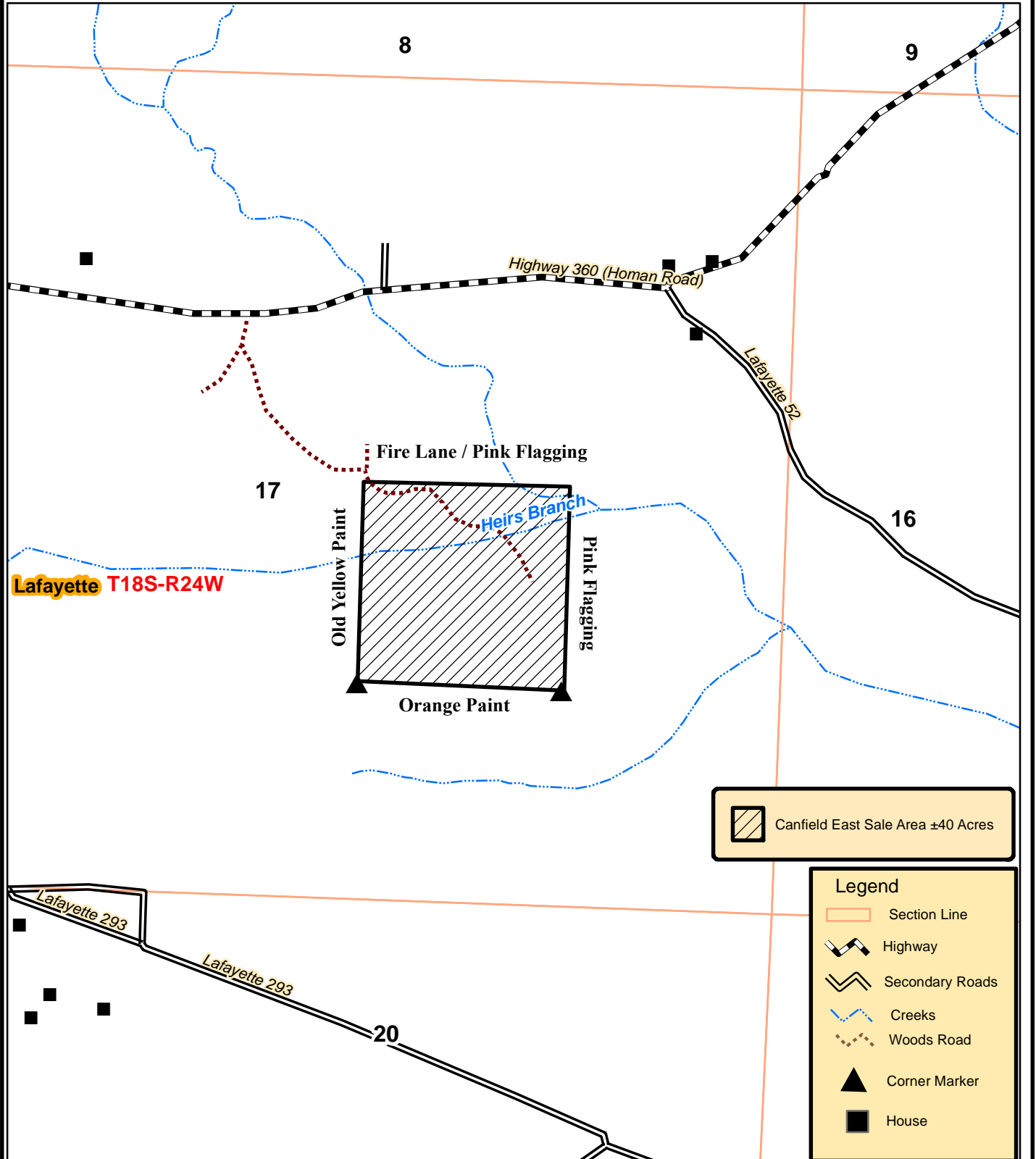

0 0.125 0.25
 Miles



Created: July, 2018
 By: ATG

NOTICE OF LAND SALE - Listing #4653
"Canfield East (Section 17) Tract"
NW¼ of SE¼, Sec. 17, T18S, R24W, Lafayette County, Arkansas
Containing 40 acres, more or less



0 0.125 0.25
Miles



Date: 7/5/2018
Drawn By: JDT

NOTICE OF LAND SALE
"Canfield East (Section 17) Tract"
NW¼ of SE¼, Sec. 17, T18S, R24W, Lafayette County, Arkansas
Containing 40 acres, more or less

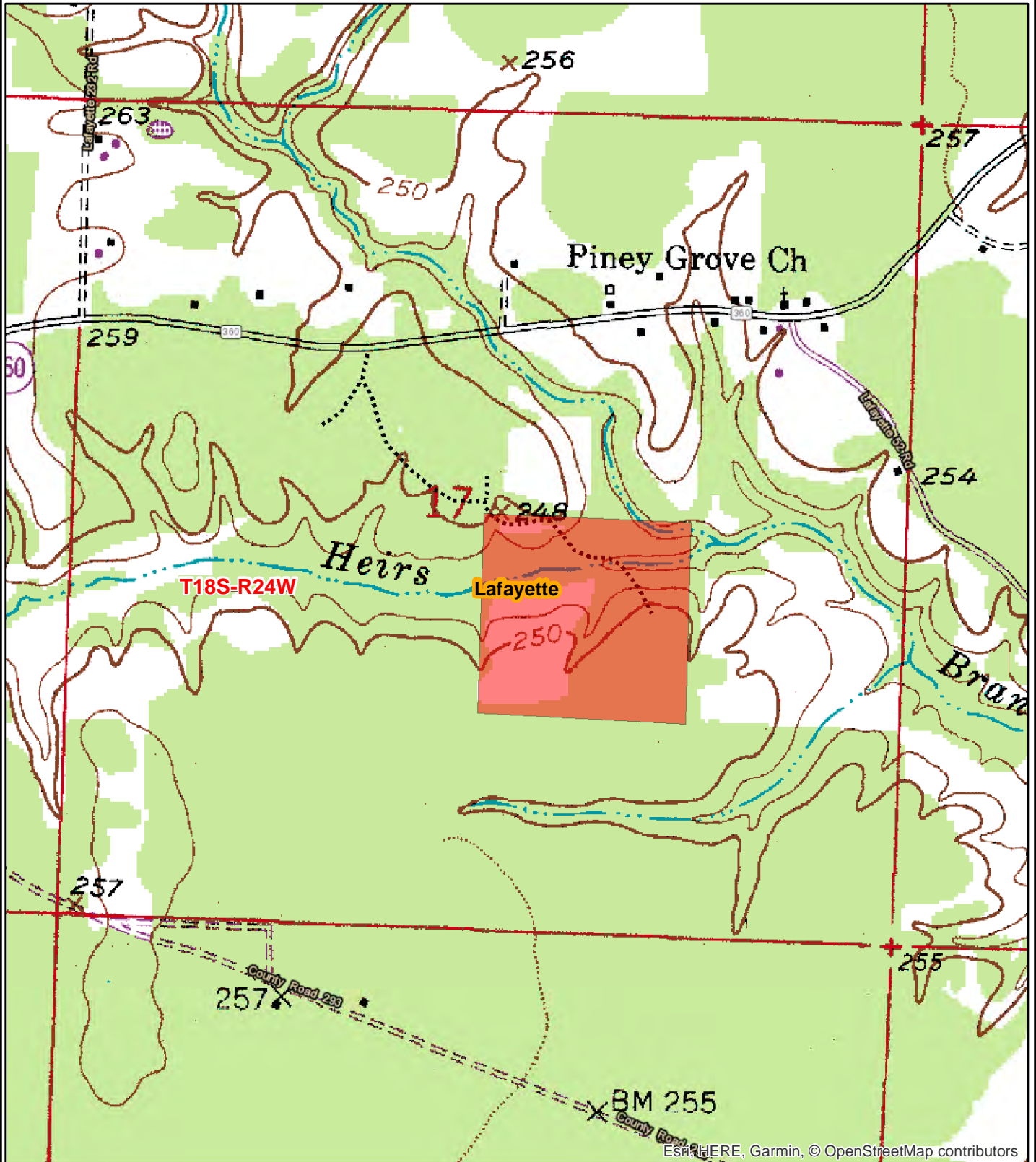

0 0.125 0.25
Miles



Date: 7/5/2018
Drawn By: JDT



Kingwood Forestry Services
No. 4 Executive Circle
Arkadelphia, AR 71923

Phone: 870-246-5757
Fax: 870-246-3341
Email: arkadelphia@kingwoodforestry.com
Website: www.kingwoodforestry.com

Timber Volume Estimates

Stratum: Canfield East

Acres: 40.00

Plots: 80

Cruiser: ATG

Cruise Date: 07/10/2018

Cruise Type: Point

Plot Size/BAF: 15.00

Pine

<i>Product</i>	<i>Stratum Total</i>			<i>Per Acre</i>				<i>Average Tree</i>	
	<i>Trees</i>	<i>Tons</i>	<i>Doyle BF</i>	<i>BA</i>	<i>Trees</i>	<i>Tons</i>	<i>Doyle BF</i>	<i>DBH</i>	<i>Height</i>
Sawtimber	710	683	87,607	22.3	18	17.1	2,190.2	14.9	36.3
Chip-N-Saw	498	239	20,257	7.4	12	6.0	506.4	10.4	37.4
Pulpwood	1,564	381	0	11.3	39	9.5	0.0	7.1	39.9
Topwood	0	175	0	0.0	0	4.4	0.0	0.0	0.0
Class Total	2,772	1,478	107,864	41.0	69	36.9	2,696.6	9.7	38.5

Oak

<i>Product</i>	<i>Stratum Total</i>			<i>Per Acre</i>				<i>Average Tree</i>	
	<i>Trees</i>	<i>Tons</i>	<i>Doyle BF</i>	<i>BA</i>	<i>Trees</i>	<i>Tons</i>	<i>Doyle BF</i>	<i>DBH</i>	<i>Height</i>
Sawtimber	255	301	37,650	12.0	6	7.5	941.2	18.3	24.9
Pulpwood	283	117	0	3.7	7	2.9	0.0	9.6	32.8
Class Total	537	418	37,650	15.7	13	10.4	941.2	13.7	29.1

Misc. Hardwood

<i>Product</i>	<i>Stratum Total</i>			<i>Per Acre</i>				<i>Average Tree</i>	
	<i>Trees</i>	<i>Tons</i>	<i>Doyle BF</i>	<i>BA</i>	<i>Trees</i>	<i>Tons</i>	<i>Doyle BF</i>	<i>DBH</i>	<i>Height</i>
Sawtimber	282	304	37,928	12.0	7	7.6	948.2	17.5	27.1
Pulpwood	3,678	934	0	33.0	92	23.4	0.0	7.7	31.5
Class Total	3,959	1,238	37,928	45.0	99	30.9	948.2	8.4	31.2
StratumTotal	7,268	3,133	183,442	101.7	182	78.3	4,586.0	9.3	33.9

**ADDITIONAL TIMBER VOLUME REPORT
CANFIELD EAST TRACT**



Kingwood Forestry Services
No. 4 Executive Circle
Arkadelphia, AR 71923

Phone: 870-246-5757
Fax: 870-246-3341
Email: arkadelphia@kingwoodforestry.com
Website: www.kingwoodforestry.com

Timber Volume Estimates

Stratum: Canfield East

Acres: 40.00

Plots: 80.00

Cruiser: ATG

Cruise Date: 07/10/2018

Cruise Type: Point

Plot Size/BAF: 15.00

Pine

Natural Lob

Stratum Total

Per Acre

Average Tree

Sawtimber	DBH	Trees	Tons	Doyle BF	Cu. Ft. IB	BA	Trees	Tons	Doyle BF	Cu. Ft. IB	SL CFT/Ft	Height
	12	154	71	7,185	2,135	3.0	4	1.8	179.6	53.4	0.53	26.0
	13	81	50	5,146	1,498	1.9	2	1.2	128.7	37.5	0.60	30.9
	14	159	120	13,655	3,643	4.3	4	3.0	341.4	91.1	0.68	33.5
	15	119	115	13,965	3,529	3.6	3	2.9	349.1	88.2	0.75	39.7
	16	43	52	6,436	1,600	1.5	1	1.3	160.9	40.0	0.81	46.5
	17	49	64	8,523	1,976	1.9	1	1.6	213.1	49.4	0.92	44.4
	18	28	42	5,721	1,289	1.2	1	1.0	143.0	32.2	1.01	45.8
	19	10	14	2,152	438	0.5	0	0.4	53.8	10.9	1.20	36.5
	20	24	46	6,911	1,434	1.3	1	1.1	172.8	35.8	1.22	49.7
	21	11	24	3,793	751	0.7	0	0.6	94.8	18.8	1.38	48.5
	22	16	34	5,443	1,050	1.0	0	0.8	136.1	26.2	1.45	46.3
	23	8	20	3,304	642	0.5	0	0.5	82.6	16.1	1.50	56.5
	24	5	16	2,669	509	0.4	0	0.4	66.7	12.7	1.58	64.5
	25	5	16	2,705	499	0.4	0	0.4	67.6	12.5	1.77	56.5
Sawtimber Total	14.9	710	683	87,607	20,993	22.3	18	17.1	2,190.2	524.8	0.81	36.3

Chip-N-Saw	DBH	Trees	Tons	Doyle BF	Cu. Ft. IB	BA	Trees	Tons	Doyle BF	Cu. Ft. IB	SL CFT/Ft	Height
	10	284	120	10,153	3,393	3.9	7	3.0	253.8	84.8	0.34	35.4
	11	214	119	10,104	3,392	3.5	5	3.0	252.6	84.8	0.39	40.1
Chip-N-Saw Total	10.4	498	239	20,257	6,785	7.4	12	6.0	506.4	169.6	0.36	37.4

Pulpwood	DBH	Trees	Tons	Doyle BF	Cu. Ft. IB	BA	Trees	Tons	Doyle BF	Cu. Ft. IB	SL CFT/Ft	Height
	5	280	29	0	755	1.0	7	0.7	0.0	18.9	0.00	31.1
	6	351	56	0	1,493	1.7	9	1.4	0.0	37.3	0.00	36.6

Timber Volume Estimates

Stratum: Canfield East

Acres: 40.00

Plots: 80.00

Cruiser: ATG

Cruise Date: 07/10/2018

Cruise Type: Point

Plot Size/BAF: 15.00

Pine

Natural Lob		Stratum Total						Per Acre			Average Tree	
Pulpwood	DBH	Trees	Tons	Doyle BF	Cu. Ft. IB	BA	Trees	Tons	Doyle BF	Cu. Ft. IB	SL CFT/Ft	Height
	7	178	41	0	1,115	1.2	4	1.0	0.0	27.9	0.00	41.8
	8	430	125	0	3,471	3.8	11	3.1	0.0	86.8	0.00	42.2
	9	300	116	0	3,260	3.3	7	2.9	0.0	81.5	0.00	46.3
	10	14	7	0	191	0.2	0	0.2	0.0	4.8	0.00	50.4
	11	11	7	0	202	0.2	0	0.2	0.0	5.1	0.00	53.0
Pulpwood Total	7.1	1,564	381	0	10,489	11.3	39	9.5	0.0	262.2	0.00	39.9
Topwood	DBH	Trees	Tons	Doyle BF	Cu. Ft. IB	BA	Trees	Tons	Doyle BF	Cu. Ft. IB	SL CFT/Ft	Height
Topwood Total	0.0	0	175	0	5,595	0.0	0	4.4	0.0	139.9	0.00	0.0
Natural Lob Total	9.7	2,772	1,478	107,864	43,862	41.0	69	36.9	2,696.6	1,096.5	0.63	38.5
Pine Total	9.7	2,772	1,478	107,864	43,862	41.0	69	36.9	2,696.6	1,096.5	0.63	38.5

Oak

Red Oak Spp.		Stratum Total						Per Acre			Average Tree	
Sawtimber	DBH	Trees	Tons	Doyle BF	Cu. Ft. IB	BA	Trees	Tons	Doyle BF	Cu. Ft. IB	SL CFT/Ft	Height
	14	5	2	227	66	0.1	0	0.1	5.7	1.6	0.80	16.5
	15	47	30	2,947	788	1.4	1	0.7	73.7	19.7	0.88	19.0
	16	21	16	1,738	438	0.7	1	0.4	43.4	10.9	0.95	22.3
	17	29	29	3,245	769	1.1	1	0.7	81.1	19.2	1.02	25.9
	18	19	25	2,985	672	0.9	0	0.6	74.6	16.8	1.08	32.2
	19	16	23	2,852	614	0.8	0	0.6	71.3	15.4	1.22	30.6
	20	25	41	5,253	1,082	1.4	1	1.0	131.3	27.0	1.33	32.5
	22	8	13	1,848	356	0.5	0	0.3	46.2	8.9	1.70	26.7
	23	13	25	3,591	669	0.9	0	0.6	89.8	16.7	1.82	29.2
	24	15	24	3,539	651	1.1	0	0.6	88.5	16.3	2.19	20.4

Timber Volume Estimates

Stratum: Canfield East

Acres: 40.00

Plots: 80.00

Cruiser: ATG

Cruise Date: 07/10/2018

Cruise Type: Point

Plot Size/BAF: 15.00

Oak

Red Oak Spp.

Stratum Total

Per Acre

Average Tree

Sawtimber	DBH	Trees	Tons	Doyle BF	Cu. Ft. IB	BA	Trees	Tons	Doyle BF	Cu. Ft. IB	SL CFT/Ft	Height
	26	10	22	3,417	596	0.9	0	0.6	85.4	14.9	2.43	24.5
	28	2	5	738	122	0.2	0	0.1	18.5	3.0	2.84	24.5
Sawtimber Total	18.5	209	256	32,379	6,821	10.2	5	6.4	809.5	170.5	1.29	25.3

Pulpwood	DBH	Trees	Tons	Doyle BF	Cu. Ft. IB	BA	Trees	Tons	Doyle BF	Cu. Ft. IB	SL CFT/Ft	Height
	5	5	0	0	9	0.0	0	0.0	0.0	0.2	0.00	18.9
	6	30	4	0	102	0.1	1	0.1	0.0	2.6	0.00	26.8
	8	35	9	0	248	0.3	1	0.2	0.0	6.2	0.00	33.9
	9	67	21	0	567	0.7	2	0.5	0.0	14.2	0.00	30.9
	10	25	10	0	277	0.3	1	0.3	0.0	6.9	0.00	33.6
	11	26	12	0	330	0.4	1	0.3	0.0	8.2	0.00	30.4
	12	30	19	0	504	0.6	1	0.5	0.0	12.6	0.00	36.4
	13	23	18	0	482	0.5	1	0.5	0.0	12.0	0.00	39.2
	15	6	8	0	202	0.2	0	0.2	0.0	5.0	0.00	50.4
Pulpwood Total	9.6	248	102	0	2,721	3.3	6	2.6	0.0	68.0	0.00	32.7

Red Oak Spp. Total	13.7	457	358	32,379	9,543	13.4	11	9.0	809.5	238.6	1.29	29.3
--------------------	------	-----	-----	--------	-------	------	----	-----	-------	-------	------	------

White Oak Spp.

Stratum Total

Per Acre

Average Tree

Sawtimber	DBH	Trees	Tons	Doyle BF	Cu. Ft. IB	BA	Trees	Tons	Doyle BF	Cu. Ft. IB	SL CFT/Ft	Height
	14	7	3	318	93	0.2	0	0.1	8.0	2.3	0.80	16.5
	15	5	3	281	76	0.2	0	0.1	7.0	1.9	0.92	16.5
	16	16	14	1,485	366	0.6	0	0.3	37.1	9.2	0.93	24.5
	17	5	5	525	122	0.2	0	0.1	13.1	3.1	1.05	24.5
	20	5	10	1,249	256	0.3	0	0.2	31.2	6.4	1.26	40.5
	21	5	6	732	148	0.3	0	0.1	18.3	3.7	1.80	16.5
	24	2	5	680	122	0.2	0	0.1	17.0	3.0	2.09	24.5
Sawtimber Total	17.1	45	44	5,271	1,183	1.9	1	1.1	131.8	29.6	1.12	23.3

Timber Volume Estimates

Stratum: Canfield East

Acres: 40.00

Plots: 80.00

Cruiser: ATG

Cruise Date: 07/10/2018

Cruise Type: Point

Plot Size/BAF: 15.00

Oak

White Oak Spp.

Stratum Total

Per Acre

Average Tree

Pulpwood	DBH	Trees	Tons	Doyle BF	Cu. Ft. IB	BA	Trees	Tons	Doyle BF	Cu. Ft. IB	SL CFT/Ft	Height
	5	10	1	0	20	0.0	0	0.0	0.0	0.5	0.00	20.5
	9	5	2	0	46	0.1	0	0.0	0.0	1.2	0.00	35.5
	11	10	5	0	146	0.2	0	0.1	0.0	3.6	0.00	38.0
	12	10	7	0	181	0.2	0	0.2	0.0	4.5	0.00	40.5
Pulpwood Total	9.3	35	15	0	393	0.5	1	0.4	0.0	9.8	0.00	33.4

White Oak Spp. Total	13.7	80	59	5,271	1,575	2.3	2	1.5	131.8	39.4	1.12	27.7
----------------------	------	----	----	-------	-------	-----	---	-----	-------	------	------	------

Oak Total	13.7	537	418	37,650	11,118	15.7	13	10.4	941.2	278.0	1.26	29.1
-----------	------	-----	-----	--------	--------	------	----	------	-------	-------	------	------

Misc. Hardwood

Misc. Hardwood

Stratum Total

Per Acre

Average Tree

Sawtimber	DBH	Trees	Tons	Doyle BF	Cu. Ft. IB	BA	Trees	Tons	Doyle BF	Cu. Ft. IB	SL CFT/Ft	Height
	14	40	20	1,937	568	1.1	1	0.5	48.4	14.2	0.77	18.5
	15	37	25	2,598	690	1.1	1	0.6	65.0	17.3	0.84	22.1
	16	46	42	4,620	1,176	1.6	1	1.1	115.5	29.4	0.88	28.8
	17	29	34	3,923	952	1.2	1	0.9	98.1	23.8	0.93	35.0
	18	34	35	4,424	983	1.5	1	0.9	110.6	24.6	1.17	24.5
	19	21	24	3,085	664	1.1	1	0.6	77.1	16.6	1.31	23.6
	20	32	56	7,516	1,566	1.8	1	1.4	187.9	39.2	1.27	38.3
	21	23	37	5,274	1,036	1.4	1	0.9	131.8	25.9	1.51	29.7
	22	5	9	1,377	264	0.3	0	0.2	34.4	6.6	1.62	32.5
	23	8	11	1,593	300	0.5	0	0.3	39.8	7.5	2.05	19.2
	25	5	10	1,581	277	0.4	0	0.2	39.5	6.9	2.26	24.5
Sawtimber Total	17.5	282	304	37,928	8,476	12.0	7	7.6	948.2	211.9	1.11	27.1

Pulpwood	DBH	Trees	Tons	Doyle BF	Cu. Ft. IB	BA	Trees	Tons	Doyle BF	Cu. Ft. IB	SL CFT/Ft	Height
----------	-----	-------	------	----------	------------	----	-------	------	----------	------------	-----------	--------

Timber Volume Estimates

Stratum: Canfield East

Acres: 40.00

Plots: 80.00

Cruiser: ATG

Cruise Date: 07/10/2018

Cruise Type: Point

Plot Size/BAF: 15.00

Misc. Hardwood

Misc. Hardwood		Stratum Total					Per Acre				Average Tree	
Pulpwood	DBH	Trees	Tons	Doyle BF	Cu. Ft. IB	BA	Trees	Tons	Doyle BF	Cu. Ft. IB	SL CFT/Ft	Height
	5	605	49	0	1,416	2.1	15	1.2	0.0	35.4	0.00	26.4
	6	1,159	143	0	4,158	5.7	29	3.6	0.0	104.0	0.00	29.1
	7	167	30	0	875	1.1	4	0.7	0.0	21.9	0.00	32.1
	8	409	98	0	2,822	3.6	10	2.4	0.0	70.5	0.00	32.6
	9	381	119	0	3,397	4.2	10	3.0	0.0	84.9	0.00	33.6
	10	406	161	0	4,589	5.5	10	4.0	0.0	114.7	0.00	34.8
	11	215	106	0	3,011	3.5	5	2.7	0.0	75.3	0.00	35.9
	12	147	87	0	2,468	2.9	4	2.2	0.0	61.7	0.00	36.2
	13	151	110	0	3,172	3.5	4	2.8	0.0	79.3	0.00	39.6
	14	22	22	0	600	0.6	1	0.5	0.0	15.0	0.00	46.8
	15	5	6	0	165	0.2	0	0.1	0.0	4.1	0.00	50.4
Pulpwood Total	7.7	3,668	930	0	26,673	32.9	92	23.2	0.0	666.8	0.00	31.5

Misc. Hardwood Total	8.4	3,949	1,234	37,928	35,149	44.9	99	30.8	948.2	878.7	1.11	31.2
----------------------	-----	-------	-------	--------	--------	------	----	------	-------	-------	------	------

Sweetgum		Stratum Total					Per Acre				Average Tree	
Pulpwood	DBH	Trees	Tons	Doyle BF	Cu. Ft. IB	BA	Trees	Tons	Doyle BF	Cu. Ft. IB	SL CFT/Ft	Height
	10	10	4	0	119	0.1	0	0.1	0.0	3.0	0.00	37.3
Pulpwood Total	10.0	10	4	0	119	0.1	0	0.1	0.0	3.0	0.00	37.3
Sweetgum Total	10.0	10	4	0	119	0.1	0	0.1	0.0	3.0	0.00	37.3

Misc. Hardwood Total	8.4	3,959	1,238	37,928	35,268	45.0	99	30.9	948.2	881.7	1.11	31.2
----------------------	-----	-------	-------	--------	--------	------	----	------	-------	-------	------	------

Stratum Total	9.3	7,268	3,133	183,442	90,247	101.7	182	78.3	4,586.0	2,256.2	0.76	33.9
---------------	-----	-------	-------	---------	--------	-------	-----	------	---------	---------	------	------

OFFER FORM
- CANFIELD EAST TRACT -

Send Completed Offer Forms to us:

Mail: P.O. Box 65, Arkadelphia, AR 71923

Fax: 870-246-3341

Hand Deliver: #4 Executive Circle, Arkadelphia, AR 71923

E-mail: arkadelphia@kingwoodforestry.com

Reference is made to Kingwood Forestry Services, Inc. **Canfield East Tract Notice of Land Sale**. I submit the following as offer for the purchase of the tract further described as NW¼ of SE¼, Section 17, Township 18 South, Range 24 West, containing 40 acres, more or less, Lafayette County, Arkansas (see attached maps). The tract is listed at \$139,000.00.

My offer will remain valid for five (5) business days. If my offer is accepted, I am ready, willing, able, and obligated to execute a Contract of Sale within seven (7) business days with earnest money in the amount of ten percent (10%) of purchase price. Closing is expected to be held within forty-five (45) days of offer acceptance. I have read and understand the Method of Sale and Conditions of Sale sections in this notice.

Send offer form to: Kingwood Forestry Services, Inc.
P. O. Box 65, Arkadelphia, AR 71923 or fax to 870-246-3341
E-mail completed Offer Form to arkadelphia@kingwoodforestry.com

Canfield East Tract (Listing #4653: ±40 acres, more or less): \$ _____

Date: _____ Fax No.: _____

Bidder: _____ Phone No.: _____
Printed

Bidder: _____ E-mail: _____
Signed Printed

Address: _____
Street City, State, Zip

AREA BELOW FOR KINGWOOD USE ONLY

Offer Acknowledged by Agent / Broker: _____
Name Date

