



# **Commercial/Industrial Lot**

**12.748± Acres**

**Reeves County | Midland, TX 79772**



**Presented By:**

**Caleb Matott, Broker/Owner**

**[RanchSpecialist@CMRanchRealEstate.com](mailto:RanchSpecialist@CMRanchRealEstate.com) | 432-349-3330**





# Industrial/Commercial Lot 12± Acres 432 Black Bird Dr. | Pecos, TX



Presented By:  
**Caleb Matott, Broker/Owner**  
432-349-3330  
[BigDogRanchSales@mac.com](mailto:BigDogRanchSales@mac.com)

## CM Ranch Real Estate

6800 W. County Rd. 48 | Midland, TX 79707 | 432-219-2220 | [RanchSpecialist@CMRanchRealEstate.com](mailto:RanchSpecialist@CMRanchRealEstate.com)  
[www.CMRanchRealEstate.com](http://www.CMRanchRealEstate.com)





## Property Details:

Approximate Building Sq. Ft.  
Lot Size:  
Current Zoning:  
County:

N/A  
12.748± Acres  
Commercial/No Restrictions  
Reeves

## Property Overview:

Located just minutes from Pecos, Texas in Reeves County and only one mile south of I-20, is a new Industrial/Commercial Development, Pecos Corpus Subdivision. With great water and only \$15,000 per acre of raw land these lots will not last long. Asphalt millings can be provided for an additional price per acre. These Industrial tracts have great access to I-20 with frontage to paved FM Rd 869. No Commercial/Off-Site Water sales allowed.

**Property Website**

Presented By:  
**Caleb Matott, Broker/Owner**  
432-349-3330  
[BigDogRanchSales@mac.com](mailto:BigDogRanchSales@mac.com)

**CM Ranch Real Estate**

6800 W. County Rd. 48 | Midland, TX 79707 | 432-219-2220 | [RanchSpecialist@CMRanchRealEstate.com](mailto:RanchSpecialist@CMRanchRealEstate.com)  
[www.CMRanchRealEstate.com](http://www.CMRanchRealEstate.com)





**432 Black Bird Dr. Pecos, TX 79722**  
**\$191,220.00**

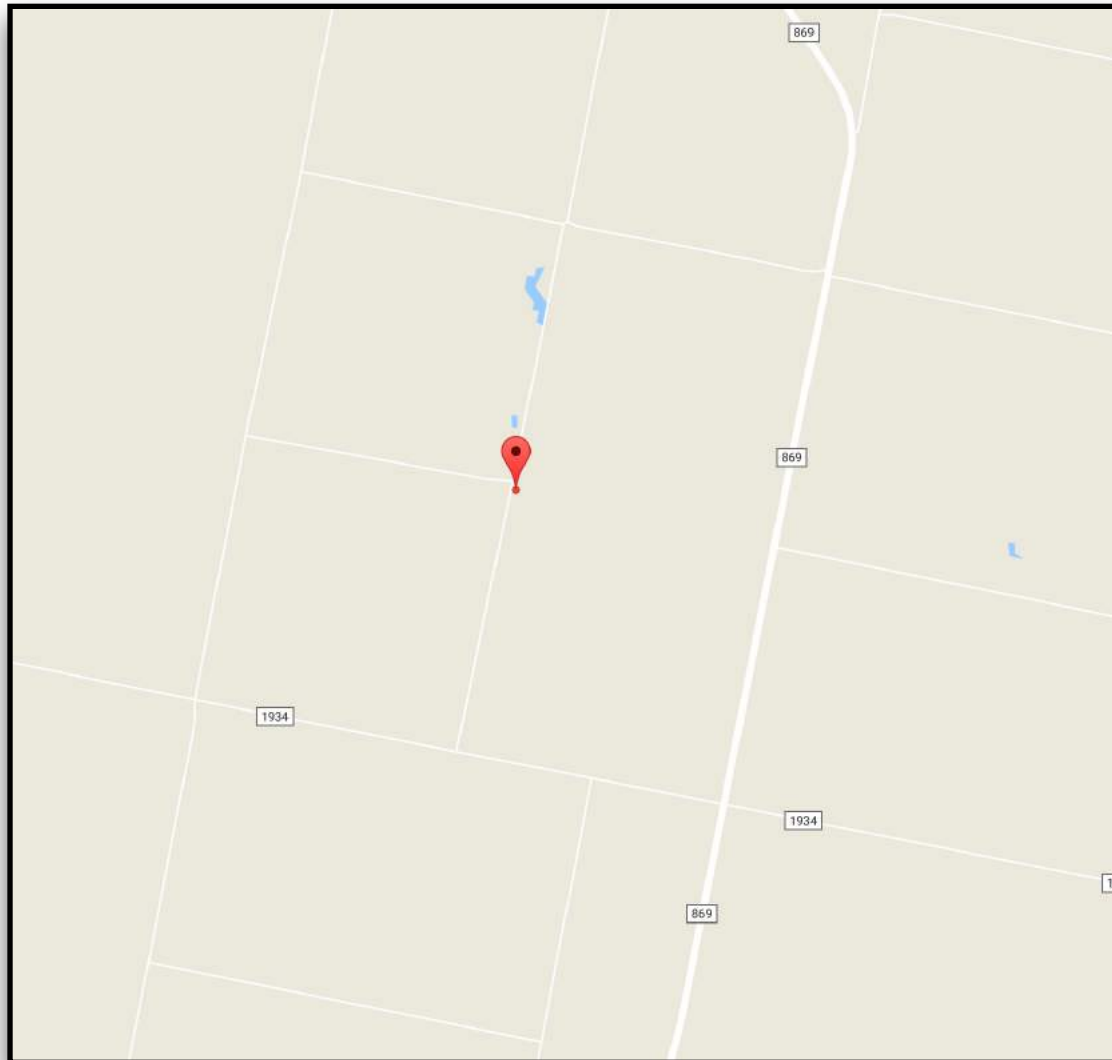

**Click for Property Map**

**Texas law requires all real estate licensees to give the following information about brokerage services to prospective buyers, tenants, sellers, & landlords.**

**Information About Brokerage Services**

**DISCLAIMER – This property offering is subject to prior sale, change in price, or removal from market without notice.**

**While the information provided is deemed reliable, it is not guaranteed by Caleb Matott or CM Ranch Real Estate.**

Presented By:  
**Caleb Matott, Broker/Owner**  
432-349-3330  
[BigDogRanchSales@mac.com](mailto:BigDogRanchSales@mac.com)

**CM Ranch Real Estate**

6800 W. County Rd. 48 | Midland, TX 79707 | 432-219-2220 | [RanchSpecialist@CMRanchRealEstate.com](mailto:RanchSpecialist@CMRanchRealEstate.com)

[www.CMRanchRealEstate.com](http://www.CMRanchRealEstate.com)