

INSPECTION TO BE
PRINTED OR TYPED

STATE OF WEST VIRGINIA

Buckhannon Co. HEALTH DEPARTMENT

Permit No.: ST-36-07-603

Tax Map: Parcel #:

County Road:

County: Buckhannon-36
ON-SITE SEWAGE DISPOSAL SYSTEM
INSPECTION FORM

Name of Owner: Frederick W. Trante Installer: Larry Scott
 Address: 112 Pine St. - Wincennes, DE 19934
 Property Location: Sumner Hill Rd, Buckhannon, Lot #2
 Type of Facility: New Res. Facility is: New () Existing () Lot Size: 6.87 Sq. Ft./Acre
 Design Loading in gpd/No. Bedrooms: 3 Bedrooms Source of Water Supply: Ring Well

SEWAGE TANK COMPONENT

Capacity in Gallons: 1,000 Material: Concrete Manufacturer: Tolson
 Distances (in feet) of Tank to: Dwelling: 110' Private ()/Public () Water Source: 50' Property Line: 25'

ON-SITE DISPOSAL SYSTEM

Class I Systems: Standard Soil Absorption Trenches () or Bed () Gravelless Pipe (), Diameter: _____ Inches
 Chamber Soil Absorption Trenches () or Bed ()
 Class II Systems: Pumped/Dosed Soil Absorption Trenches () or Bed () Evapotranspiration Trenches () or Bed ()
 Shallow Soil Absorption Trenches () or Bed () Other: _____

No. of Lines: 3 Length (in feet) of Each: 80', 90', 80', _____, _____, _____
 Width of Trenches: 3' inches/feet Depth to Bottom of Field: 24 3/4" inches
 If Bed, Dimensions (in Feet): _____ If Chamber System, Name: unilithabs, No. of Units: 60
 Approved and Adequate Materials Used? Yes () No () Size Equates to: 1,400 Square Feet of Standard Gravel Field
 Distances (in feet) of System to: Dwelling: 73' Private ()/Public () Water Source: 100' Property Line: 25'
 Remarks: Inspection occurred right after a rain storm, area was muddy and wet.

An inspection indicates that the sewage disposal system described above
DOES MEET (X),
DOES NOT MEET (),
CANNOT BE DETERMINED TO MEET () the minimum standards established by the West Virginia Bureau of Public Health.

To correct a health hazard, modifications to existing systems may be done to improve part of a system. Such modifications may not be able to be designated as a does meet system since inadequate information is known.

Although many factors contribute to the successful functioning of a sewage disposal system, this office recommends water conservation and maintaining an even usage of water throughout the week.

Sketch of Installation with Triangulation or Distance to Specific Landmarks:

Draw Arrow
toward North

* See attached
Sketch *

Visit Date(s): _____

Final Inspection Date: 9-12-08Sanitarian: Kami M. Kasper

Fredrick W. Traute
ST-36-09-005

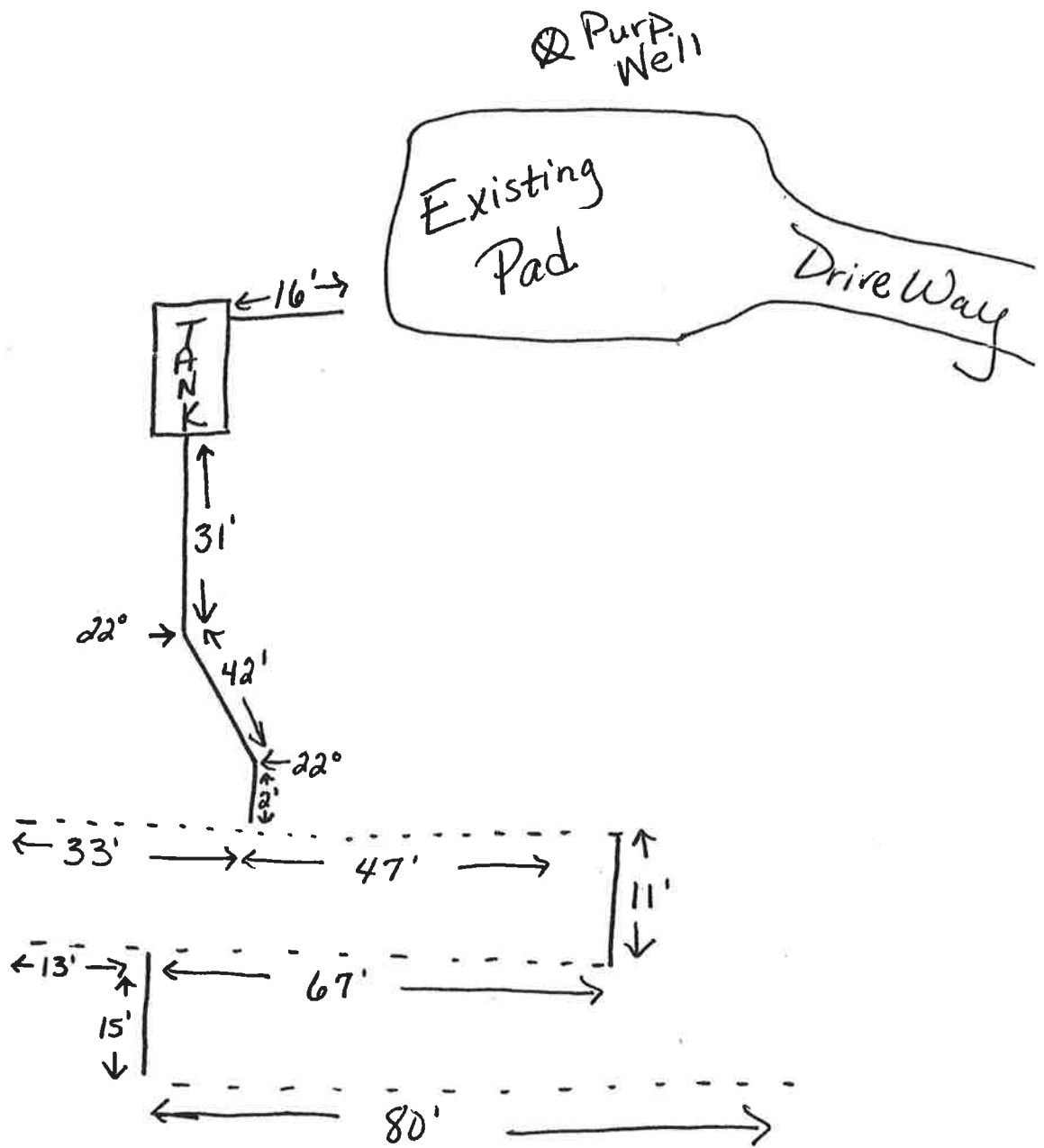

RESERVE AREA

Wildlife Haven
Lot #2

R091219A
38°49'06.021"N
79°17'48.678"W