

Soils Map

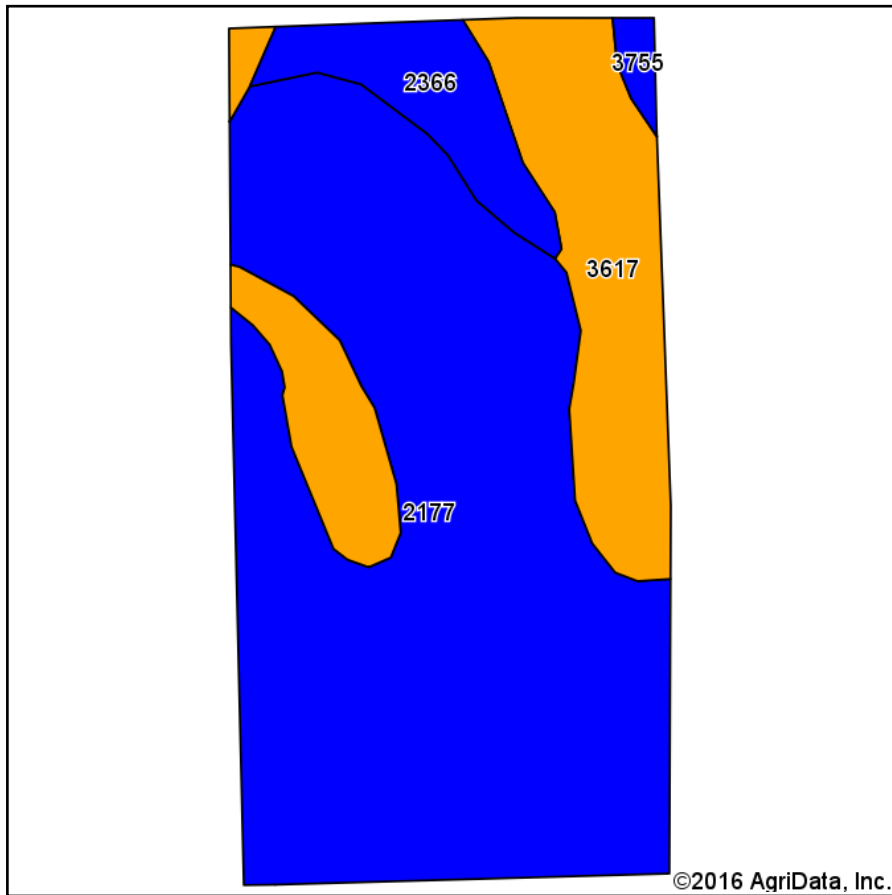

Soils data provided by USDA and NRCS.

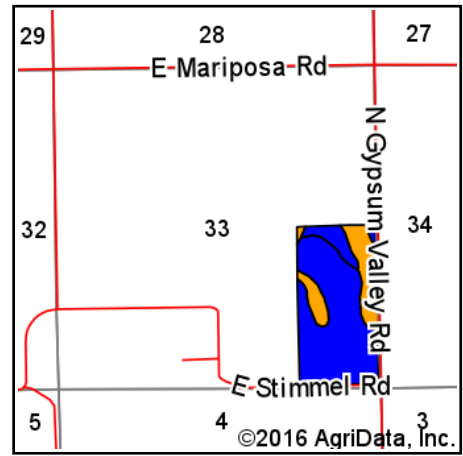

State: **Kansas**
 County: **Saline**
 Location: **33-13S-1W**
 Township: **Dayton**
 Acres: **79**
 Date: **7/16/2016**



ANTRIM-PIPER
WENGER REALTORS®

Maps Provided By:



© AgriData, Inc. 2016

www.AgriDataInc.com



Area Symbol: KS169, Soil Area Version: 12

Code	Soil Description	Acres	Percent of field	Non-Irr Class Legend	Non-Irr Class *c	Irr Class *c	Grain sorghum	Winter wheat
2177	McCook silt loam, occasionally flooded	54.98	69.6%		IIw		61	39
3617	Solomon silty clay, occasionally flooded	17.82	22.6%		IIIw		40	20
2366	New Cambria silty clay, rarely flooded	5.48	6.9%		IIs	IIs		
3755	Hord silt loam, rarely flooded	0.72	0.9%		IIc	I		
Weighted Average							51.5	31.7

Area Symbol: KS169, Soil Area Version: 12

*c: Using Capabilities Class Dominant Condition Aggregation Method

Soils data provided by USDA and NRCS.