

# Soils Map

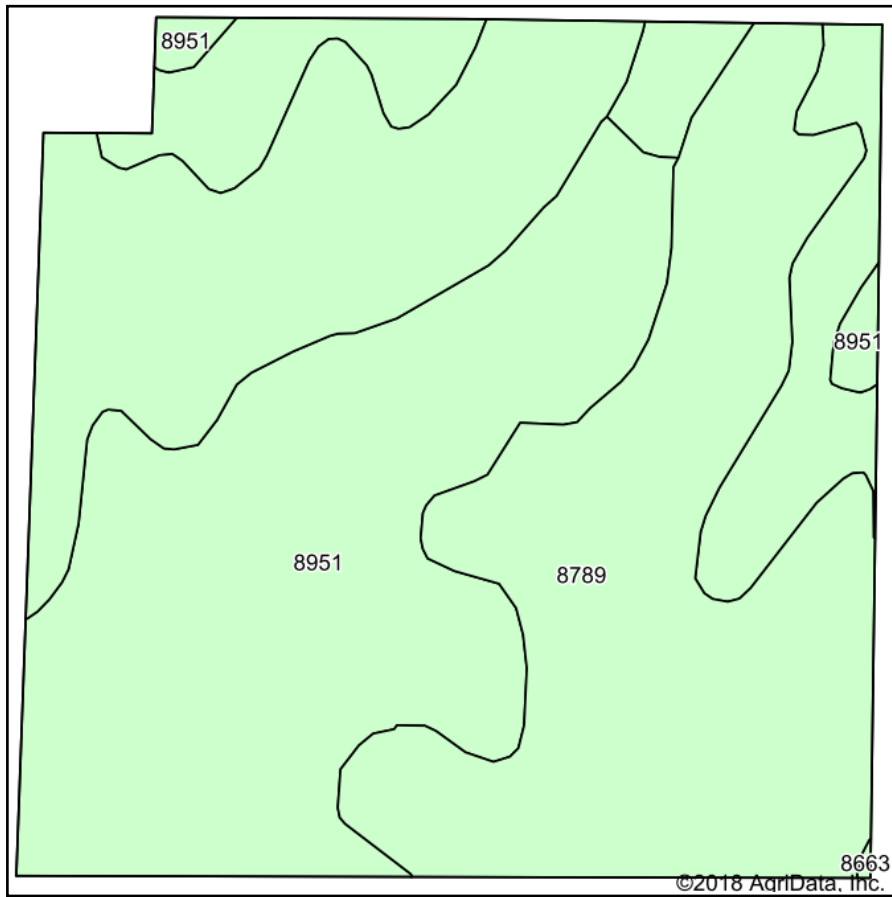

Soils data provided by USDA and NRCS.

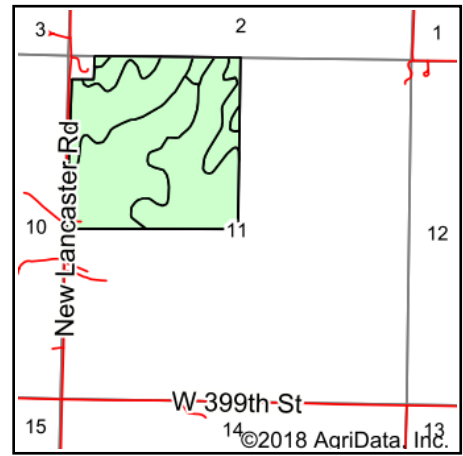

State: **Kansas**  
 County: **Miami**  
 Location: **11-19S-24E**  
 Township: **Miami**  
 Acres: **157.26**  
 Date: **12/5/2018**



Maps Provided By:



## Area Symbol: KS121, Soil Area Version: 19

Cod e	Soil Description	Acres	Percent of field	Non-Irr Class *c	Range Production (lbs/acre/yr)	*n NCCPI Soybeans
8789	Lebo channery silty clay loam, 15 to 30 percent slopes	82.22	52.3%	Vle	4755	18
8951	Wagstaff silty clay loam, 1 to 3 percent slopes	56.38	35.9%	Ille	4968	34
8663	Clareson-Rock outcrop complex, 3 to 15 percent slopes	18.66	11.9%	Vle	3398	11
<b>Weighted Average</b>					<b>4670.3</b>	<b>*n 22.9</b>

\*n: The aggregation method is "Weighted Average using major components"

\*c: Using Capabilities Class Dominant Condition Aggregation Method

Soils data provided by USDA and NRCS.