

Tillable Soils Map

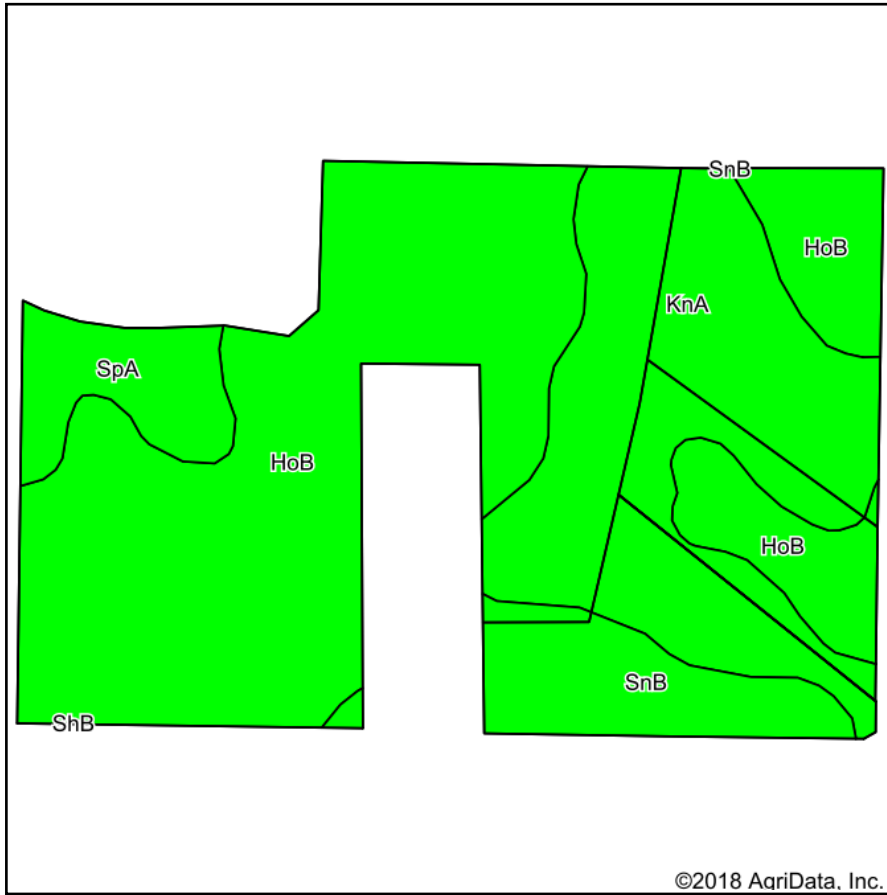

Soils data provided by USDA and NRCS.

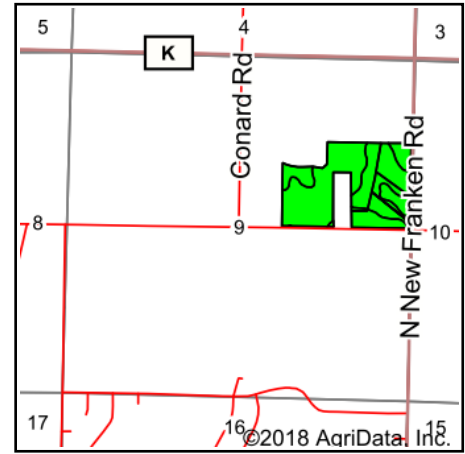

State: **Wisconsin**
 County: **Brown**
 Location: **9-24N-22E**
 Township: **Scott**
 Acres: **48.41**
 Date: **11/29/2018**

PC PEOPLES™
COMPANY
 INNOVATIVE. REAL ESTATE. SOLUTIONS.

Maps Provided By:

surety®
 CUSTOMIZED ONLINE MAPPING
 © AgriData, Inc. 2018 www.AgriDataInc.com



Area Symbol: WI009, Soil Area Version: 12

Code	Soil Description	Acres	Percent of field	Non-Irr Class Legend	Non-Irr Class *c
HoB	Hochheim loam, 2 to 6 percent slopes	26.02	53.7%		Ile
KnA	Kibbie silt loam, 1 to 3 percent slopes	15.17	31.3%		Ilw
SnB	Sisson silt loam, 2 to 6 percent slopes	4.20	8.7%		Ile
SpA	Solona loam, 1 to 3 percent slopes	3.02	6.2%		Ilw

*c: Using Capabilities Class Dominant Condition Aggregation Method

Soils data provided by USDA and NRCS.