

FOR SALE: Quality Farmland or Potential Building Site – Can Be Divided

Price Reduced

28.5[±] Acres
Asking \$233,700 or \$8,200/Acre

General Information:

Total Acres:	28.5 [±] Acres
County:	Tippecanoe
Township:	Sheffield
Location:	E SR 38 Lafayette, IN 47905
Schools:	TSC-McCutcheon
RE Taxes:	\$772.74
HLS #:	SFC-12251
Zoning:	A-Agricultural
BAC:	Co-Broker Available

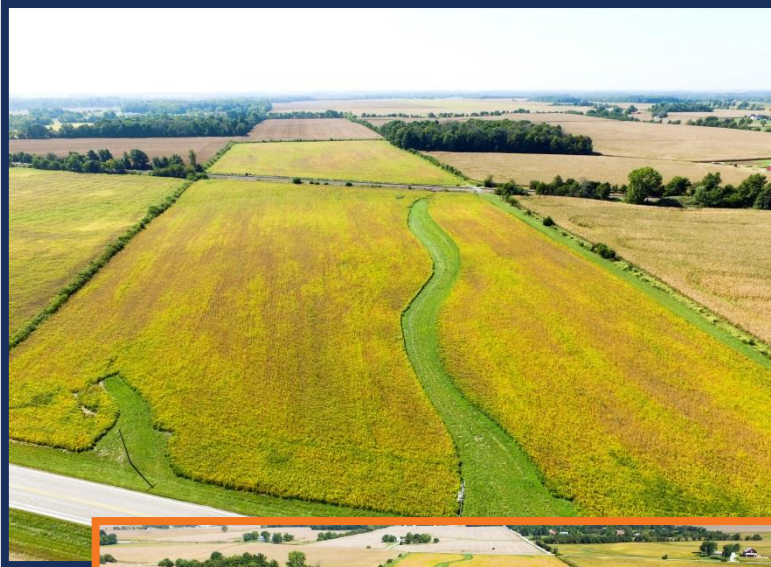

Property Details & Features:

- Income Producing Farm
 - 26.2[±] Acres Tillable
 - 0.8[±] Acres Waterways
- Well Drained with Significant Tile Ditching Investment
- 720' of Frontage Along State Road 38
- Fantastic Location with Easy Access to Lafayette
- Sought After Potential Rural Building Site
- Enjoy Privacy and Room for Recreation while still being close to Everything
- Build Your Dream Home, Mini Farm, or Country Estate
- Can Purchase Just Potentially Part of Farm if Desired

Contact Me for More Info

Sam Clark: 317-442-0251 or samc@halderman.com

Visit www.halderman.com for More Photos

AGENCY & DISCLAIMER: Halderman Real Estate Services, Inc. (HRES) and Halderman-Harmeyer Real Estate Services LLC (HHRES) and their representatives are exclusive agents of the Sellers. All information herein and in related materials is deemed to be accurate to the best available knowledge, but cannot be warranted or guaranteed.

All information is subject to verification by parties relying upon it, and no liability for its accuracy, errors, or omissions is assumed by the Sellers or HRES or HHRES.

Maps:

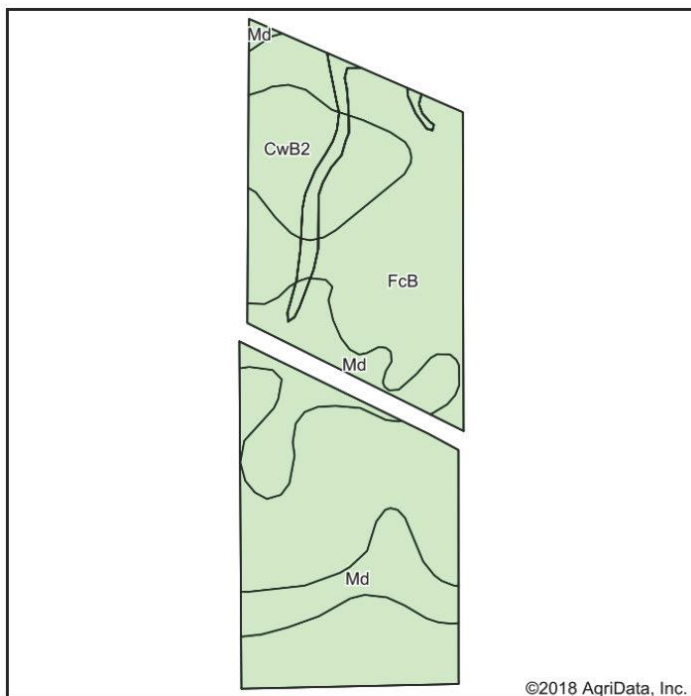
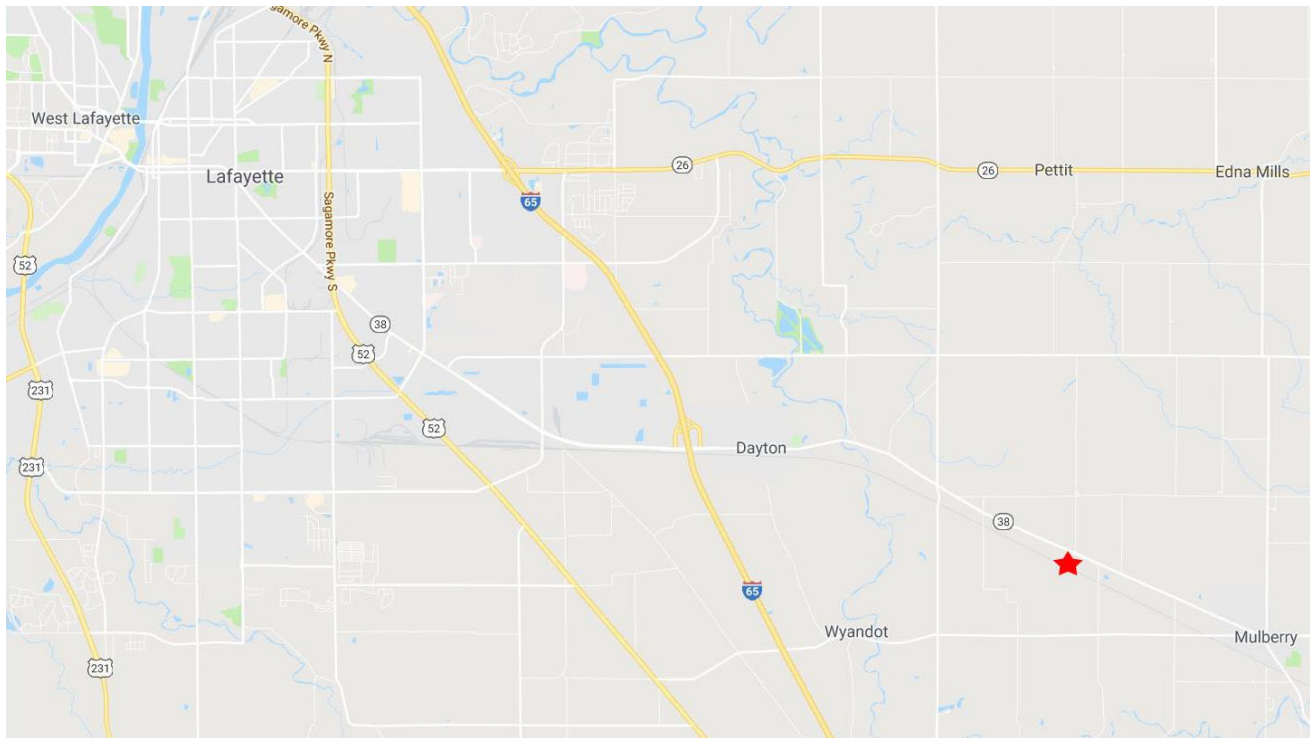

Soils data provided by USDA and NRCS.

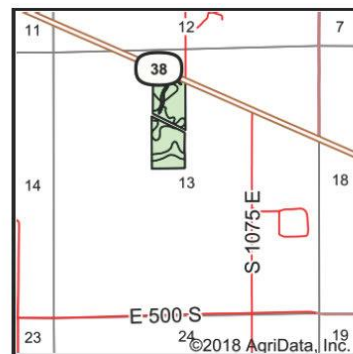

State: **Indiana**
 County: **Tippecanoe**
 Location: **13-22N-3W**
 Township: **Sheffield**
 Acres: **27.02**
 Date: **9/18/2018**

HALDERMAN
 REAL ESTATE & FARM MANAGEMENT

Maps Provided By:
surety
 CUSTOMIZED ONLINE MAPPING
 © AgriData, Inc. 2018 www.AgriDataInc.com



Area Symbol: IN157, Soil Area Version: 19							
Code	Soil Description	Acres	Percent of field	Non-Irr Class	Winter wheat	Soybeans	Corn
FcB	Fincastle-Crosby complex, 1 to 3 percent slopes	17.96	66.5%	Ile	68	49	151
Md	Mahalasville-Treaty complex	5.56	20.6%	IIW	74	53	185
CwB2	Crosby-Miami silt loams, 2 to 4 percent slopes, eroded	3.50	13.0%	Ile	62	46	138
Weighted Average					68.5	49.4	156.3

AGENCY & DISCLAIMER: Halderman Real Estate Services, Inc. (HRES) and Halderman-Harmeyer Real Estate Services LLC (HHRES) and their representatives are exclusive agents of the Sellers. All information herein and in related materials is deemed to be accurate to the best available knowledge, but cannot be warranted or guaranteed. All information is subject to verification by parties relying upon it, and no liability for its accuracy, errors, or omissions is assumed by the Sellers or HRES or HHRES.