

Soils Map

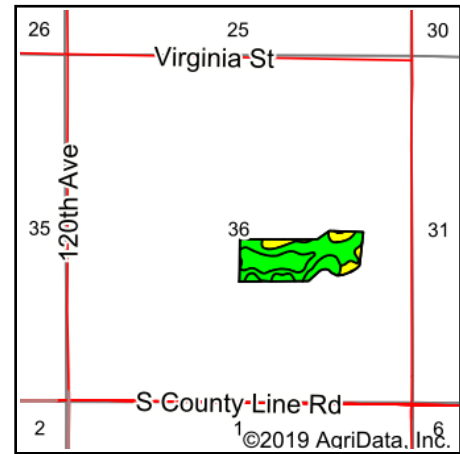
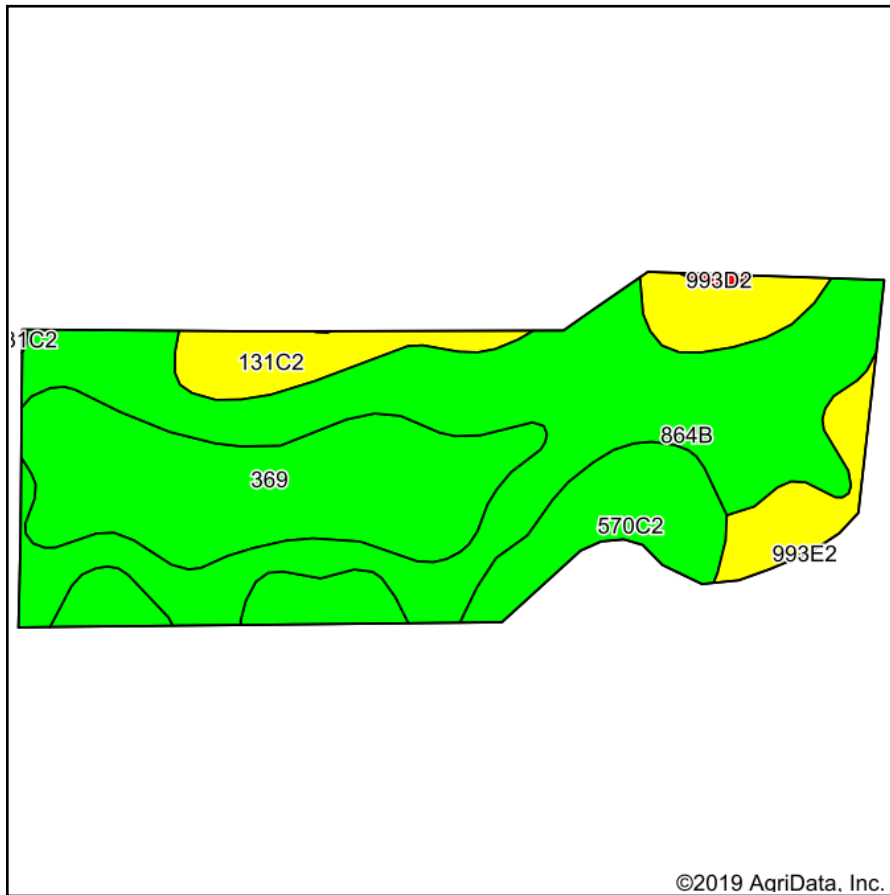

State: **Iowa**
 County: **Warren**
 Location: **36-74N-24W**
 Township: **Squaw**
 Acres: **27.21**
 Date: **4/30/2019**

PEOPLES™
 COMPANY
 INNOVATIVE. REAL ESTATE. SOLUTIONS.

Maps Provided By:

surety®
 CUSTOMIZED ONLINE MAPPING
 © AgriData, Inc. 2019 www.AgriDataInc.com



Area Symbol: IA181, Soil Area Version: 23

Code	Soil Description	Acres	Percent of field	CSR2 Legend	Non-Irr Class *c	*i Corn	*i Soybeans	CSR2**	CSR	*n NCCPI Overall	*n NCCPI Corn	*n NCCPI Soybeans
864B	Grundy silty clay loam, 2 to 5 percent slopes	12.48	45.9%		IIe	80	23.2	72	82	78	78	70
369	Winterset silty clay loam, 0 to 2 percent slopes	6.72	24.7%		IIw	217.6	63.1	84	83	80	80	68
131C2	Pershing silt loam, 5 to 9 percent slopes, moderately eroded	4.10	15.1%		IIIe	80	23.2	62	50	60	60	49
570C2	Nira silty clay loam, 5 to 9 percent slopes, moderately eroded	3.85	14.1%		IIIe	187.2	54.3	73	64	77	77	68
993D2	Armstrong-Gara loams, 9 to 14 percent slopes, moderately eroded	0.06	0.2%		IVe	131.2	38	23	20	62	62	46
Weighted Average						129.3	37.5	73.5	74.7	*n 75.6	*n 75.6	*n 66

**IA has updated the CSR values for each county to CSR2.

*i Yield data provided by the ISPAID Database version 8.1.1 developed by IA State University.

*n: The aggregation method is "Weighted Average using major components"

*c: Using Capabilities Class Dominant Condition Aggregation Method

Soils data provided by USDA and NRCS.