

Land Sale ID: 15588
 Property/Compartment: RW/2721
 RMS District: Lumberton
 Lease: Fee
 Owner: SWT
 State/County: NC/Richmond
 Acres: 15.74

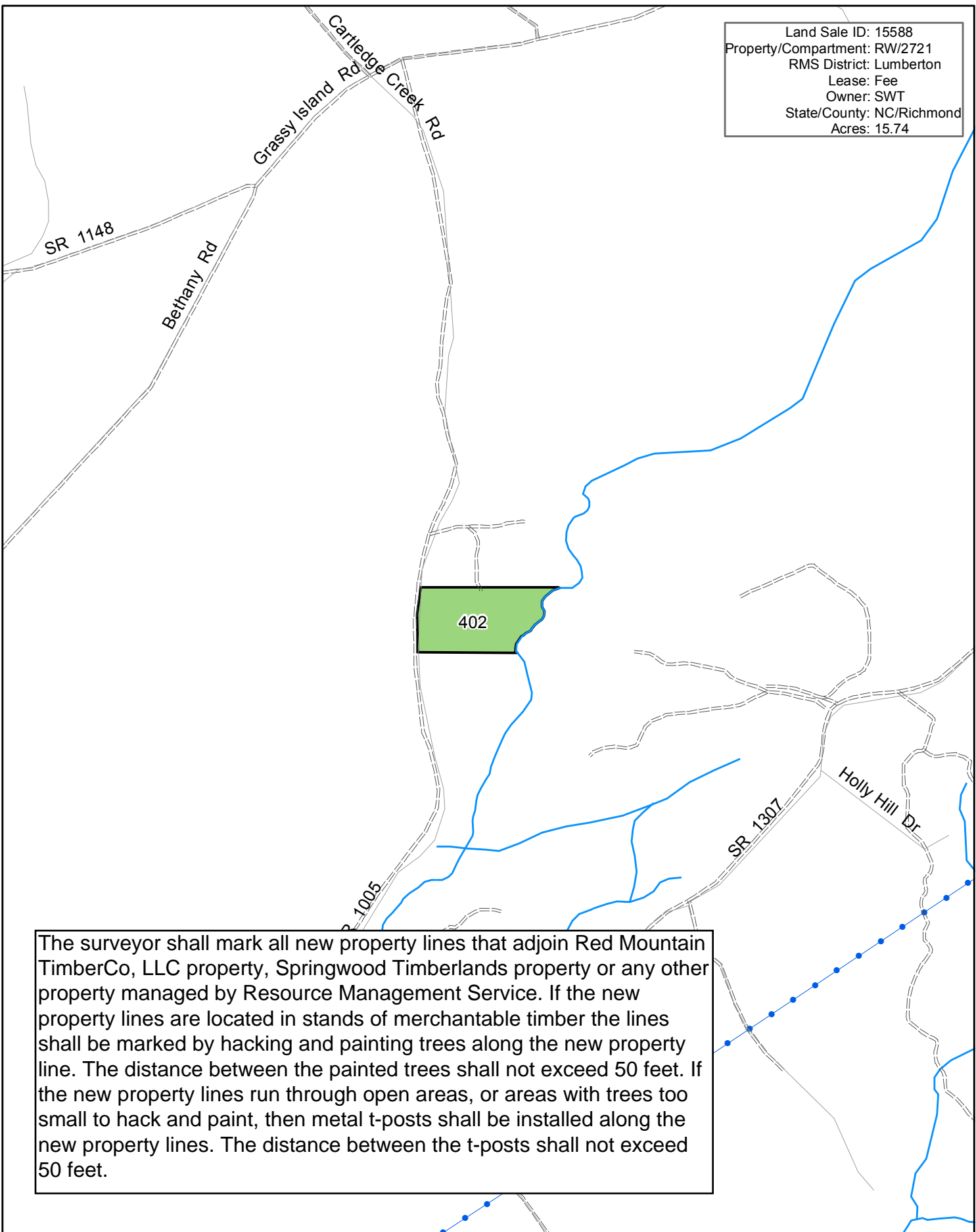

The surveyor shall mark all new property lines that adjoin Red Mountain TimberCo, LLC property, Springwood Timberlands property or any other property managed by Resource Management Service. If the new property lines are located in stands of merchantable timber the lines shall be marked by hacking and painting trees along the new property line. The distance between the painted trees shall not exceed 50 feet. If the new property lines run through open areas, or areas with trees too small to hack and paint, then metal t-posts shall be installed along the new property lines. The distance between the t-posts shall not exceed 50 feet.

- | | |
|--|--|
| 15 Merchantable Pine | Food Plot / Open Field |
| Premerchantable Pine | Reserved Timber |
| Hardwood Land | Water |
| Cleared | Non-Forest |
- Above numbers represent Acres

1:15,840
 1 inch equals 0.25 miles
 Date Created: 3/1/2019

RMS

Resource Management Service, LLC

This map is not warranted for completeness or accuracy