

# Soils Map

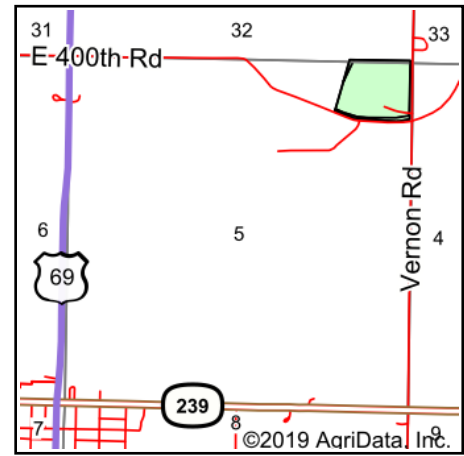

State: **Kansas**  
 County: **Linn**  
 Location: **5-23S-25E**  
 Township: **Sheridan**  
 Acres: **21.93**  
 Date: **5/6/2019**

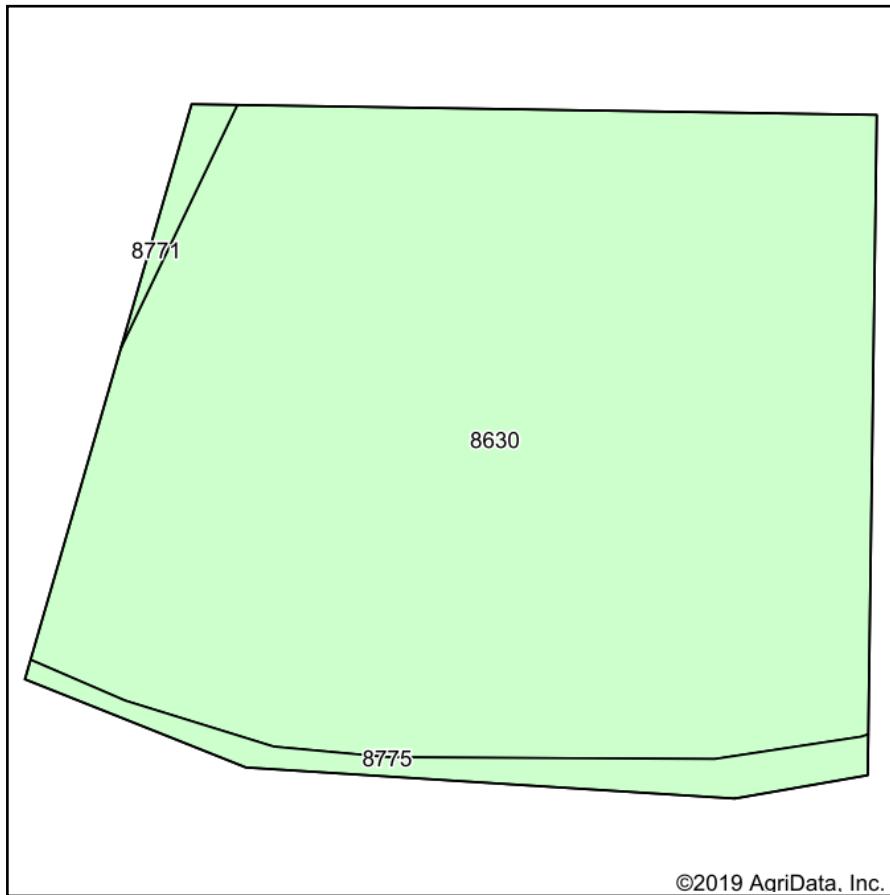

Maps Provided By:  
**surety**  
 CUSTOMIZED ONLINE MAPPING  
 © AgriData, Inc. 2019 www.AgriDataInc.com



## Area Symbol: KS107, Soil Area Version: 18

Cod e	Soil Description	Acres	Percent of field	Non-Irr Class *c	Range Production (lbs/acre/yr)	Grain sorghum	Winter wheat	*n NCCPI Soybeans
8630	Brazilton silty clay loam, 1 to 3 percent slopes	20.67	94.3%	IIIIs	0	60	26	51
8775	Kenoma silt loam, 1 to 3 percent slopes	1.02	4.7%	IIIe	3888			58
8771	Kanima silty clay loam, 15 to 50 percent slopes	0.24	1.1%	VIIIs	0			16
<b>Weighted Average</b>					<b>180.8</b>	<b>56.6</b>	<b>24.5</b>	<b>*n 50.9</b>

\*n: The aggregation method is "Weighted Average using major components"

\*c: Using Capabilities Class Dominant Condition Aggregation Method

Soils data provided by USDA and NRCS.