

PRICE REDUCED

See more information at www.hciutah.com

Northwest Grantsville 93 Acres

93.64 acres in Grantsville City, Tooele County, Utah

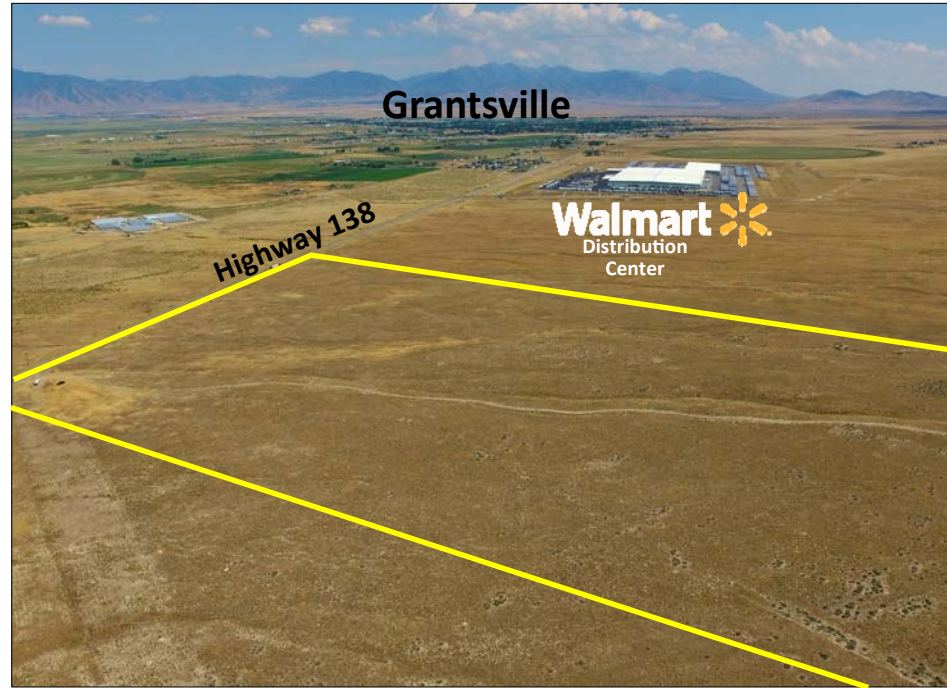
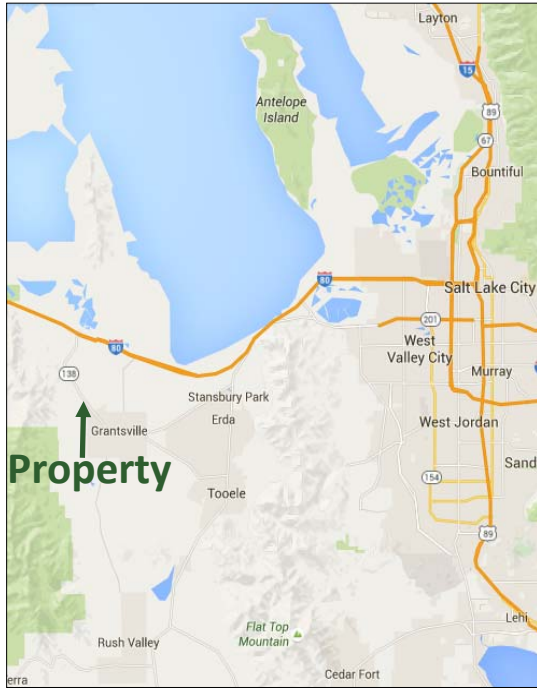

EXECUTIVE SUMMARY:

List Price: \$845,750, \$9,032/Acre

Mike Nelson | Dan Nelson

801-482-7565 | mike@hciutah.com

Notice: This information is believed to be accurate, but no warranty is expressed or implied. Highland Commercial insists that interested parties conduct their own research and investigations. The property is offered subject to prior sale, price change, and withdrawal without notice. No obligations will be created unless a purchase contract is signed by both buyer and seller. We welcome the cooperation of participating brokers; please contact us for our commission-sharing policies. All images and materials are copyright protected and are the property of Highland Commercial.

- 93.64 acres in Grantsville City, Tooele County, Utah
- 2017 Taxes: \$29.08 (Greenbelt)
- Zoned A-10 (10-acre lot size) in Grantsville City
- Access and exposure along Highway 138 less than 1/2-mile northwest of the Walmart Distribution Center
- 1 mile from Bonneville Seabase
- 5 miles from I-80
- 12 miles from Tooele City, Utah
- 11 miles from Stansbury Park, Utah
- 35 miles from Salt Lake City, Utah



2733 East Parley's Way, Suite 304

Salt Lake City, UT 84109

801-487-6100

www.hciutah.com

