

Soils Map

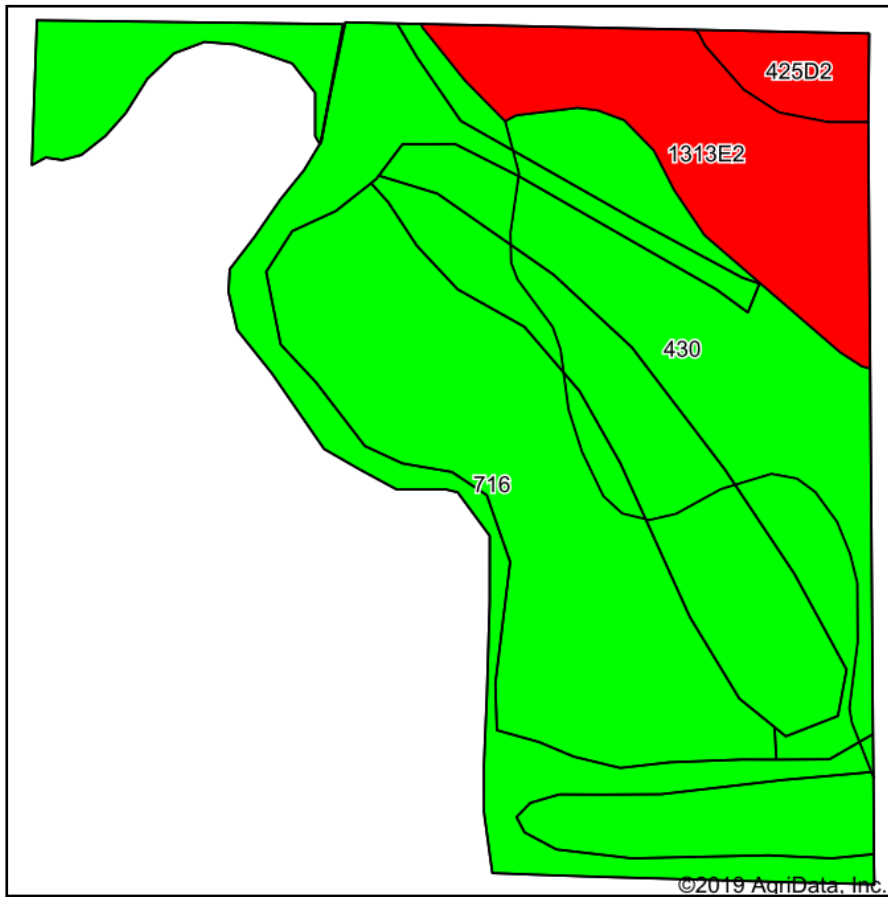

Soils data provided by USDA and NRCS.

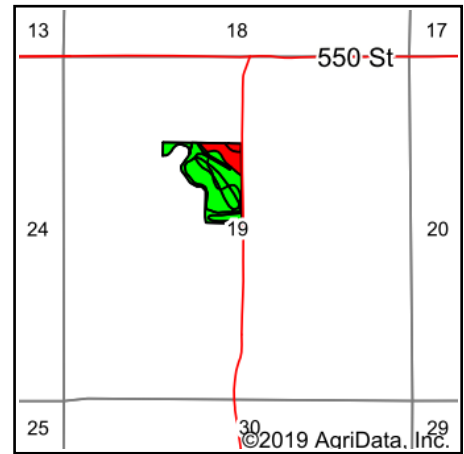

State: **Iowa**
 County: **Lucas**
 Location: **19-73N-21W**
 Township: **English**
 Acres: **20.7**
 Date: **6/12/2019**

PC PEOPLES
 COMPANY
 INNOVATIVE. REAL ESTATE. SOLUTIONS.

Maps Provided By:

surety
 CUSTOMIZED ONLINE MAPPING
 © AgriData, Inc. 2019 www.AgriDataInc.com



Area Symbol: IA117. Soil Area Version: 26

| Code | Soil Description | Acres | Percent of field | CSR2 Legend | Non-Irr Class *c | CSR2** | CSR | *n NCCPI Overall | *n NCCPI Soybeans |
|-------------------------|--|-------|------------------|-------------|------------------|-------------|-----------|------------------|-------------------|
| 716 | Lawson-Quiver-Nodaway complex, 0 to 2 percent slopes, occasionally flooded | 12.85 | 62.1% | | IIw | 78 | | 87 | 85 |
| 430 | Ackmore silt loam, heavy till, 0 to 2 percent slopes, occasionally flooded | 4.48 | 21.6% | | IIw | 77 | 83 | 86 | 79 |
| 1313E2 | Munterville silty clay loam, 14 to 18 percent slopes, moderately eroded | 2.81 | 13.6% | | VIe | 22 | 5 | 45 | 36 |
| 425D2 | Keswick clay loam, 9 to 14 percent slopes, moderately eroded | 0.56 | 2.7% | | IVe | 8 | 12 | 43 | 35 |
| Weighted Average | | | | | | 68.3 | *- | *n 79.9 | *n 75.7 |

**IA has updated the CSR values for each county to CSR2.

*- CSR weighted average cannot be calculated on the current soils data, use prior data version for csr values.

*n: The aggregation method is "Weighted Average using major components"

*c: Using Capabilities Class Dominant Condition Aggregation Method

Soils data provided by USDA and NRCS.