

Soils Map

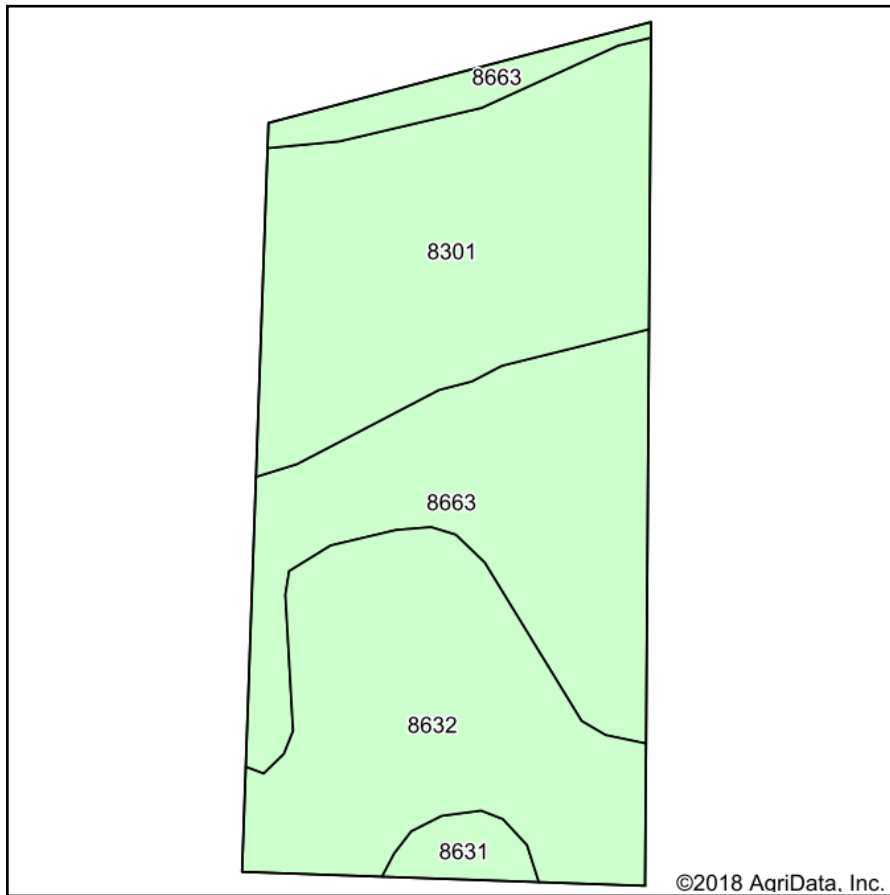

Soils data provided by USDA and NRCS.

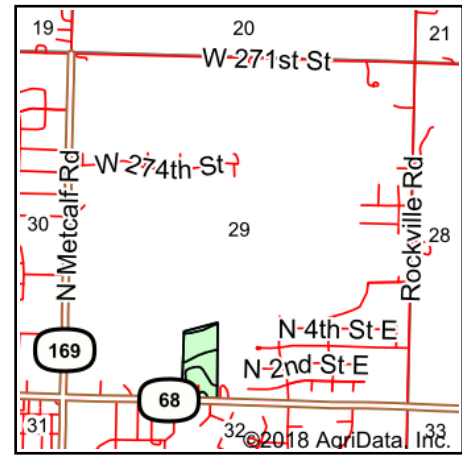

State: **Kansas**
 County: **Miami**
 Location: **29-16S-25E**
 Township: **Wea**
 Acres: **13.23**
 Date: **7/23/2018**



Maps Provided By:



Area Symbol: KS121, Soil Area Version: 18

Code	Soil Description	Acres	Percent of field	Non-Irr Class *c	Range Production (lbs/acre/yr)
8301	Verdigris silt loam, 0 to 1 percent slopes, frequently flooded	4.67	35.3%	Vw	8048
8663	Clareon-Rock outcrop complex, 3 to 15 percent slopes	4.23	32.0%	Vle	3398
8632	Bucyrus silty clay loam, 3 to 8 percent slopes	4.00	30.2%	IIle	6248
8631	Bucyrus silty clay loam, 1 to 3 percent slopes	0.33	2.5%	Ile	6108
Weighted Average					5968.7

*c: Using Capabilities Class Dominant Condition Aggregation Method

Soils data provided by USDA and NRCS.