

Soils Map

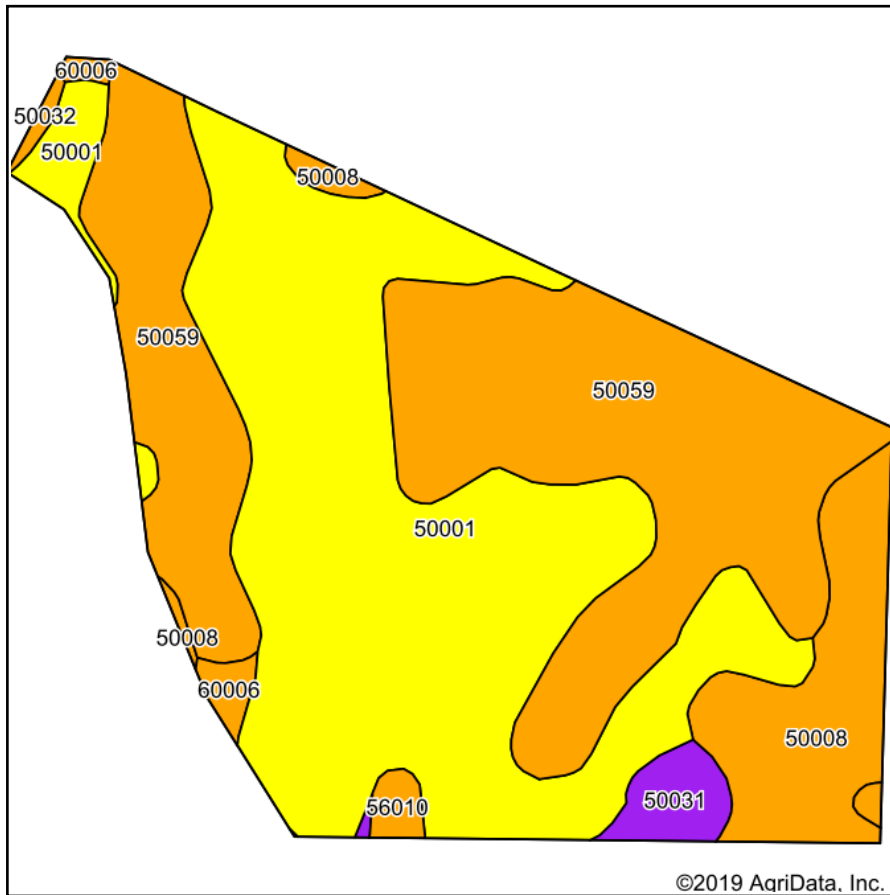

Soils data provided by USDA and NRCS.

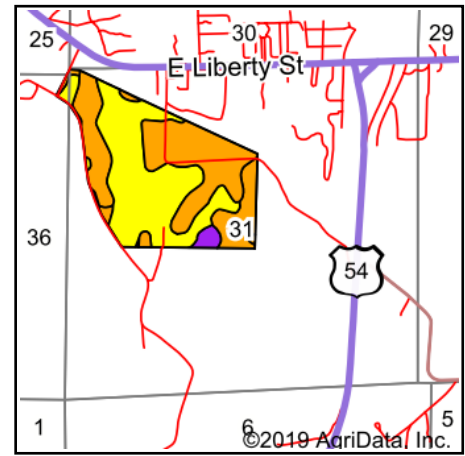

State: **Missouri**
 County: **Audrain**
 Location: **31-51N-8W**
 Township: **South Fork**
 Acres: **141.62**
 Date: **4/16/2019**



Maps Provided By:



© AgriData, Inc. 2019

www.AgriDataInc.com



Area Symbol: MO007, Soil Area Version: 21

Code	Soil Description	Acres	Percent of field	Non-Irr Class Legend	Non-Irr Class *c	Cor n	Common bermudagrass	Caucasian bluestem	Warm season grasses	Alfalfa hay	Orchardgrass red clover	Tall fescue	Oats	Soybeans	Winter wheat	Grain sorghum	*n S
50001	Armstrong loam, 5 to 9 percent slopes, eroded	66.99	47.3%		IVe												
50059	Mexico silt loam, 1 to 4 percent slopes, eroded	54.58	38.5%		IIle												
50008	Keswick silt loam, 5 to 9 percent slopes, eroded	14.24	10.1%		IIle												
50031	Lenzburg clay loam, 5 to 50 percent slopes	2.89	2.0%		Vlle												
60006	Marion silt loam, 2 to 5 percent slopes	1.35	1.0%		IIle	5	8	2	10		7	8	3	2	2	4	
56010	Belknap silt loam, 0 to 2 percent slopes, frequently flooded	1.03	0.7%		IIlw		8		10		9	8					

50032	Lenzburg silty clay loam, 1 to 5 percent slopes	0.43	0.3%		IIIe		7	8	8	7	7	7				
50052	Winnegan silt loam, 14 to 30 percent slopes	0.11	0.1%		Vle		7	8	8	5	8	7				
Weighted Average						*-	0.2	*-	0.2	*-	0.2	0.2	*-	*-	*-	*-

*n: The aggregation method is "Weighted Average using major components"

*c: Using Capabilities Class Dominant Condition Aggregation Method

Soils data provided by USDA and NRCS.