

Soils Map

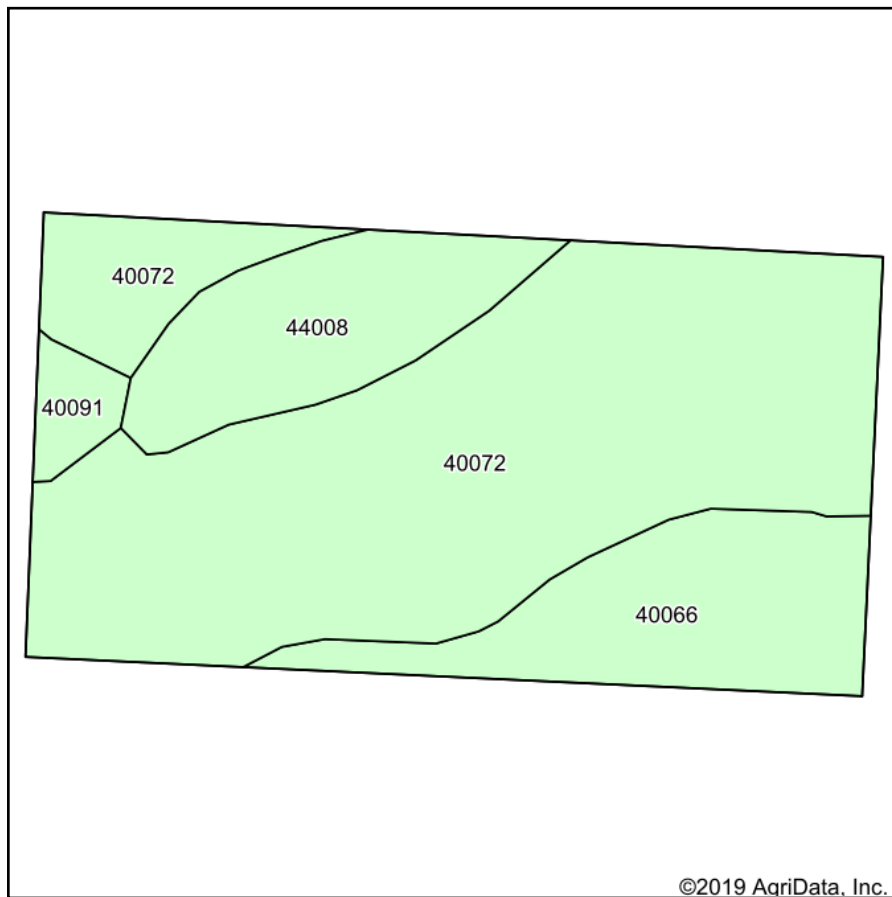

Soils data provided by USDA and NRCS.

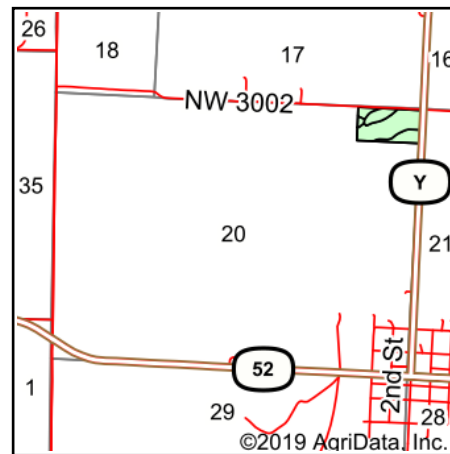

State: **Missouri**
 County: **Bates**
 Location: **20-40N-33W**
 Township: **Homer**
 Acres: **18.75**
 Date: **8/15/2019**



Maps Provided By:

 © AgriData, Inc. 2019 www.AgriDataInc.com



Area Symbol: MO013. Soil Area Version: 21

Code	Soil Description	Acres	Percent of field	Non-Irr Class *c	Range Production (lbs/acre/yr)	Common bermudagrass	Caucasian bluestem	Warm season grasses	Alfalfa hay	Orchardgrass red clover	Tall fescue	*n NCCPI Soybeans
40072	Kenoma silt loam, 1 to 3 percent slopes	12.45	66.4%	IIIe	3888							58
40066	Hartwell silt loam, 0 to 1 percent slopes	3.22	17.2%	IIw	0							63
44008	Okemah silt loam, 0 to 2 percent slopes	2.61	13.9%	Ile	0	7	8	8	5	8	7	69
40091	Summit silty clay loam, 2 to 5 percent slopes	0.47	2.5%	Ile	0							62
Weighted Average					2581.6	1	1.1	1.1	0.7	1.1	1	*n 60.5

*n: The aggregation method is "Weighted Average using major components"

*c: Using Capabilities Class Dominant Condition Aggregation Method

Soils data provided by USDA and NRCS.