



INFORMATION ABOUT ON-SITE SEWER FACILITY

USE OF THIS FORM BY PERSONS WHO ARE NOT MEMBERS OF THE TEXAS ASSOCIATION OF REALTORS®, INC. IS NOT AUTHORIZED.
©Texas Association of REALTORS®, Inc., 2004

CONCERNING THE PROPERTY AT

135 Grand View Ct.,
Blanco, TX 78606

A. DESCRIPTION OF ON-SITE SEWER FACILITY ON PROPERTY:

- (1) Type of Treatment System: Septic Tank Aerobic Treatment Unknown
- (2) Type of Distribution System: _____ Unknown
- (3) Approximate Location of Drain Field or Distribution System: _____ Unknown
- (4) Installer: Dennis Moore Unknown
- (5) Approximate Age: New Unknown

B. MAINTENANCE INFORMATION:

- (1) Is Seller aware of any maintenance contract in effect for the on-site sewer facility? Yes No
If yes, name of maintenance contractor: Block Creek
Phone: _____ contract expiration date: _____
Maintenance contracts must be in effect to operate aerobic treatment and certain non-standard on-site sewer facilities.)
- (2) Approximate date any tanks were last pumped? _____
- (3) Is Seller aware of any defect or malfunction in the on-site sewer facility? Yes No
If yes, explain: _____
- (4) Does Seller have manufacturer or warranty information available for review? Yes No

C. PLANNING MATERIALS, PERMITS, AND CONTRACTS:

- (1) The following items concerning the on-site sewer facility are attached:
 planning materials permit for original installation final inspection when OSSF was installed
 maintenance contract manufacturer information warranty information _____
- (2) "Planning materials" are the supporting materials that describe the on-site sewer facility that are submitted to the permitting authority in order to obtain a permit to install the on-site sewer facility.
- (3) It may be necessary for a buyer to have the permit to operate an on-site sewer facility transferred to the buyer.

(TXR-1407) 1-7-04

Initialed for Identification by Buyer _____ and Seller [Signature]

Page 1 of 2

Information about On-Site Sewer Facility concerning _____

D. INFORMATION FROM GOVERNMENTAL AGENCIES: Pamphlets describing on-site sewer facilities are available from the Texas Agricultural Extension Service. Information in the following table was obtained from Texas Commission on Environmental Quality (TCEQ) on 10/24/2002. The table estimates daily wastewater usage rates. Actual water usage data or other methods for calculating may be used if accurate and acceptable to TCEQ.

<u>Facility</u>	<u>Usage (gal/day) without water- saving devices</u>	<u>Usage (gal/day) with water- saving devices</u>
Single family dwelling (1-2 bedrooms; less than 1,500 sf)	225	180
Single family dwelling (3 bedrooms; less than 2,500 sf)	300	240
Single family dwelling (4 bedrooms; less than 3,500 sf)	375	300
Single family dwelling (5 bedrooms; less than 4,500 sf)	450	360
Single family dwelling (6 bedrooms; less than 5,500 sf)	525	420
Mobile home, condo, or townhouse (1-2 bedroom)	225	180
Mobile home, condo, or townhouse (each add'l bedroom)	75	60

This document is not a substitute for any inspections or warranties. This document was completed to the best of Seller's knowledge and belief on the date signed. Seller and real estate agents are not experts about on-site sewer facilities. Buyer is encouraged to have the on-site sewer facility inspected by an inspector of Buyer's choice.

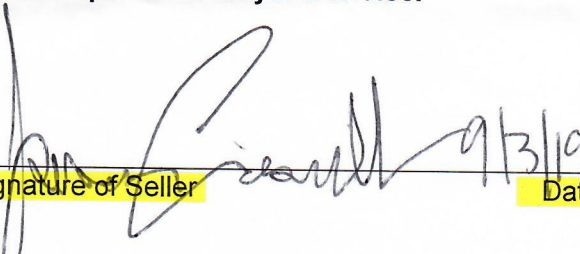

 Signature of Seller Date

 Signature of Seller Date

Receipt acknowledged by:

 Signature of Buyer Date

 Signature of Buyer Date



KERMIT A. ROEDER

BLANCO COUNTY INSPECTOR

PO BOX 471

JOHNSON CITY, TEXAS 78636

830-868-2117 OFFICE

EMAIL: INSPECTOR@CO.BLANCO.TX.US

LICENSE No,

Date of Approval

Date

19-098

8-21-2019

8-21-2019

ON-SITE SEWAGE FACILITY--LICENSE TO OPERATE

This license to operate an on-site sewage facility (OSSF) is issued to:

Owner's
Name

Jason Creswell

Mailing
Address

1374 Forest View Dr Blanco Tx 78606

"911"
Address (if
other than
mailing)

135 Grand View Ct

The above referenced OSSF has been inspected by Blanco County for compliance with the Blanco County Sewage Facility Regulations and, based on information provided by the applicant, has been found to comply with the requirements of those rules. This inspection certification does not extend to the materials, workmanship or fabrications of the facility so as to express or imply to the owner/operator or installer any warranty to or rights against Blanco County or any of its agents or agencies. This license may be revoked if there is evidence that the facility is not being properly maintained or is not operating properly and/or may constitute a threat to the health of the people of the State of Texas.

Signature of Blanco County OSSF Inspector

Date

KAR

8-21-19

SCHEMATIC OF LOT OR TRACT

Show: Compass North, adjacent streets, property lines, property dimensions, location of buildings, easements, swimming pools, water lines, and other structures where known.

Location of natural, constructed, or proposed drainage ways. Lot size: _____ acres

FEATURES OF SITE AREA

Presence of 100-year flood zone _____ Yes No
 Presence of adjacent ponds, streams, water impoundments _____ Yes No

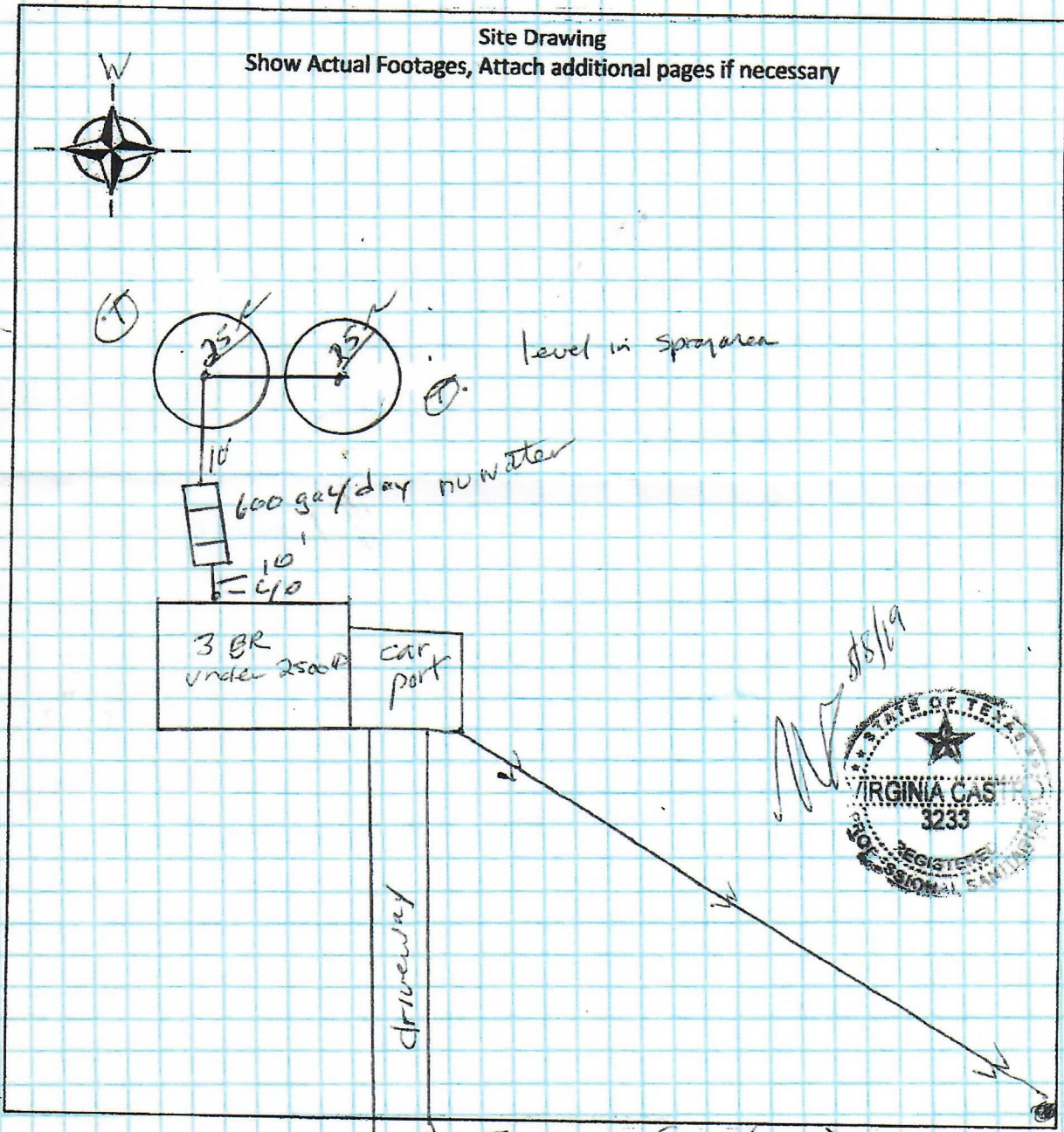

Name of Site Evaluator: Virginia Casto Signature: [Signature] 8/5/19

← Grandview Court →