

Soils Map

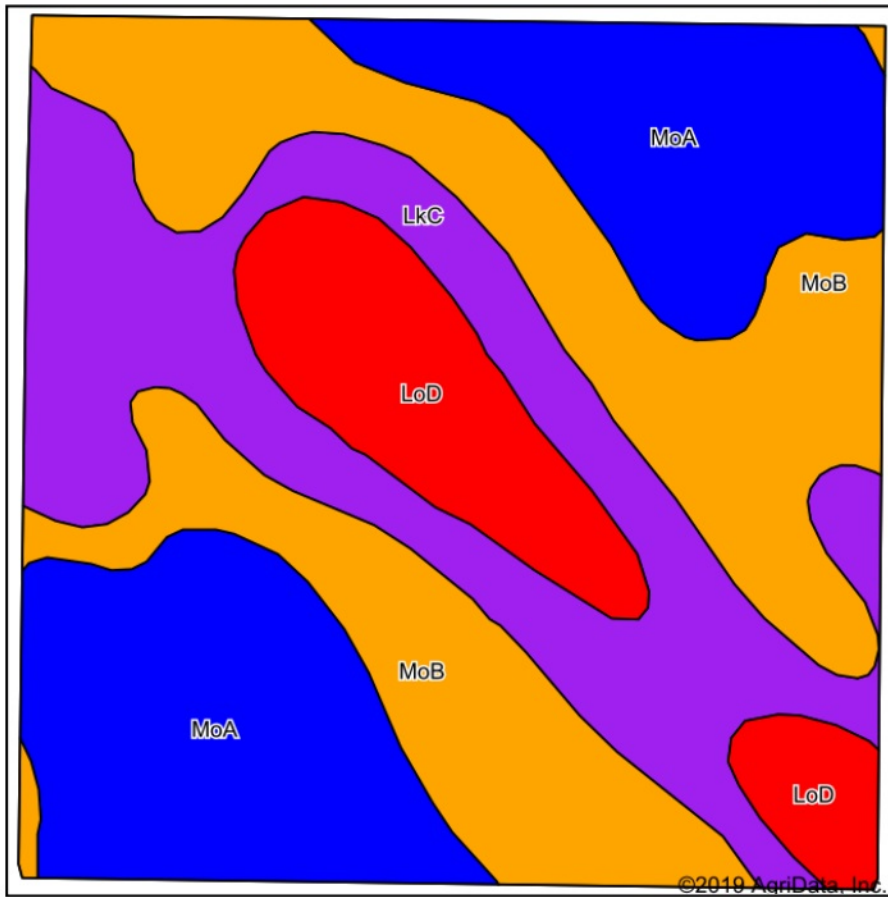

Soils data provided by USDA and NRCS.

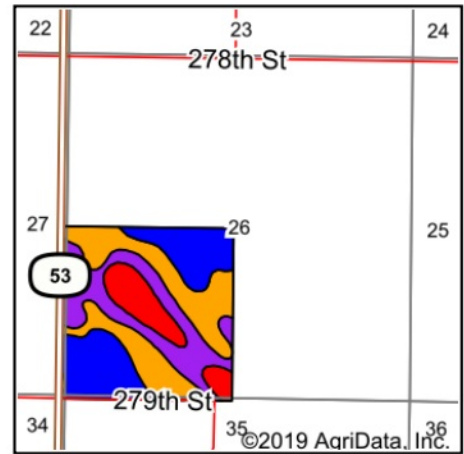

State: **South Dakota**
 County: **Tripp**
 Location: **26-99N-78W**
 Township: **Jordan**
 Acres: **160**
 Date: **10/7/2019**



Maps Provided By:



Area Symbol: SD123. Soil Area Version: 19

| Code | Soil Description | Acres | Percent of field | PI Legend | Non-Irr Class *c | Irr Class *c | Productivity Index |
|------------------|--|-------|------------------|-----------|------------------|--------------|--------------------|
| MoB | Millboro silty clay, 3 to 6 percent slopes | 52.62 | 32.9% | | IIIe | IIIe | 79 |
| MoA | Millboro silty clay, 0 to 3 percent slopes | 46.83 | 29.3% | | IIIs | IIIs | 86 |
| LkC | Lakoma-Millboro silty clays, 6 to 9 percent slopes | 40.77 | 25.5% | | IVe | IVe | 59 |
| LoD | Lakoma-Okaton silty clays, 6 to 15 percent slopes | 19.78 | 12.4% | | IVe | IVe | 33 |
| Weighted Average | | | | | | | 70.3 |

*c: Using Capabilities Class Dominant Condition Aggregation Method
 Soils data provided by USDA and NRCS.