

Tillable Soils Map

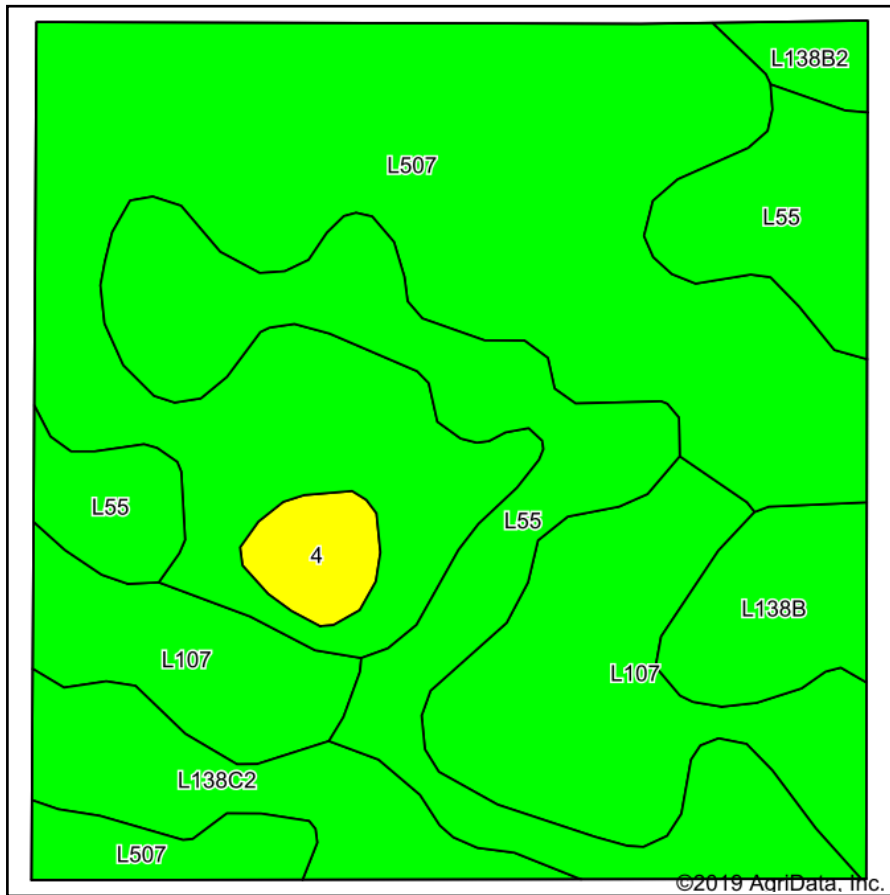

Soils data provided by USDA and NRCS.

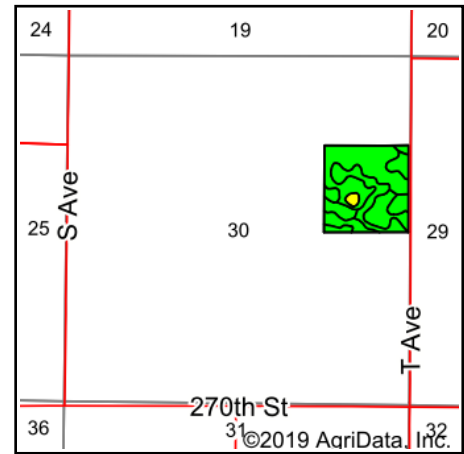

State: **Iowa**
 County: **Greene**
 Location: **30-83N-29W**
 Township: **Washington**
 Acres: **38.56**
 Date: **3/21/2019**

PEOPLES COMPANY
 INNOVATIVE. REAL ESTATE. SOLUTIONS.

Maps Provided By:

surety
 CUSTOMIZED ONLINE MAPPING
 © AgriData, Inc. 2019 www.AgriDataInc.com



Area Symbol: IA073, Soil Area Version: 24

Code	Soil Description	Acres	Percent of field	CSR2 Legend	Non-Irr Class *c	CSR2**	CSR	*n NCCPI Overall
L507	Canisteo clay loam, Bemis moraine, 0 to 2 percent slopes	17.21	44.6%		IIw	87		79
L55	Nicollet loam, 1 to 3 percent slopes	9.03	23.4%		Ie	91		83
L107	Webster clay loam, Bemis moraine, 0 to 2 percent slopes	6.83	17.7%		IIw	88		80
L138C2	Clarion loam, Bemis moraine, 6 to 10 percent slopes, moderately eroded	2.48	6.4%		IIIe	83		60
L138B	Clarion loam, Bemis moraine, 2 to 6 percent slopes	1.75	4.5%		Ile	88		79
4	Knoke silty clay loam, 0 to 1 percent slopes	0.75	1.9%		IIIw	56	58	75
L138B2	Clarion loam, Bemis moraine, 2 to 6 percent slopes, moderately eroded	0.51	1.3%		Ile	85		63
Weighted Average						87.3	*-	*n 78.6

**IA has updated the CSR values for each county to CSR2.

*- CSR weighted average cannot be calculated on the current soils data, use prior data version for csr values.

*n: The aggregation method is "Weighted Average using major components"

*c: Using Capabilities Class Dominant Condition Aggregation Method

Soils data provided by USDA and NRCS.