

# Soils Map

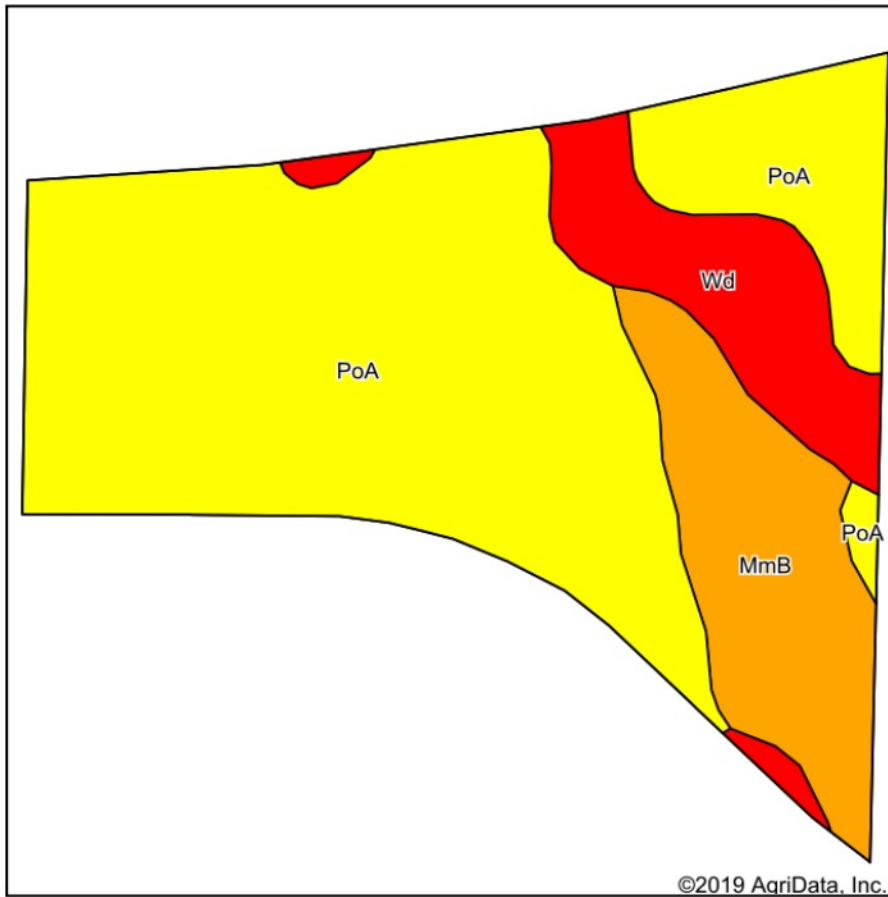

Soils data provided by USDA and NRCS.

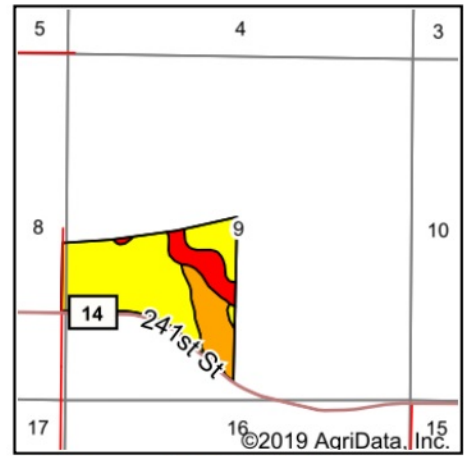

State: **South Dakota**  
 County: **Lyman**  
 Location: **9-105N-76W**  
 Township: **South Lyman**  
 Acres: **89.68**  
 Date: **11/7/2019**



Maps Provided By:



Area Symbol: SD085, Soil Area Version: 20

Code	Soil Description	Acres	Percent of field	PI Legend	Non-Irr Class *c	Irr Class *c	Productivity Index	Tall wheatgrass
PoA	Promise clay, 0 to 3 percent slopes	62.38	69.6%		IIIIs	IIIIs	68	
MmB	Millboro silty clay, 3 to 6 percent slopes	15.54	17.3%		IIIe	IIIe	79	
Wd	Wendte silty clay, channeled	11.76	13.1%		VIW		33	2.5
Weighted Average							65.3	0.3

\*c: Using Capabilities Class Dominant Condition Aggregation Method  
 Soils data provided by USDA and NRCS.