

State of Idaho
Department of Water Resources

Water Right 75-4140

IRRIGATION

The map depicts the place of use for the water use listed above and point(s) of diversion of this right as currently derived from interpretations of the paper records and is used solely for illustrative purposes. Discrepancies between the computer representation and the permanent document file will be resolved in favor of the actual water right documents in the water right file.

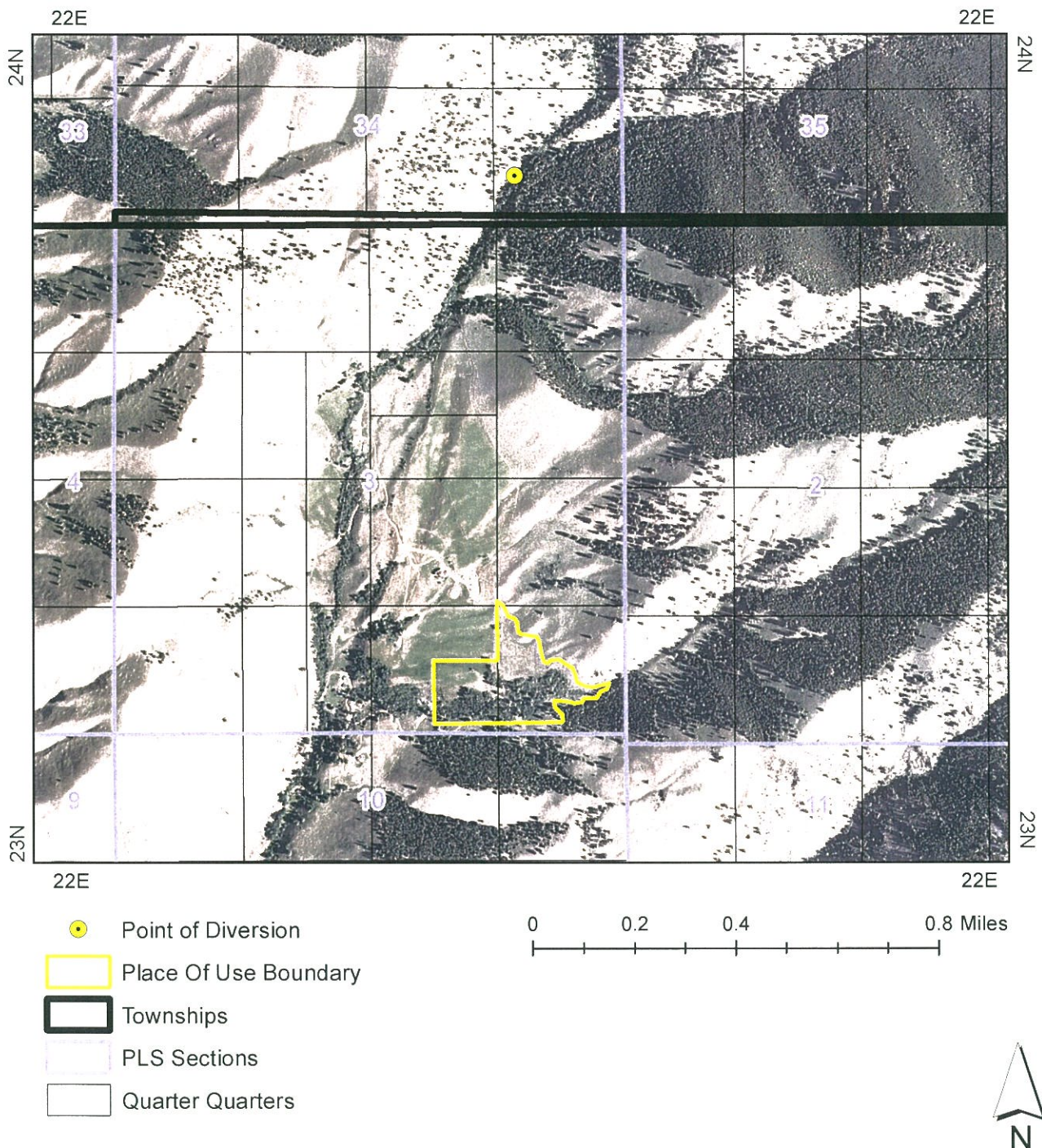

Close

IDAHO DEPARTMENT OF WATER RESOURCES
Water Right Report

9/8/2015

WATER RIGHT NO. 75-4140

<u>Owner Type</u>	<u>Name and Address</u>
Current Owner	KENNETH RANEN
Current Owner	NANCY RANEN
	BOX 32
	CARMEN, ID 83462

Priority Date: 05/10/1913

Basis: Decreed

Status: Active

<u>Source</u>	<u>Tributary</u>
EAST FORK TOWER CREEK	TOWER CREEK

<u>Beneficial Use</u>	<u>From</u>	<u>To</u>	<u>Diversion Rate</u>	<u>Volume</u>
IRRIGATION	04/01	11/01	0.15 CFS	
Total Diversion			0.15 CFS	

Location of Point(s) of Diversion:

TOWER CREEK|SESE|Sec. 34|Township 24N|Range 22E|LEMHI County

Place(s) of use:

Place of Use Legal Description: IRRIGATION LEMHI County

<u>Township</u>	<u>Range</u>	<u>Section</u>	<u>Lot</u>	<u>Tract</u>	<u>Acres</u>	<u>Lot</u>	<u>Tract</u>	<u>Acres</u>	<u>Lot</u>	<u>Tract</u>	<u>Acres</u>	<u>Lot</u>	<u>Tract</u>	<u>Acres</u>
23N	22E	3		SWSE	10		SESE	16						

✦ Total Acres: 26

Conditions of Approval:

- | | |
|-------|---|
| 1.C18 | This partial decree is subject to such general provisions necessary for the definition of the rights or for the efficient administration of the water rights as may be ultimately determined by the Court at a point in time no later than the entry of a final unified decree. Section 42-1412(6), Idaho Code. |
|-------|---|

Dates:

Licensed Date:

Decreed Date: 11/17/2008

Enlargement Use Priority Date:

Enlargement Statute Priority Date:

Water Supply Bank Enrollment Date Accepted:

Water Supply Bank Enrollment Date Removed:

Application Received Date:

Protest Deadline Date:

Number of Protests: 0

Other Information:

State or Federal: S

Owner Name Connector: OR

Water District Number:

Generic Max Rate per Acre:

Generic Max Volume per Acre:

Civil Case Number:

Old Case Number:

Decree Plaintiff:

Decree Defendant:

Swan Falls Trust or Nontrust:

Swan Falls Dismissed:

DLE Act Number:

Cary Act Number:

Mitigation Plan: False

Close

Close

IDAHO DEPARTMENT OF WATER RESOURCES
Water Right Report

9/8/2015

WATER RIGHT NO. 75-7152

<u>Owner Type</u>	<u>Name and Address</u>
Current Owner	KENNETH RANEN
Current Owner	NANCY RANEN
	BOX 32
	CARMEN, ID 83462

Priority Date: 10/09/1979

Basis: Decreed

Status: Active

<u>Source</u>	<u>Tributary</u>
SPRING	EAST FORK TOWER CREEK

<u>Beneficial Use</u>	<u>From</u>	<u>To</u>	<u>Diversion Rate</u>	<u>Volume</u>
DOMESTIC	1/01	12/31	0.04 CFS	1.2 AFA
Total Diversion			0.04 CFS	

Location of Point(s) of Diversion:

SPRING|SESESE|Sec. 03|Township 23N|Range 22E|LEMHI County

Place(s) of use:

Place of Use Legal Description: DOMESTIC LEMHI County

<u>Township</u>	<u>Range</u>	<u>Section</u>	<u>Lot</u>	<u>Tract</u>	<u>Acres</u>	<u>Lot</u>	<u>Tract</u>	<u>Acres</u>	<u>Lot</u>	<u>Tract</u>	<u>Acres</u>	<u>Lot</u>	<u>Tract</u>	<u>Acres</u>
23N	22E	3		SESE										

Conditions of Approval:

1. N13 THE QUANTITY OF WATER UNDER THIS RIGHT SHALL NOT EXCEED 13,000 GALLONS PER DAY.
2. N11 THE QUANTITY OF WATER DECREED FOR THIS WATER RIGHT IS NOT A DETERMINATION OF HISTORICAL BENEFICIAL USE.
3. RP 23N22E039000A

Dates:

Licensed Date:

Decreed Date: 09/15/2000

Permit Proof Due Date: 11/1/1984

Permit Proof Made Date: 1/1/1900

Permit Approved Date: 11/7/1979

Permit Moratorium Expiration Date:

Enlargement Use Priority Date:

Enlargement Statute Priority Date:

Water Supply Bank Enrollment Date Accepted:

Water Supply Bank Enrollment Date Removed:

Application Received Date:

Protest Deadline Date:

Number of Protests: 0

Other Information:

State or Federal: S

Owner Name Connector: OR

Water District Number:

Generic Max Rate per Acre:

Generic Max Volume per Acre:

Civil Case Number:

Old Case Number:

Decree Plaintiff:

Decree Defendant:

Swan Falls Trust or Nontrust:

Swan Falls Dismissed:

DLE Act Number:

Cary Act Number:

Mitigation Plan: False

Close

