

Soils Map

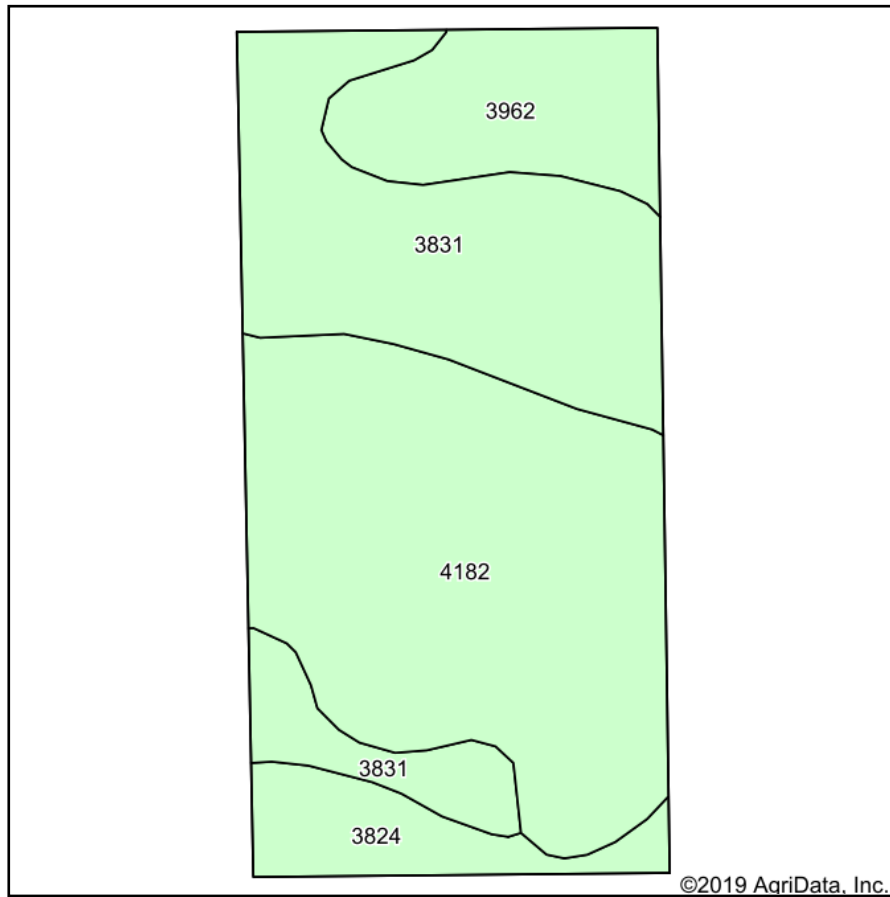

Soils data provided by USDA and NRCS.

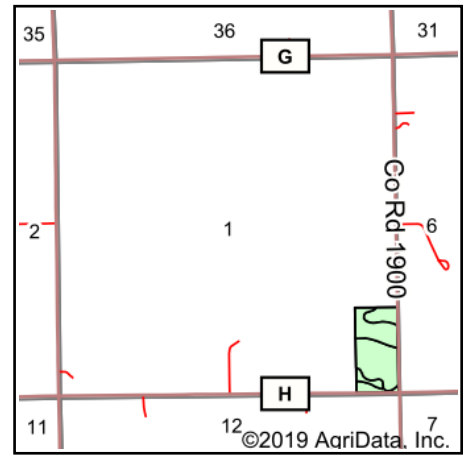

State: **Nebraska**
 County: **Saline**
 Location: **1-7N-3E**
 Township: **Pleasant Hill**
 Acres: **20.08**
 Date: **2/9/2020**

 **The Pinnacle Agency**
 FARM MANAGEMENT-REAL ESTATE

Maps Provided By:

 **surety**
 CUSTOMIZED ONLINE MAPPING
 © AgriData, Inc. 2019 www.AgriDataInc.com



Area Symbol: NE151. Soil Area Version: 19

Code	Soil Description	Acres	Percent of field	Non-Irr Class *c	Irr Class *c	SRPG	*n NCCPI Soybeans
4182	Longford silty clay loam, 7 to 11 percent slopes, eroded	9.32	46.4%	IVe	IVe	64	51
3831	Crete silty clay loam, 3 to 7 percent slopes, eroded	6.65	33.1%	IIIe	IIIe	68	49
3962	Hastings silty clay loam, 7 to 11 percent slopes, eroded	2.58	12.8%	IVe	IVe	64	53
3824	Crete silt loam, 0 to 1 percent slopes	1.53	7.6%	IIIs	IIIs	71	63
Weighted Average						65.9	*n 51.5

*n: The aggregation method is "Weighted Average using major components"

*c: Using Capabilities Class Dominant Condition Aggregation Method

Soils data provided by USDA and NRCS.