

DRY FLY EAST

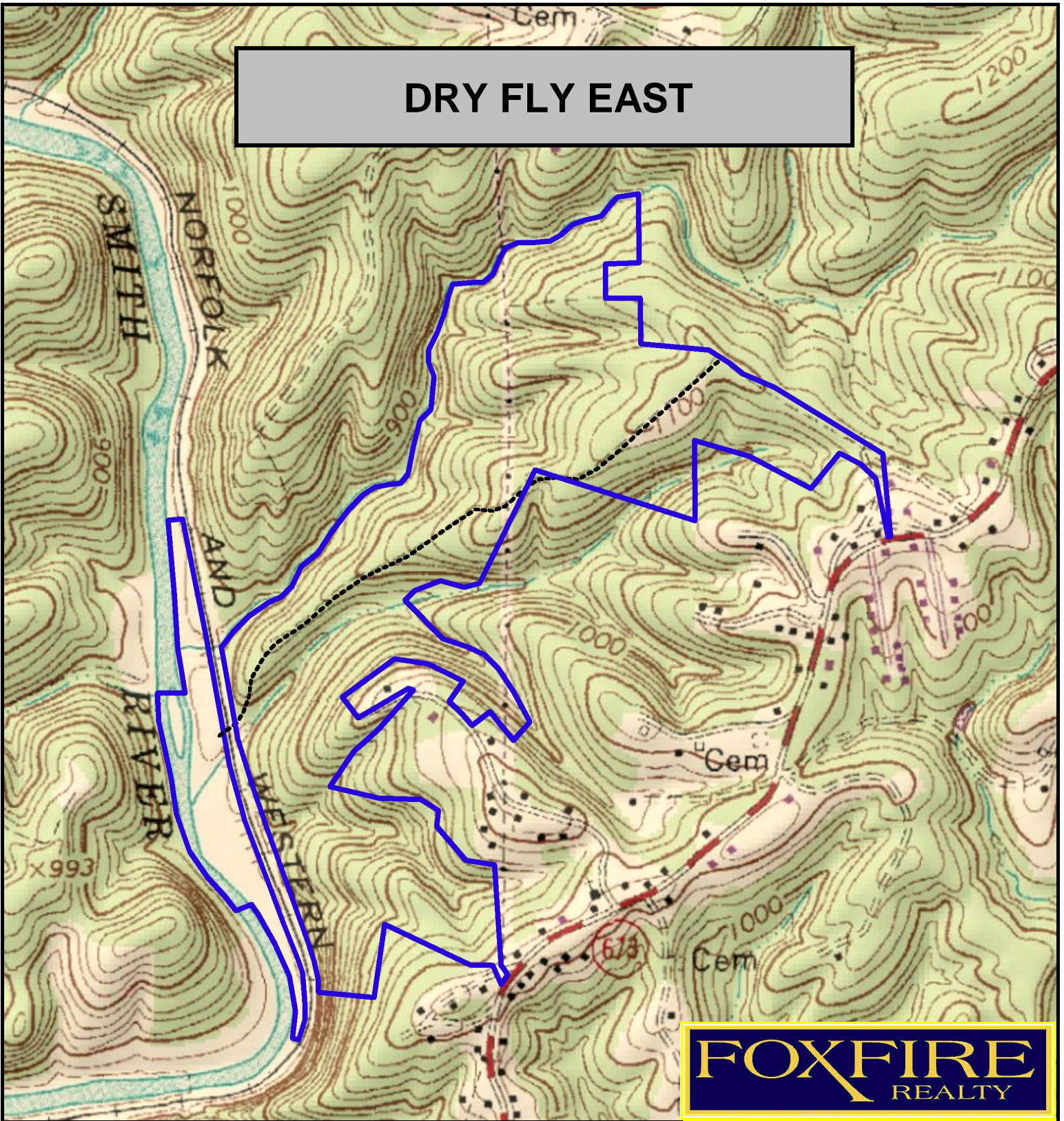

FOXFIRE
REALTY

DRY FLY EAST (topographic map)
Henry County, Virginia
Elevation Range: 804' - 1139' +/-; Google Coordinates:
LAT 36.783668 (N), LON -79.977439 (W) This map is for general
location purposes. Consult a licensed surveyor for exact boundary
and acreage information.

RICHARD GRIST, Broker - Auctioneer - Forester
304.646.8837 Richard@Foxfirenation.com
WWW.FOXFIRENATION.COM

FOR TOPO

SCALE 1:9600

1 inch = 800 ft.

