

CANEY FORK LAND  
COMPANY GP SURVEY  
SEQUATCHIE, LLC PROPERTY  
TAYLORS CHAPEL ROAD  
8TH CIVIL DISTRICT  
CUMBERLAND COUNTY, TENNESSEE  
DATE 27 AUGUST 2018  
TOTAL ACRES 11.45  
DEED REF: BOOK 1235 PAGE 54  
P/O TAX MAP 123 PARCEL 33.00

EDWARD A. LEMPA  
Map 122 Parcel 19.00  
Book 1195 Page 1862  
Book 1376 Page 2175

Note: The point of beginning is located N 72°29'45" E  
128.75 feet from a power pole.

Note: Every document of record reviewed and  
considered as a part of this survey is noted hereon.  
This survey is prepared from the current deed of  
record and does not represent a title search or a  
guarantee of title and is subject to any state of  
facts that a current accurate title search will reveal.

This is a boundary line survey. There is absolutely  
no certification made as to the existence or  
non-existence of the following: wetlands; easements  
or rights-of-way unless otherwise noted hereon;  
sub-surface utilities or streams; above ground  
utilities other than those which are clearly shown  
and labeled as such hereon; buildings, structures,  
ponds, lakes or streams other than those which are  
clearly shown and labeled as such hereon; flood  
areas or designated flood zones unless otherwise  
noted; or any and all other land features that could  
be deemed topographic.

Note: The plat drawn hereon is subject to  
regulatory authority and is subject to change  
according to physical evidence. (i.e. bluffs, lines,  
painted lines, roads, lakes, ponds, indicia of  
ownership, etc.)

Note: This property may be subject to utility  
ingress/egress and/or right-of-way.

I hereby certify that this is a category II survey and  
that the ratio of precision of the unadjusted survey  
is at minimum 1:7500 as shown hereon and has  
been performed in compliance with current  
Tennessee Minimum Standards of Practice.

Drawn by: CHN File No: 18-220c1 tract 4

TAYLORS CHAPEL ROAD  
(Public Access)

SEQUATCHIE, LLC  
P/O Map 123 Parcel 33.00  
Book 1235 Parcel 54

Tract #4  
11.45 Ac

LINE	BEARING	DISTANCE
L1	S 55°01'09" E	44.86'
L2	S 01°30'56" W	9.31'
L3	N 82°36'38" W	32.05'
L4	N 82°36'38" W	19.24'
L5	N 01°21'44" E	78.33'
L6	N 00°30'44" E	32.41'
L7	N 71°31'02" E	74.27'

CURVE	RADIUS	ARC LENGTH	CHORD BEARING	CHORD LENGTH
C1	413.41'	22.85'	N 72°10'10" E	22.85'

LEGEND	
	CENTER LINE OF RIVER
	POWER POLE
	1/2" PIPE (set)
	ROAD
	TREE

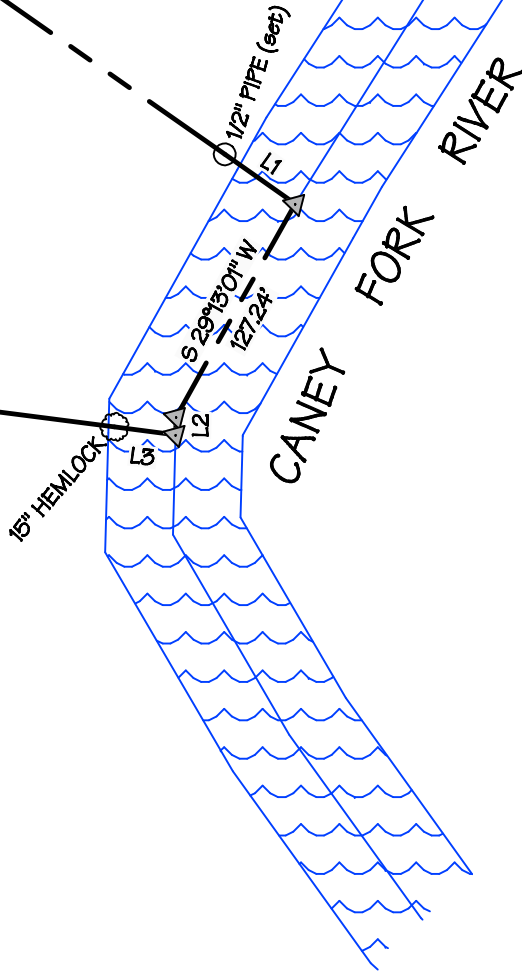

Christopher M. Vick, RLS #2164  
VICK SURVEYING, LLC  
2772 Hidden Cove Road, Cookeville, TN 381-372-1286