

KS - Barber Diggins 430 acres +/-
Rayville



Brown Realty Co

Jerry Brown

(318) 728-9544

jbrown@brownrealtyco.com

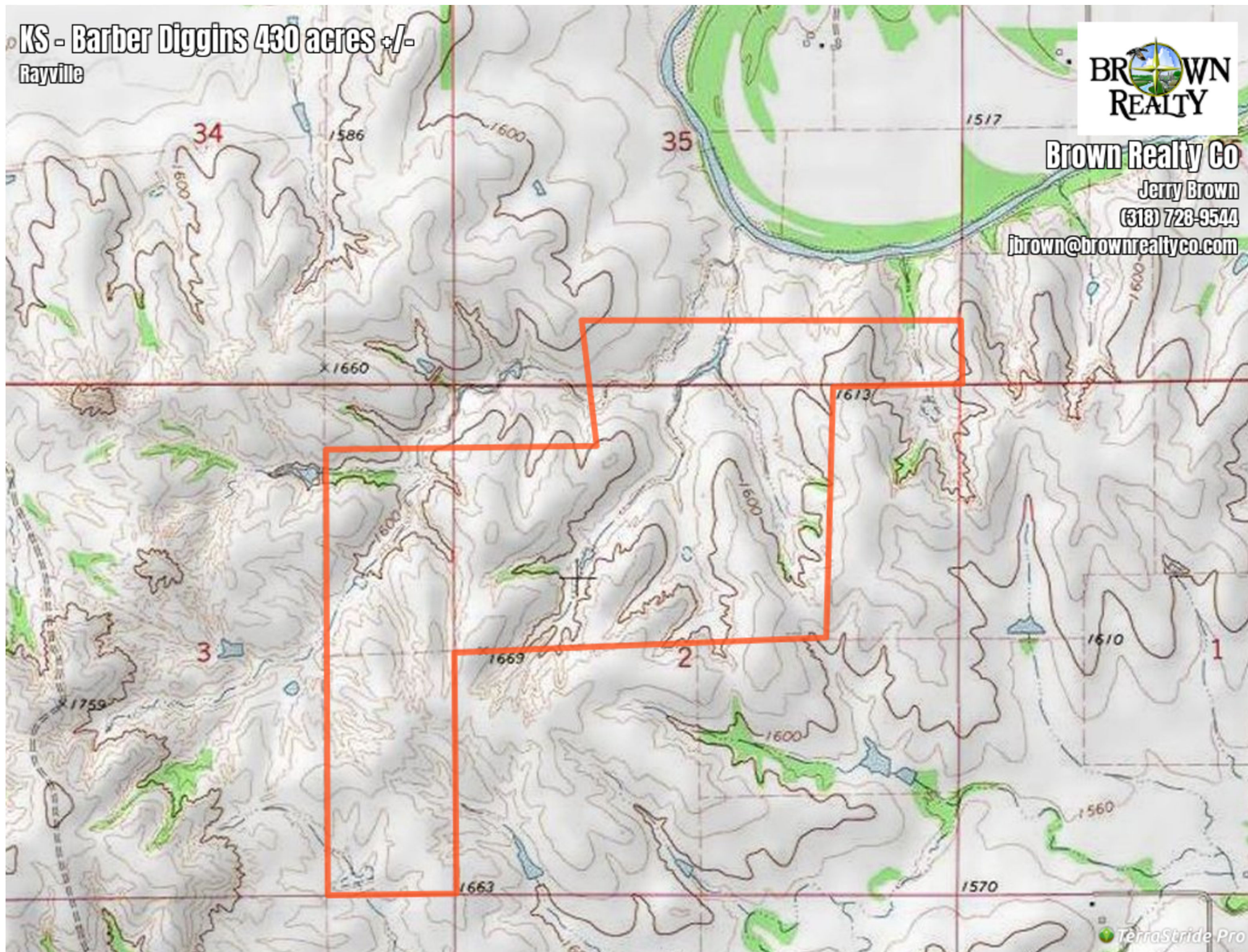

KS - Barber Diggins 430 acres +/-

Legend

Boundary

Description

Set up for food plots, with deer stands & blinds in place, lots of deer cover. Shooting lanes from blinds & stands to feeders. 2 200lb steel feeders, 2 1000lb plastic feeders, 2 potbelly blinds, 1 reg blind all secured with augers & cables. Some new fence s line and e line. Brown Realty Co Jerry Brown, Broker 2189 Hwy 425 Rayville, LA 71269 318-728-9544

DISCLAIMER: The information contained herein is as obtained by this broker from sellers, owners, or other sources. This information is considered reliable, neither this broker nor owners make any guarantee, warranty or representation as to correctness of any data or descriptions and the accuracy of such statements. The correctness and / or accuracy of any and all statements should be determined through independent investigation made by the prospective purchaser. Any offer for sale is subject to prior sale, errors and omissions, change of price, terms or other conditions or withdrawal from sale in whole or in part, by seller without notice and at the sole discretion of seller. Readers are urged to form their own independent conclusions and evaluations in consultation with legal counsel, accountants, and/or investment advisors concerning and all material contained herein.

Generated on: May 22, 2020