

# Soils Map

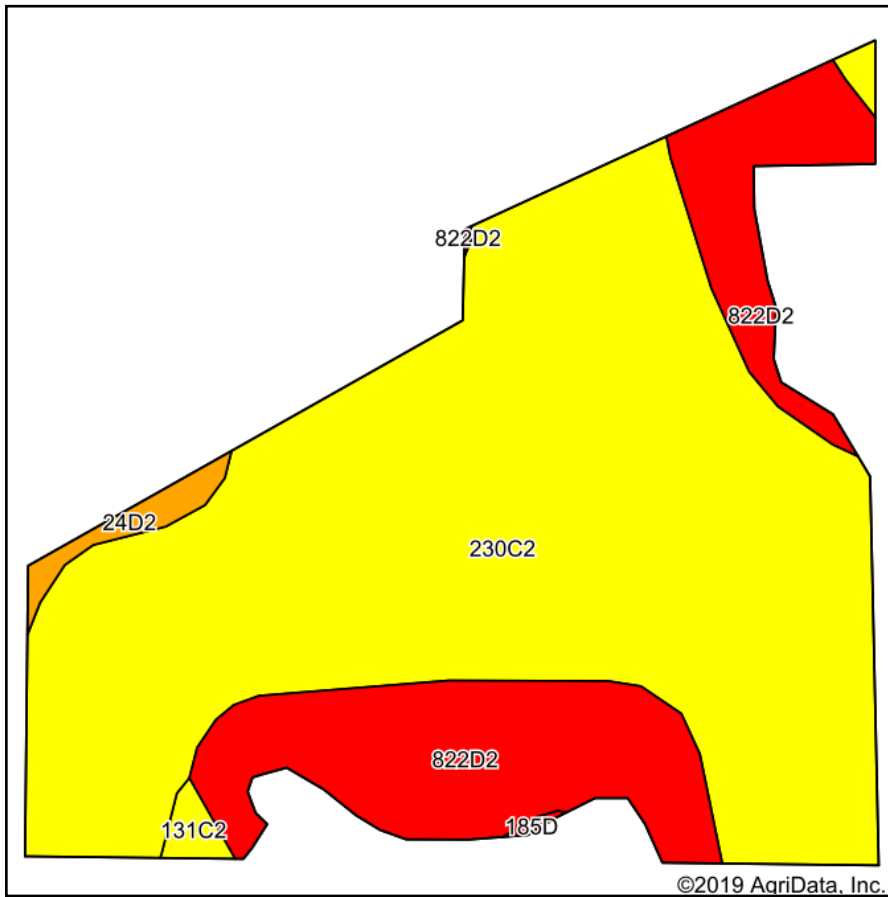

Soils data provided by USDA and NRCS.

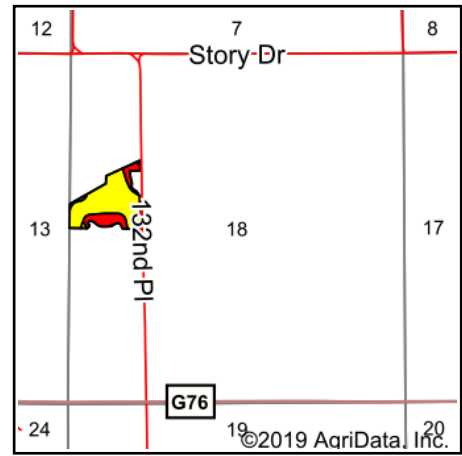

State: **Iowa**  
 County: **Marion**  
 Location: **18-74N-19W**  
 Township: **Indiana**  
 Acres: **15.87**  
 Date: **6/12/2020**



Maps Provided By:



Area Symbol: IA125. Soil Area Version: 28

Code	Soil Description	Acres	Percent of field	CSR2 Legend	Non-Irr Class *c	CSR2**	CSR	*n NCCPI Overall	*n NCCPI Corn	*n NCCPI Small Grains	*n NCCPI Soybeans
230C2	Clearfield-Arispe silty clay loams, 5 to 9 percent slopes, moderately eroded	12.06	76.0%		IIIw	58	53	61	61	49	59
822D2	Lamoni silty clay loam, 9 to 14 percent slopes, moderately eroded	3.46	21.8%		IVe	10	15	69	69	45	49
24D2	Shelby loam, 9 to 14 percent slopes, moderately eroded	0.23	1.4%		IIIe	45	48	58	58	44	52
131C2	Pershing silt loam, 5 to 9 percent slopes, moderately eroded	0.12	0.8%		IIIe	62	49	60	60	34	49
Weighted Average						47.4	44.6	*n 62.7	*n 62.7	*n 47.9	*n 56.6

\*\*IA has updated the CSR values for each county to CSR2.

\*n: The aggregation method is "Weighted Average using major components"

\*c: Using Capabilities Class Dominant Condition Aggregation Method

Soils data provided by USDA and NRCS.