

Tillable Soils Map

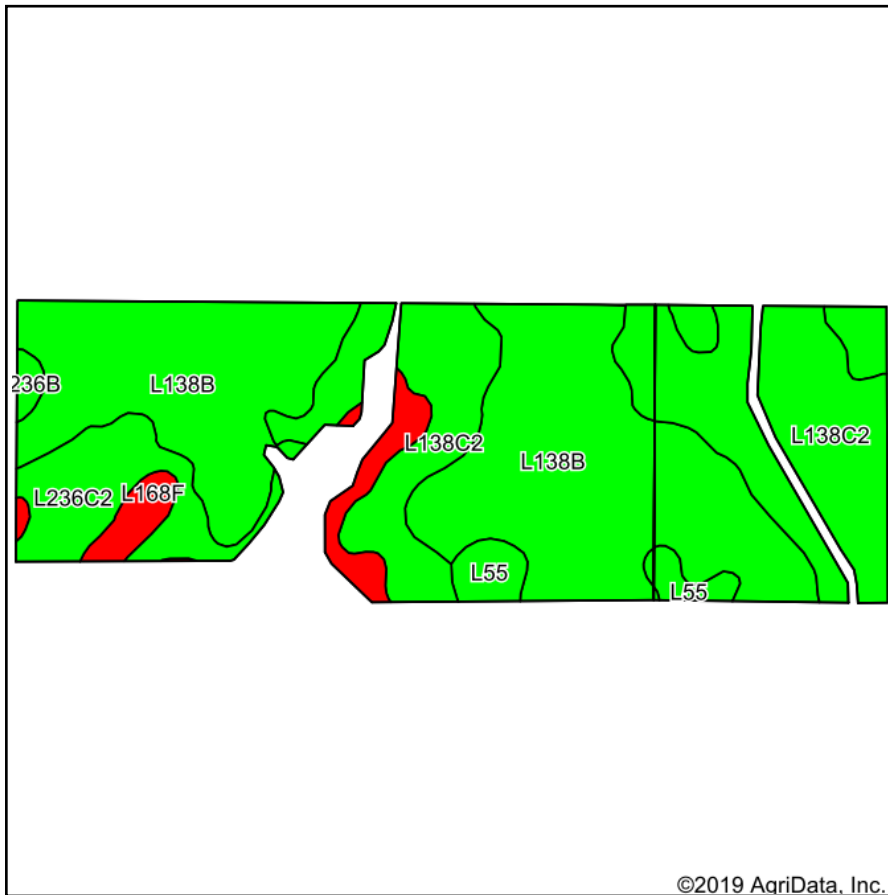

Soils data provided by USDA and NRCS.

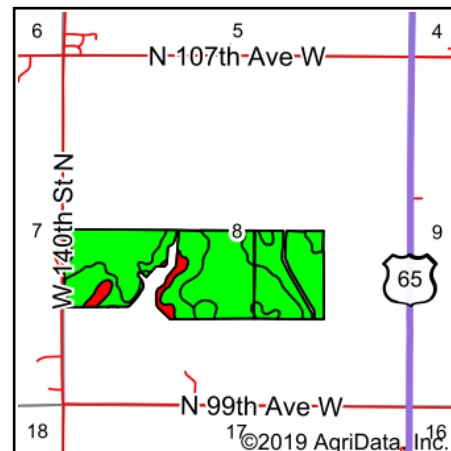

State: **Iowa**
 County: **Jasper**
 Location: **8-81N-21W**
 Township: **Clear Creek**
 Acres: **107**
 Date: **6/22/2020**



Maps Provided By:



© AgriData, Inc. 2019

www.AgriDataInc.com

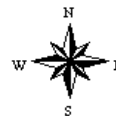

Area Symbol: IA099. Soil Area Version: 25									
Code	Soil Description	Acres	Percent of field	CSR2 Legend	Non-Irr Class *c	*i Corn	*i Soybeans	CSR2**	*n NCCPI Overall
L138B	Clarion loam, Bemis moraine, 2 to 6 percent slopes	55.72	52.1%		Ile	220.8	64	88	79
L138C2	Clarion loam, Bemis moraine, 6 to 10 percent slopes, moderately eroded	33.08	30.9%		IIle	0	0	83	60
L236C2	Lester loam, Bemis moraine, 6 to 10 percent slopes, moderately eroded	9.00	8.4%		IIIle	0	0	77	65
L168F	Hayden loam, Bemis moraine, 22 to 40 percent slopes	5.32	5.0%		VIIle	0	0	5	19
L55	Nicollet loam, 1 to 3 percent slopes	3.20	3.0%		Ile	0	0	91	83
L236B	Lester loam, Bemis moraine, 2 to 6 percent slopes	0.68	0.6%		Ile	0	0	85	89
Weighted Average						115	33.3	81.5	*n 69.1

**IA has updated the CSR values for each county to CSR2.

*i Yield data provided by the ISPAID Database version 8.1.1 developed by IA State University.

*n: The aggregation method is "Weighted Average using major components"

*c: Using Capabilities Class Dominant Condition Aggregation Method

Soils data provided by USDA and NRCS.