

LAND FOR SALE

GARDEN COUNTY 80



Location: 22 miles southwest of Oshkosh, NE or 19 miles northwest of Chappell, Nebraska in the SW corner of Garden County at the junction of County Roads 153 & 40 (9 Mile Road).

Legal Description: N1/2NW1/4 Section 15-T15N-R46W of the 6th P.M., Garden County, Nebraska.

Acres/Taxes: 80.61 tax assessed acres; 2019 taxes - \$731.86

Soils: 50% Class II & III silt loams, 50% Class IV Sidney Canyon Complex.

FSA Info: 79.94 cropland acres; 66.91 acres wheat base @ 38 bu. PLC yield

Price: \$72,000.00

Comments: This property has excellent access with county roads on 2 sides. Currently the East 40 acres are in growing wheat and the West 40 are worked fallow ground.

Contact: Mike Polk, Listing Agent 308-539-4446 | mike@agriaffiliates.com
John Childears, Don Walker, Bruce Dodson, Chase Dodson, Roger Luehrs,
Brian Reynolds, Tony Eggleston Brad Atkins



Mike Polk
Listing Agent

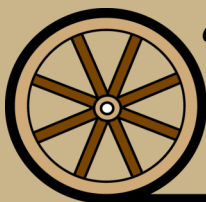

Offered Exclusively By:

AGRI AFFILIATES, INC.
Providing Farm - Ranch Real Estate Services

Information contained herein was obtained from sources deemed reliable. We have no reason to doubt the accuracy, but the information is not guaranteed. Prospective Buyers should verify all information. All maps provided by Agri Affiliates, Inc. are approximations only, to be used as a general guideline, and not intended as survey accurate. As with any agricultural land, this property may include noxious weeds. Agri Affiliates, Inc. and all agents are acting as Agent of the Seller.

NORTH PLATTE
401 Halligan Dr.
P.O. Box 1166
North Platte, NE 69103
www.agriaffiliates.com
(308) 534-9240
Fax (308) 534-9244

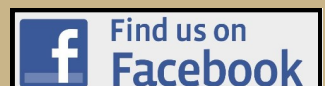

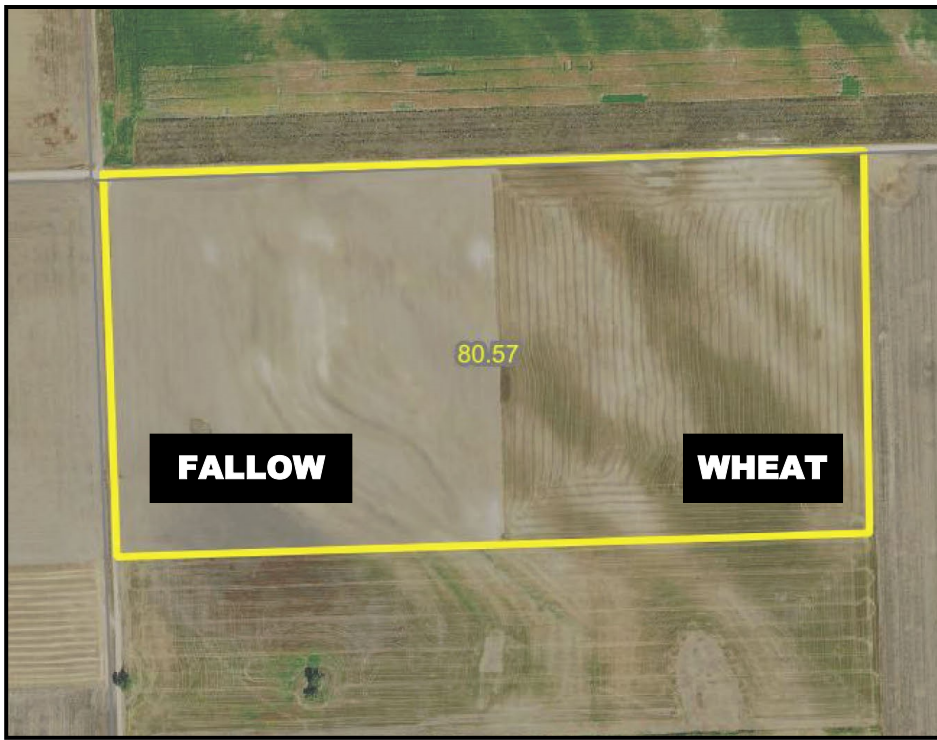

Area Symbol: NE069, Soil Area Version: 18

Code	Soil Description	Acres	Percent of field	Non-Irr Class Legend	Non-Irr Class *c	Irr Class *c	Range Production (lbs/acre/yr)	SRPG	Corn Irrigated	Winter wheat	Winter wheat Irrigated
1841	Sidney-Canyon complex, 6 to 9 percent slopes	40.23	49.9%		IVe	IVe	1550	29	70	18	
5101	Alliance loam, 1 to 3 percent slopes	14.64	18.2%		Ile	Ile	1703	60	140	40	59
5942	Duroc loam, 0 to 1 percent slopes	10.30	12.8%		IIc	Iw	2450	58			
1661	Lodgepole silt loam, frequently ponded	9.06	11.2%		IIIw	IVw	2000	17			
1650	Kuma loam, 0 to 1 percent slopes	6.34	7.9%		IIc	Iw	1703	60	144	40	79
Weighted Average							1755.5	39.4	71.7	19.4	16.9

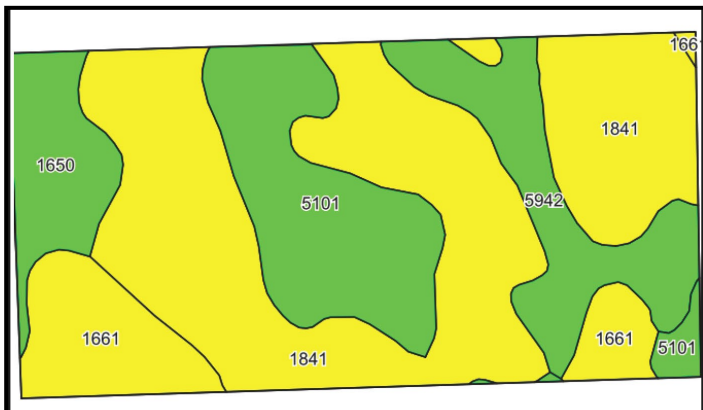
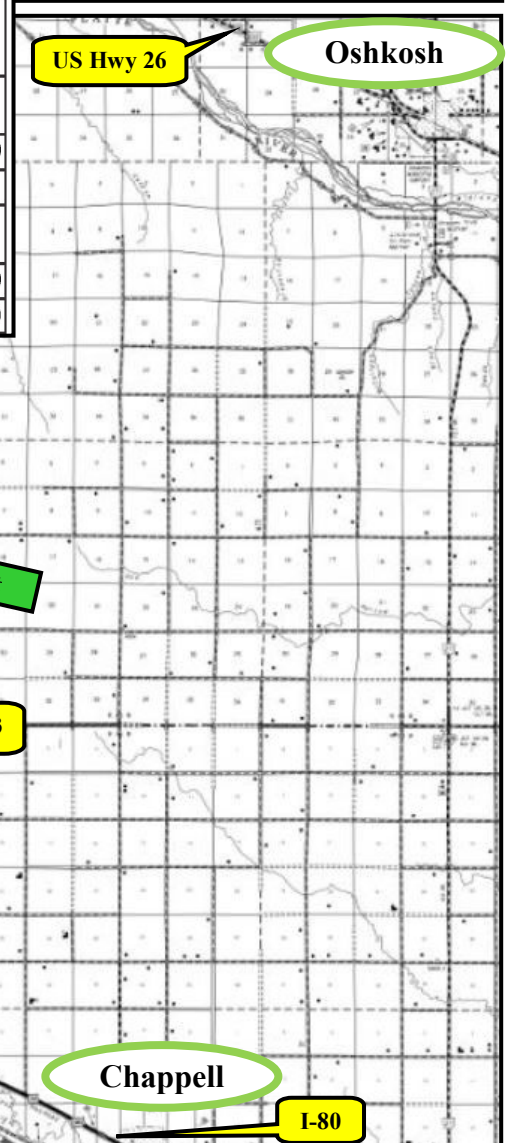

401 Halligan Dr. - P.O. Box 1166
 North Platte, NE 69103
www.agriaffiliates.com
 (308) 534-9240