

# Soils Map - Total Acres

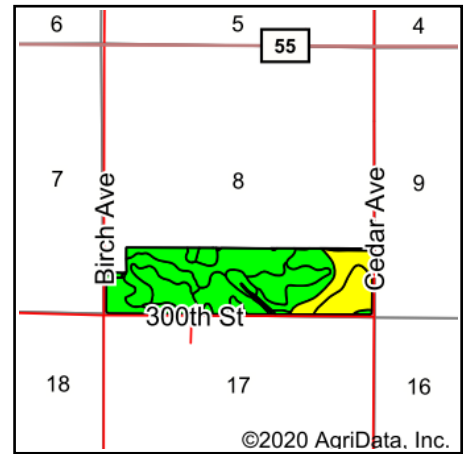

State: **Iowa**  
 County: **Butler**  
 Location: **8-90N-18W**  
 Township: **Washington**  
 Acres: **150.82**  
 Date: **7/7/2020**

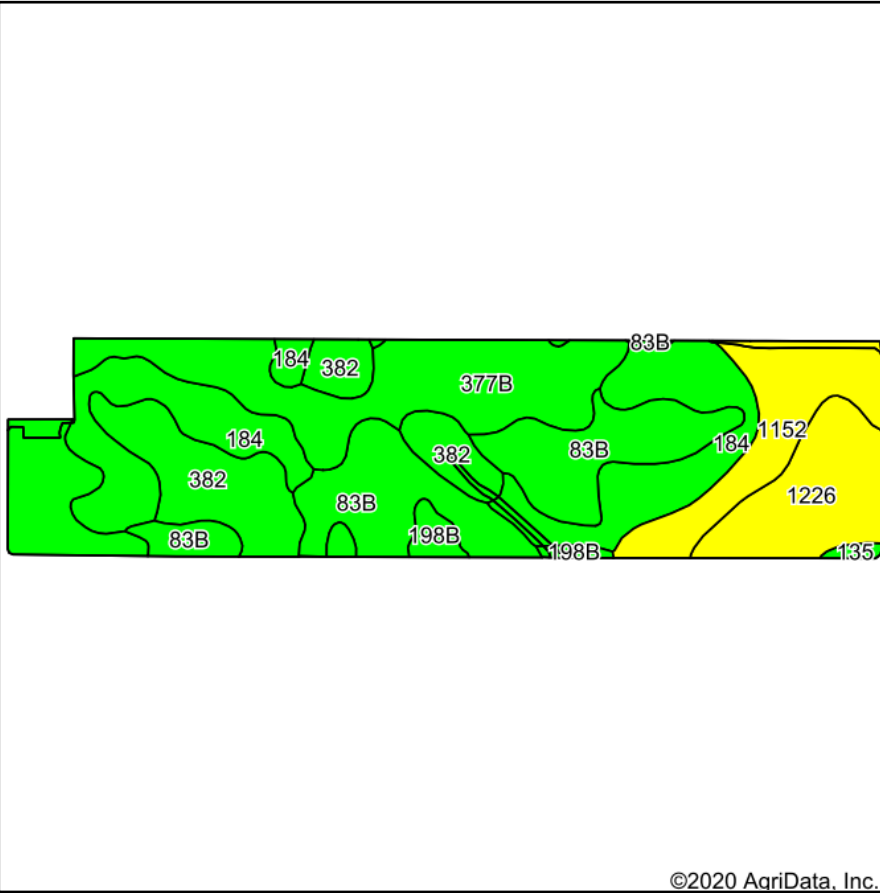

Maps Provided By:



Soils data provided by USDA and NRCS.

Area Symbol: IA023. Soil Area Version: 25																	
Code	Soil Description	Acres	Percent of field	CSR2 Legend	Non-Irr Class *c	*i Corn	*i Alfalfa	*i Soybeans	CSR2**	CSR	Corn	Oats	Soybeans	*n NCCPI Overall	*n NCCPI Corn	*n NCCPI Small Grains	*n NCCPI Soybeans
377B	Dinsdale silty clay loam, 2 to 5 percent slopes	35.98	23.9%		Ile	232	6.5	67.3	94	90				88	88	57	75
184	Klinger silty clay loam, 1 to 4 percent slopes	32.13	21.3%		Iw	240	6.2	69.6	95	95				88	88	31	81
83B	Kenyon loam, 2 to 5 percent slopes	29.77	19.7%		Ile	225.6	6.3	65.4	90	85	210	91	61	84	84	51	75
382	Maxfield silty clay loam, 0 to 2 percent slopes	19.98	13.2%		Ilw	230.4	4.8	66.8	87	90				74	74	11	63
1152	Marshan clay loam, 0 to 2 percent slopes, rarely flooded	14.80	9.8%		Ilw	166.4	3.5	48.3	54	68				84	84	14	58
1226	Lawler loam, 0 to 2 percent slopes, rarely flooded	14.44	9.6%		Ils	80	2.1	23.2	59	72				86	86	31	61
198B	Floyd loam, 1 to 4 percent slopes	3.11	2.1%		Ilw	222.4	5.8	64.5	89	75				84	84	34	83

135	Coland clay loam, 0 to 2 percent slopes	0.61	0.4%		llw	198.4	4.2	57.5	74	80				94	94	57	89
<b>Weighted Average</b>						<b>210.9</b>	<b>5.4</b>	<b>61.2</b>	<b>85</b>	<b>85.8</b>	<b>41.5</b>	<b>18</b>	<b>12</b>	<b>*n 84.7</b>	<b>*n 84.7</b>	<b>*n 37</b>	<b>*n 71.9</b>

\*\*IA has updated the CSR values for each county to CSR2.

\*i Yield data provided by the ISPAID Database version 8.1.1 developed by IA State University.

\*n: The aggregation method is "Weighted Average using major components"

\*c: Using Capabilities Class Dominant Condition Aggregation Method

Soils data provided by USDA and NRCS.