

**Parcel Information**

<b>Parcel #:</b> 40048
<b>Account:</b> R321800700
<b>Related:</b>
<b>Site Address:</b> 24515 NE Highway 240 Newberg OR 97132 - 7308
<b>Owner:</b> Spain, William R
<b>Owner2:</b> Spain, Kaitlynn
<b>Owner Address:</b> 24515 NE Highway 240 Newberg OR 97132 - 7308
<b>Twn/Range/Section:</b> 03S / 00W / 18
<b>Parcel Size:</b> 4.00 Acres (174,240 SqFt)
<b>Plat/Subdivision:</b>
<b>Lot:</b>
<b>Block:</b>
<b>Map Page/Grid:</b> 713-B6
<b>Census Tract/Block:</b> 030102 / 1017
<b>Waterfront:</b>

**Assessment Information**

<b>Market Value Land:</b>	\$349,281.00
<b>Market Value Impr:</b>	\$136,314.00
<b>Market Value Total:</b>	\$485,595.00
<b>Assessed Value:</b>	\$98,421.00

**Tax Information**

<b>Levy Code Area:</b> 29.2
<b>Levy Rate:</b> 12.4768
<b>Tax Year:</b> 2019
<b>Annual Tax:</b> \$1,227.98
<b>Exemption Description:</b>

**Legal**

See Metes &amp; Bounds

**Land**

<b>Cnty Land Use:</b> 541 - Farm - Unzoned farm land - Improved (typical of class)	<b>Cnty Bldg Use:</b> 18 - 1 Story with Attic
<b>Land Use Std:</b> AFAR - Farms And Crops	<b>Zoning:</b> VLDR-1 - Rural Residential
<b>Neighborhood:</b> Rural Newberg	<b>Recreation:</b>
<b>Watershed:</b> Chehalem Creek-Willamette River	<b>School District:</b> 29J Newberg School District
<b>Primary School:</b> Ewing Young Elementary School	<b>Middle School:</b> Mountain View Middle School
<b>High School:</b> Newberg Senior High School	

**Improvement**

<b>Year Built:</b> 1900	<b>Attic Fin/Unfin:</b> 446 SqFt / 0 SqFt	<b>Fireplace:</b>
<b>Bedrooms:</b> 3	<b>Total Baths:</b> 1.00	<b>Full/Half Baths:</b> 1 / 0
<b>Total Area:</b> 1,646 SqFt	<b>Bsmt Fin/Unfin:</b>	<b>Garage:</b> 448 SqFt
<b>Bldg Fin:</b> 1,646 SqFt	<b>1st Floor:</b> 1,200 SqFt	<b>2nd Floor:</b>

**Transfer Information**

<b>Rec. Date:</b> 3/29/2019	<b>Sale Price:</b> \$420,000.00	<b>Doc Num:</b> 2019-03792	<b>Doc Type:</b> Deed
<b>Owner:</b> William R Spain	<b>Grantor:</b>		
<b>Orig. Loan Amt:</b> \$336,000.00	<b>Title Co:</b> FIRST AMERICAN TITLE		
<b>Finance Type:</b>	<b>Loan Type:</b> Conventional	<b>Lender:</b> GUILD MTG CO	

Sentry Dynamics, Inc. and its customers make no representations, warranties or conditions, express or implied, as to the accuracy or completeness of information contained in this report.

**TICOR TITLE™**

**Site Address: 24515 NE Highway 240**

Sentry Dynamics, Inc. and its customers make no representations, warranties or conditions, express or implied, as to the accuracy or completeness of information contained in this report.

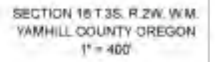

3 2 18

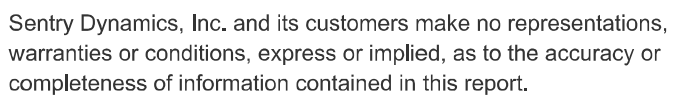



**TICOR TITLE™**

Sentry Dynamics, Inc. and its customers make no representations, warranties or conditions, express or implied, as to the accuracy or completeness of information contained in this report.





Sentry Dynamics, Inc. and its customers make no representations, warranties or conditions, express or implied, as to the accuracy or completeness of information contained in this report.





**TICOR TITLE™**

Sentry Dynamics, Inc. and its customers make no representations, warranties or conditions, express or implied, as to the accuracy or completeness of information contained in this report.



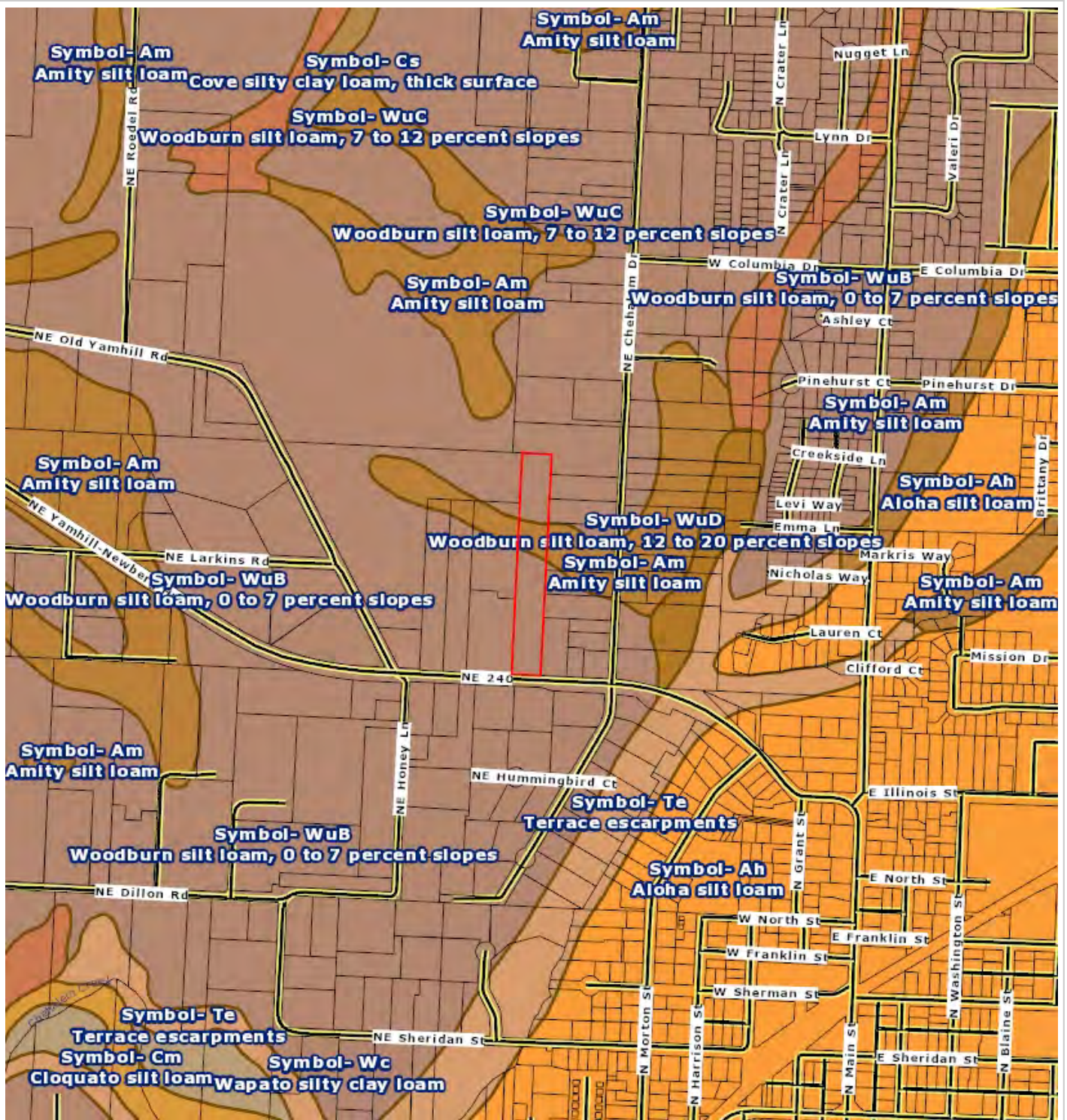

**TICOR TITLE™**

Parcel ID: 40048

Sentry Dynamics, Inc. and its customers make no representations, warranties or conditions, express or implied, as to the accuracy or completeness of information contained in this report.



**Zone-A**  
Base floodplain mapped by approximate methods; Base Flood Elevations are not determined  
Referred to A Zone or Approx A Zone  
Part of Fringe Area- 1% Annual Chance

**Zone-X**  
Minimal flood hazard above 500 yr level

**Zone-AE**  
FLOODWAY  
(stream channel & base flood passage)

**Zone-AE**  
Base floodplain where base flood elevations exist 1% Annual Chance



Sentry Dynamics, Inc. and its customers make no representations, warranties or conditions, express or implied, as to the accuracy or completeness of information contained in this report.