

MAP OF BOUNDARY SURVEY

A PARCEL OF LAND SITUATE IN SECTION 4, TOWNSHIP 3 NORTH, RANGE 25 EAST AND SECTIONS 32 AND 33, TOWNSHIP 4 NORTH, RANGE 25 EAST, NASSAU COUNTY, FLORIDA, BEING MORE PARTICULARLY DESCRIBED AS FOLLOWS:

FOR A POINT OF REFERENCE BEGIN AT THE SOUTHWEST CORNER OF SAID SECTION 33; THENCE NORTH 00°27'49" WEST, ALONG THE WEST LINE OF SAID SECTION 33, A DISTANCE OF 1,352.75 FEET TO THE SOUTHWEST CORNER OF THE NORTHEAST ONE-QUARTER (NE1/4) OF THE SOUTHWEST ONE-QUARTER (SE1/4) OF SAID SECTION 32; THENCE ALONG THE PERIMETER OF THE NORTHEAST ONE-QUARTER (NE1/4) OF SAID SECTION 32, THE FOLLOWING THREE COURSES: (1) THENCE SOUTH 89°07'35" WEST A DISTANCE OF 1,323.86 FEET; (2) THENCE NORTH 00°15'56" WEST A DISTANCE OF 1,358.46 FEET; (3) THENCE NORTH 89°19'31" EAST A DISTANCE OF 1,322.39 FEET TO THE NORTHWEST CORNER OF THE NORTHWEST ONE-QUARTER (NW1/4) OF THE SOUTHWEST ONE-QUARTER (SW1/4) OF SAID SECTION 33; THENCE NORTH 89°05'55" EAST, ALONG THE NORTH LINE OF SAID SECTION 33, A DISTANCE OF 1,345.42 FEET TO THE NORTHWEST CORNER OF THE NORTHEAST ONE-QUARTER (NE1/4) OF THE SOUTHWEST ONE-QUARTER (SW1/4) OF SAID SECTION 33; THENCE NORTH 89°05'55" EAST, ALONG THE NORTH LINE OF SAID SECTION 33, A DISTANCE OF 1,345.42 FEET TO THE NORTHWEST CORNER OF THE NORTHEAST ONE-QUARTER (NE1/4) OF THE SOUTHWEST ONE-QUARTER (SW1/4) OF SAID SECTION 33; THENCE NORTH 89°05'55" EAST, ALONG THE NORTH LINE OF SAID SECTION 33, A DISTANCE OF 1,345.42 FEET TO THE NORTHWEST CORNER OF THE NORTHEAST ONE-QUARTER (NE1/4) OF THE SOUTHWEST ONE-QUARTER (SW1/4) OF SAID SECTION 33; THENCE SOUTH 72°56'41" EAST, A DISTANCE OF 303.31 FEET TO INTERSECT THE WESTERLY RIGHT-OF-WAY LINE OF MIDDLE ROAD (ALSO KNOWN AS COUNTY ROAD 121-A) AS SHOWN ON FLORIDA DEPARTMENT OF TRANSPORTATION RIGHT-OF-WAY MAP SECTION NO. 7456-151); THENCE SOUTH 08°39'19" EAST, ALONG THE WESTERLY RIGHT-OF-WAY LINE OF SAID MIDDLE ROAD, A DISTANCE OF 2,629.13 FEET TO INTERSECT THE SOUTHERLY LINE OF SAID SECTION 33; THENCE SOUTH 88°53'42" WEST, ALONG THE SOUTHERLY LINE OF SAID SECTION 33, A DISTANCE OF 787.11 FEET TO THE NORTHEAST CORNER OF THE EAST ONE-HALF (E1/2) OF THE NORTHWEST ONE-QUARTER (NW1/4) OF THE NORTHWEST ONE-QUARTER (NW1/4) OF SAID SECTION 4; THENCE ALONG THE PERIMETER OF THE EAST ONE-HALF (E1/2) OF THE NORTHWEST ONE-QUARTER (NW1/4) OF THE NORTHWEST ONE-QUARTER (NW1/4) OF SAID SECTION 4; THE FOLLOWING THREE COURSES: (1) THENCE SOUTH 00°33'38" EAST A DISTANCE OF 1,327.94 FEET; (2) THENCE SOUTH 89°04'13" WEST A DISTANCE OF 672.23 FEET; (3) THENCE NORTH 00°38'06" WEST A DISTANCE OF 1,325.87 FEET TO INTERSECT THE SOUTHERLY LINE OF SAID SECTION 33; THENCE SOUTH 88°53'42" WEST, ALONG THE SOUTHERLY LINE OF SAID SECTION 33, A DISTANCE OF 674.81 FEET TO THE POINT OF BEGINNING.

LESS AND EXCEPT THAT PORTION OF TURKEY TOWN LANE (A 30 FOOT IN USE RIGHT-OF-WAY) RUNNING THROUGH SECTION 4, TOWNSHIP 3 NORTH, RANGE 25 EAST, NASSAU COUNTY, FLORIDA.

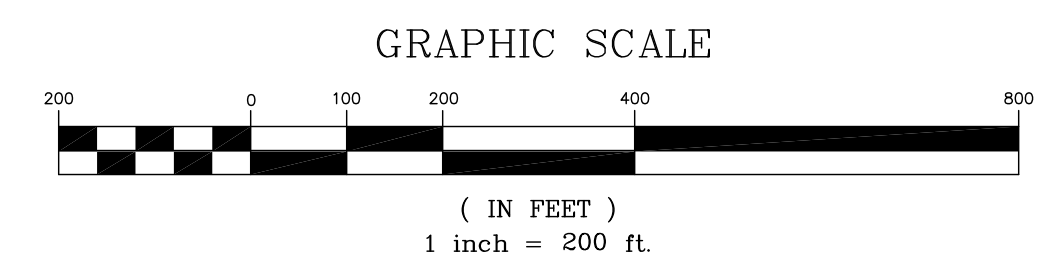
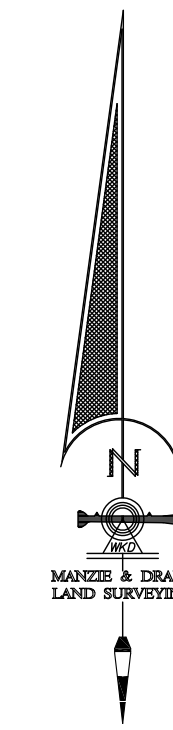

CERTIFIED TO:
RAYDIENT LLC DBA RAYDIENT PLACES + PROPERTIES LLC, A DELAWARE LIMITED LIABILITY COMPANY.

SURVEY NOTES:

- 1.) REPRODUCTIONS OF THIS SKETCH ARE NOT VALID UNLESS SEALED WITH AN EMBOSSED SURVEYOR'S SEAL.
- 2.) THE "LEGAL DESCRIPTION" HEREON WAS PREPARED BY THE SURVEYOR.
- 3.) UNDERGROUND IMPROVEMENTS NOT LOCATED OR SHOWN.
- 4.) LANDS SHOWN HEREON WERE NOT ABSTRACTED BY THIS OFFICE FOR EASEMENTS, RIGHTS-OF-WAY, OWNERSHIP OR OTHER INSTRUMENTS OF RECORD.
- 5.) BEARINGS AND HORIZONTAL CONTROL DATA (STATE PLANE COORDINATES) SHOWN HEREON ARE BASED ON STATE PLANE COORDINATE SYSTEM (FLORIDA EAST ZONE) NORTH AMERICAN DATUM OF 1983/1990 (NAD 83/90), AND WERE OBTAINED BY UTILIZING A "CARLSON BRX5 GPS/GNSS ROVER" AND THE "TRIMBLE VRS" REAL TIME KINEMATICS STATE-WIDE GPS NETWORK. THE SOUTH LINE OF SECTION 33, TOWNSHIP 4 NORTH, RANGE 25 EAST, BEARS SOUTH 88°53'42" WEST.
- 6.) FENCE OWNERSHIP HAS NOT BEEN DETERMINED BY THIS OFFICE.
- 7.) THE WETLANDS AS SHOWN HEREON ARE PER CARTER ENVIRONMENTAL SERVICES, INC.
- 8.) "UNLESS IT BEARS THE SIGNATURE AND THE ORIGINAL RAISED SEAL OF A FLORIDA LICENSED SURVEYOR AND MAPPER, THIS MAP/REPORT IS FOR INFORMATIONAL PURPOSES ONLY AND IS NOT VALID."
- 9.) THIS FIRM'S "CERTIFICATE OF AUTHORIZATION" NUMBER IS "LB 7039".
- 10.) THE PROPERTY SHOWN HEREON LIES WITHIN FLOOD ZONES "A" & "X" PER THE FEDERAL EMERGENCY MANAGEMENT AGENCY (FEMA) FLOOD INSURANCE RATE MAP (FIRM) PANEL 12089C-0170-F, DATED 12/17/2010.
- 11.) THE UNADJUSTED ERROR OF CLOSURE FOR THIS SURVEY, BASED ON CLOSED TRAVERSE, EXCEEDS 1:50,000.

THE INFORMATION SHOWN HEREON MEETS THE STANDARDS OF PRACTICE SET FORTH BY THE FLORIDA BOARD OF PROFESSIONAL SURVEYORS AND MAPPERS AND THE FLORIDA ADMINISTRATIVE CODE PURSUANT TO SECTION 472.027, FLORIDA STATUTES.

MANZIE & DRAKE LAND SURVEYING
117 South Ninth Street, Fernandina Beach, FL 32034
(904) 491-5700 FAX (904) 491-5777
Certificate of Authorization Number "LB 7039"
"OUR SIGHTS ARE ON THE FUTURE, SET YOUR SITES ON US."

SCALE: 1"=200' JOB NO: 19542 DATE: 5/6/16 CADD: WKO
F.B. NO: X-297 PAGE NO: 7 FIELD CREW: GS FILE NO: C-729



REVISIONS:

1. REVISED ON 09/20/2016 TO SHOW WETLAND INFORMATION PROVIDED BY CARTER ENVIRONMENTAL SOLUTIONS, INC. (WKD)
2. REVISED ON 09/06/2017 TO SHOW BOUNDARY INFORMATION FOR PROPOSED PARCELS "A" THROUGH "I". (WKD)
3. REVISED ON 10/27/2017 TO SHOW NEW CERTIFICATIONS. (WKD)
4. REVISED ON 11/13/2017 TO SHOW UPDATED BOUNDARY INFORMATION FOR PROPOSED PARCELS "A" THROUGH "I". (WKD)

P.I.N. = 04-3N-25-0000-0003-0030 O.R.B. 1347, PAGE 61
P.I.N. = 04-3N-25-0000-0002-0000 O.R.B. 1872, PAGE 920