

ROBERT F. NORMAN, INC.

Forestry Service

26107 The Trail

Mattaponi, Virginia 23110

Phone: (804) 785-5132

Fax: (804) 785-2426

Jan. 8, 2020

Mr. Carden:

Enclosed is a timber cruise and appraisal on Wiggington Tract in Westmoreland County, on Rt.612, being 66½ acres.

Trees were counted as sawtimber if as large or larger than the following minimum size: Pine 10 inches in diameter at breast height and Hardwood 12 inches in diameter at breast height. Pine smaller than sawtimber was counted as pulpwood. Sawtimber is on the International Log Rule and pulpwood is the standard cord of 128 cubic feet. The volume is calculated from sample points and are subject to variation from the exact volume.

| PINE | | WIGGINGTON TRACT #1 | R. OAK |
|---------|-------------|---------------------|----------------|
| 10" DBH | 26,334 | | 12" DBH 3,216 |
| 12" DBH | 73,836 | | 14" DBH 13,806 |
| 14" DBH | 122,160 | | 16" DBH 11,286 |
| 16" DBH | 129,018 | | 18" DBH 28,956 |
| 18" DBH | 98,844 | | 20" DBH 16,908 |
| 20" DBH | 74,406 | | 22" DBH 26,880 |
| 22" DBH | 34,824 | | 24" DBH 21,264 |
| 24" DBH | 13,902 | | 26" DBH 17,112 |
| | | | 28" DBH 16,026 |
| | | | 30" DBH 4,062 |
| | 573,324 FT. | | |
| HWD | | TOTAL | W. OAK |
| 12" DBH | 28,468 | | |
| 14" DBH | 30,762 | | |
| 16" DBH | 27,408 | | |
| 18" DBH | 21,480 | | |
| 20" DBH | 5,562 | | |
| 22" DBH | 8,124 | | |
| | | 866,098 FT. | |
| | 121,804 FT. | | |
| | | | POPLAR |
| | | | 8,238 FT |

PINE PULP-224 CD

HWD. PULP-301 CD

Robert F. Norman

ROBERT F. NORMAN, INC.

Forestry Service

26107 The Trail

Mattaponi, Virginia 23110

Phone: (804) 785-5132

Fax: (804) 785-2426

Jan. 8, 2020

TIMBER APPRAISAL

WESTMORELAND COUNTY

WIGGINGTON TRACT

| | | | | | | |
|-----------|-------------|---|----------|-----|---|--------------|
| PINE | 573,324 FT. | @ | \$140.00 | PER | M | \$80,265.36 |
| POPLAR | 8,238 FT. | @ | \$200.00 | PER | M | 1,647.60 |
| R. OAK | 159,516 FT. | @ | \$225.00 | PER | M | 35,891.10 |
| W. OAK | 3,216 FT. | @ | \$250.00 | PER | M | 804.00 |
| HWD. | 121,804 FT. | @ | \$130.00 | PER | M | 15,834.52 |
| PINE PULP | 224 CD. | @ | \$20.00 | PER | C | 4,480.00 |
| HWD. PULP | 301 CD. | @ | \$5.00 | PER | C | 1,505.00 |
| TOTAL | | | | | | \$140,427.58 |

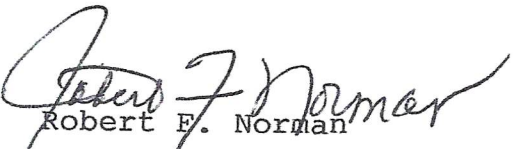
Robert F. Norman



ROBERT F. NORMAN, INC.

Forestry Service

26107 The Trail

Mattaponi, Virginia 23110

Phone: (804) 785-5132

Fax: (804) 785-2426

JAN 8, 2020

Wiggington Tract #1

66 1/2 AC ±

Westmoreland Co.

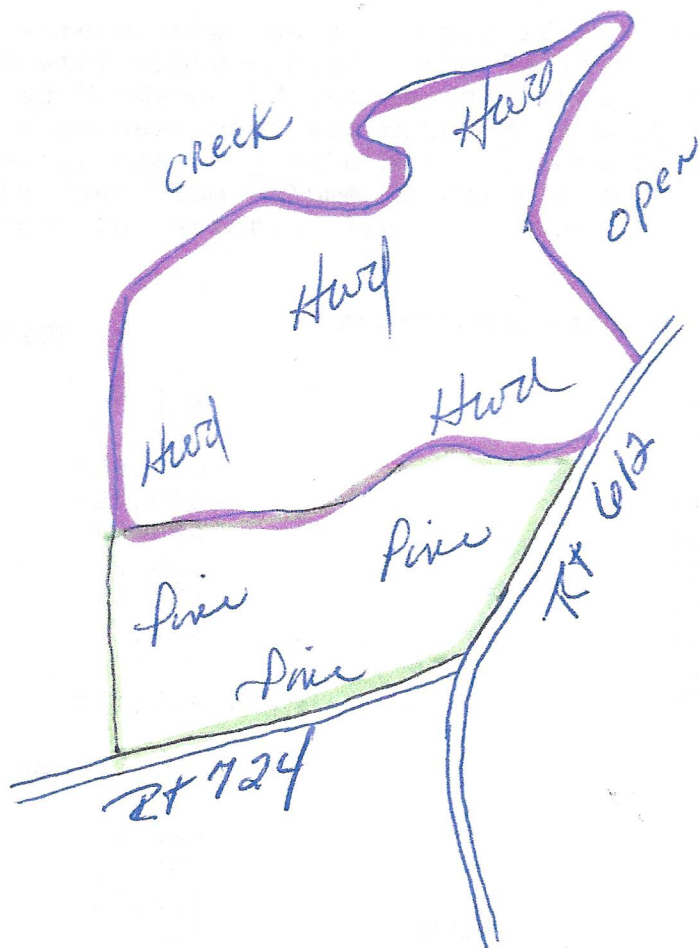

SCALE
1" = 660'