

# Soils Map

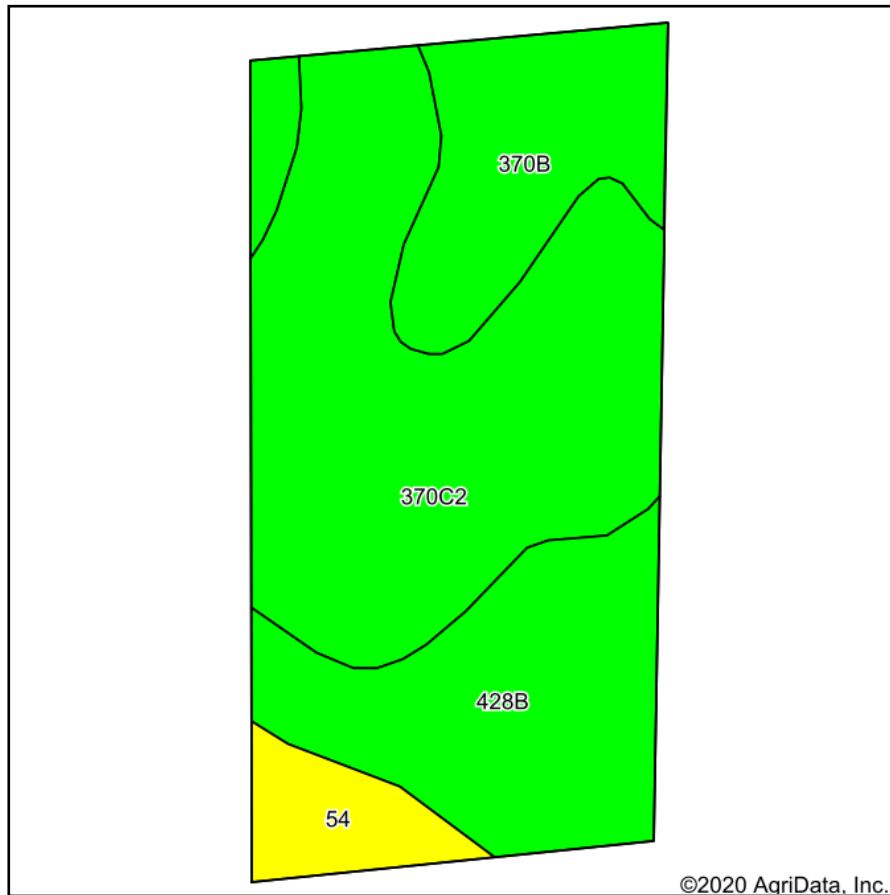

Soils data provided by USDA and NRCS.

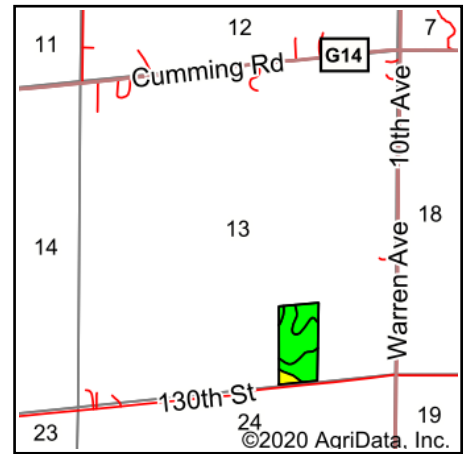

State: **Iowa**  
 County: **Madison**  
 Location: **13-77N-26W**  
 Township: **Lee**  
 Acres: **18.35**  
 Date: **11/4/2020**



Maps Provided By:



Area Symbol: IA121. Soil Area Version: 24							
Code	Soil Description	Acres	Percent of field	CSR2 Legend	Non-Irr Class *c	CSR2**	*n NCCPI Overall
370C2	Sharpsburg silty clay loam, 5 to 9 percent slopes, eroded	9.05	49.3%		IIIe	80	84
428B	Ely silty clay loam, dissected till plain, 2 to 5 percent slopes	5.05	27.5%		Ile	88	95
370B	Sharpsburg silty clay loam, 2 to 5 percent slopes	3.09	16.8%		Ile	91	93
54	Zook silty clay loam, 0 to 2 percent slopes, occasionally flooded	1.16	6.3%		IIlw	67	63
Weighted Average						83.2	*n 87.2

\*\*IA has updated the CSR values for each county to CSR2.

\*n: The aggregation method is "Weighted Average using all components"

\*c: Using Capabilities Class Dominant Condition Aggregation Method

Soils data provided by USDA and NRCS.