

Soils Map

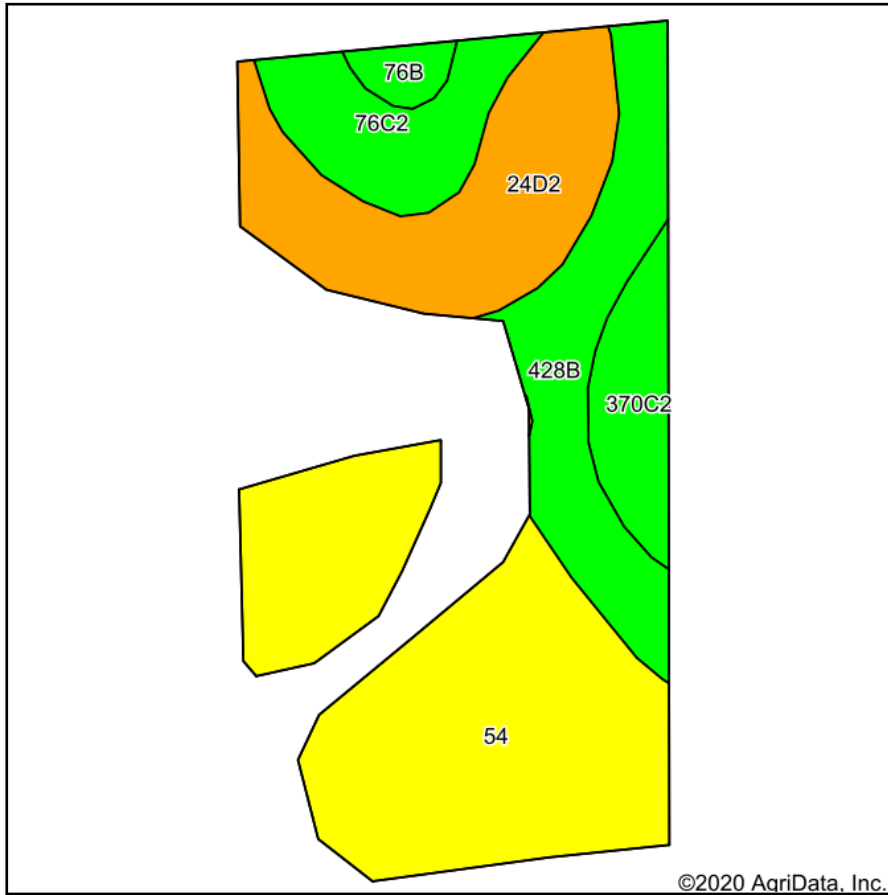

Soils data provided by USDA and NRCS.

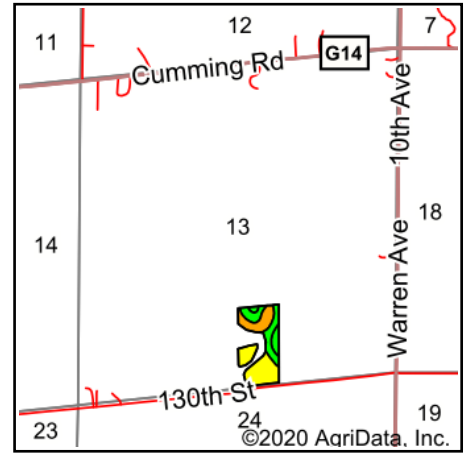

State: **Iowa**
 County: **Madison**
 Location: **13-77N-26W**
 Township: **Lee**
 Acres: **14.77**
 Date: **11/4/2020**



Maps Provided By:

 CUSTOMIZED ONLINE MAPPING
 © AgriData, Inc. 2020 www.AgriDataInc.com



Area Symbol: JA121. Soil Area Version: 24

Code	Soil Description	Acres	Percent of field	CSR2 Legend	Non-Irr Class *c	CSR2**	*n NCCPI Overall
54	Zook silty clay loam, 0 to 2 percent slopes, occasionally flooded	6.43	43.5%		IIw	67	63
24D2	Shelby clay loam, dissected till plain, 9 to 14 percent slopes, eroded	3.11	21.1%		IIIe	49	75
428B	Ely silty clay loam, dissected till plain, 2 to 5 percent slopes	2.46	16.7%		Ile	88	95
76C2	Ladoga silt loam, dissected till plain, 5 to 9 percent slopes, eroded	1.45	9.8%		IIIe	75	78
370C2	Sharpsburg silty clay loam, 5 to 9 percent slopes, eroded	1.04	7.0%		IIIe	80	84
76B	Ladoga silt loam, 2 to 5 percent slopes	0.28	1.9%		Ile	86	85
Weighted Average						68.8	*n 74.2

**IA has updated the CSR values for each county to CSR2.

*n: The aggregation method is "Weighted Average using all components"

*c: Using Capabilities Class Dominant Condition Aggregation Method

Soils data provided by USDA and NRCS.