

# MCGEE BRANCH HUNTING

*BRONSON, FL | LEVY COUNTY*

264.5 ± ACRES





## SPECIFICATIONS & FEATURES

**Acreage:** 264.5 ± acres

**Sale Price:** \$634,800

**Price per Acre:** \$2,400

**Site Address:** NE SR 24, Bronson, FL 32621

**County:** Levy

**Species:** Slash pine, mixed hardwoods, and cypress

**Roads:** Access from SR 24 and OI Road #2, with an interior network of logging roads

**Road Frontage:** 3,000 FT ± along SR 24

**Predominant Soil Types:** Myakka, Smyrna, and Pomona sands

**Uplands/Wetlands:** 84% uplands

**Utilities:** None; electric available along SR 24

**Game Populations:** Good deer and turkey population with some hogs, and decent small game

**Zoning/FLU:** Forestry/Rural Residential (1 d.u./20 AC)

**Taxes:** Taxed as part of a larger parcel (613 acres) in 2019 at the rate of \$2.66 per acre.

Parcel 0252700000 was taxed as 548 AC and \$1,378 in 2019.

**Infrastructure:** Interior logging roads provide management access

**Land Cover:** Planted pine, natural hardwoods

**Age & Stages of Timber:** 2018 Slash - 20 ± AC; 2013 Slash - 132 ± AC; 2009 Slash - 39 ± AC; 2003 Slash - 13 ± AC

**Current Management Information:** Managed as part of a larger timberland investment

**Potential Use:** Hunting, horseback riding, ATV riding, hunting camp, weekend getaway, homesite(s), paintball, livestock grazing, or a game farm

**Income Features:** Some merchantable (2003) pine plantation acreage, with much more planted pine for future harvest.

McGee Branch Hunting features a variety of planted slash pine stands to provide current or future income from timber harvest and pine straw raking (with some stand cleanup required). Over 84% uplands, this property is an excellent hunting tract and could provide additional income from a hunting lease.

McGee Branch Hunting has significant paved road access and a network of interior management roads lending easy access to cities like Gainesville and Ocala. For additional hunting exposure, the Devil's Hammock/Upper Waccasassa Conservation Area is across SR 24. A portion of the old Jacksonville to Cedar Key Railroad traverses the property adding a unique feature for the history buff. Other recreational opportunities like boating and fishing have a short drive to Cedar Key and The Gulf of Mexico.





## LOCATION & DRIVING DIRECTIONS

**Parcel IDs:** All of 0251600000 and Portion of 0252700000 lying north and east of OI Road #2

**GPS Location:** 29.356247, -82.727456

### Driving Directions:

**From US 19/98 & SR 24 Intersection in Otter Creek, FL:**

- Proceed NE on SR 24 for 2.9 miles to OI Road #2 on the right (south).
- Tract lies on the south side of SR 24 and NE of OI Road #2.

**From US 27 Alt & SR 24 Intersection in Bronson, FL:**

- Go SW on SR 24 for 8.3 miles to OI Road #2.

**Showing Instructions:** Contact the listing advisor, Greg Driskell (386.867.2736), to learn more or schedule a showing time.

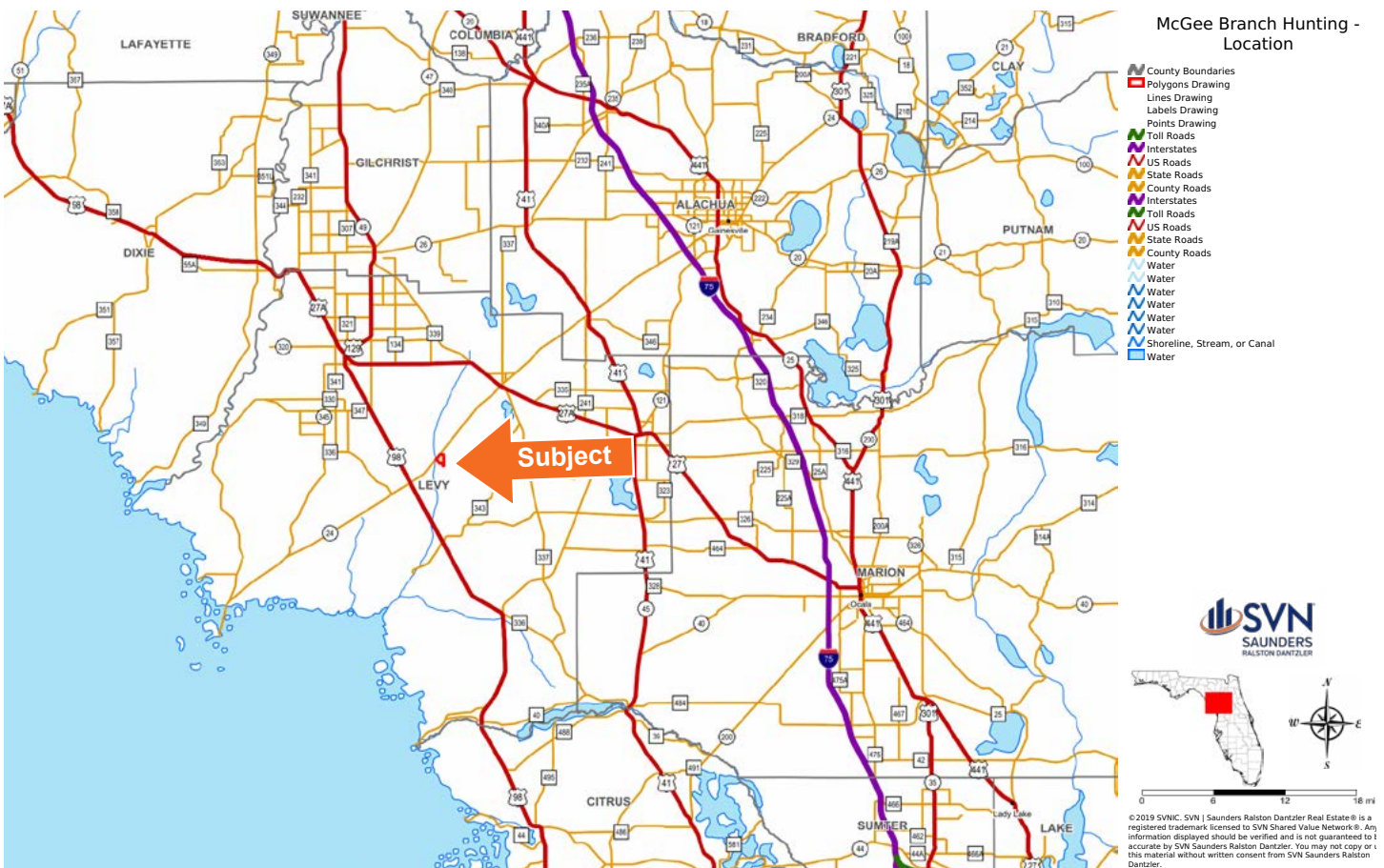



114 N. Tennessee Ave.  
3rd Floor  
Lakeland, FL 33801

#### 264.5 ± Acres • Timberlands

Variety of planted slash pine stands • Great site for hunting area or rural estate  
Cedar Key and The Gulf of Mexico are only a short ride away

## Visit [SVNsaunders.com](http://SVNsaunders.com) & Search For: McGee Branch

Greg Driskell 386.867.2736 | [greg.driskell@svn.com](mailto:greg.driskell@svn.com)



**LAKELAND OFFICE:**  
114 N Tennessee Ave. 3rd Floor  
Lakeland, FL 33801  
863.648.1528 - Main Office

**LAKE CITY OFFICE:**  
356 NW Lake City Avenue  
Lake City, FL 32055  
386.438.5896

©2020 SVN | Saunders Ralston Dantzler Real Estate. All SVN® Offices Independently Owned and Operated  
SVN | Saunders Ralston Dantzler Real Estate is regarded as an authority on all types of Florida land  
and conservation easements, transacting over \$2.9 billion in sales since 1996. Offering land, forestry,  
and conservation easement real estate services through Saunders Ralston Dantzler Real Estate and  
the Saunders Real Estate Forestry Group, the Saunders team of land professionals offers advisory and  
transactional services through their home office in Lakeland, FL, the North Florida office in Lake City,  
FL, and the South Georgia office in Thomasville, GA. We provide services to land and commercial clients  
through our commercial real estate brokerage, Saunders Ralston Dantzler Real Estate.



062520-A