

Soils Map

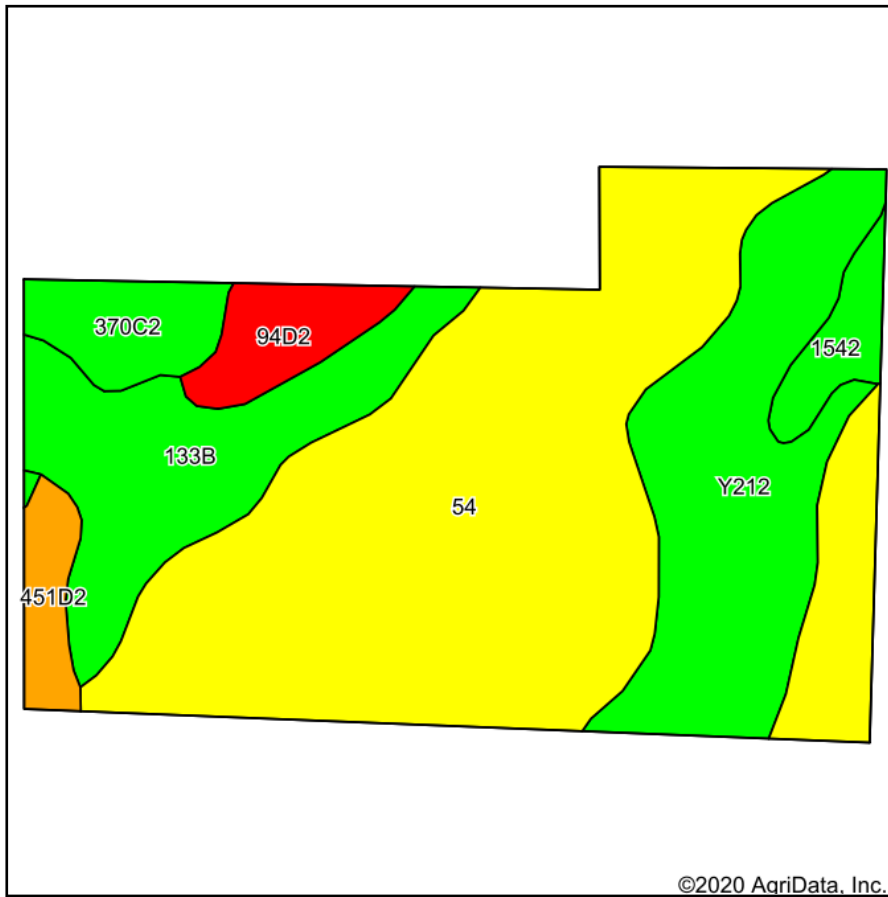

Soils data provided by USDA and NRCS.

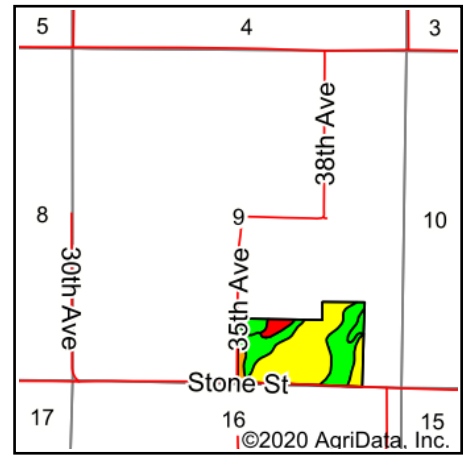

State: **Iowa**
 County: **Warren**
 Location: **9-74N-25W**
 Township: **Virginia**
 Acres: **51.86**
 Date: **12/10/2020**



Maps Provided By:



Code	Soil Description	Acres	Percent of field	CSR2 Legend	Non-Irr Class *c	CSR2**	CSR	*n NCCPI Overall	*n NCCPI Corn	*n NCCPI Small Grains	*n NCCPI Soybeans
54	Zook silty clay loam, 0 to 2 percent slopes, occasionally flooded	27.16	52.4%		IIw	67	70	63	58	30	63
Y212	Kennebec silt loam, 0 to 2 percent slopes, occasionally flooded	10.30	19.9%		Iw	91		95	95	65	93
133B	Colo silty clay loam, dissected till plain, 2 to 5 percent slopes, occasionally flooded	7.33	14.1%		IIw	74	75	83	80	38	82
370C2	Sharpsburg silty clay loam, 5 to 9 percent slopes, eroded	2.26	4.4%		IIIe	80	67	84	84	69	67
94D2	Mystic-Caleb complex, 9 to 14 percent slopes, moderately eroded	2.00	3.9%		IVe	25	25	71	71	49	50
1542	Quiver-Colo silty clay loams, 0 to 2 percent slopes, occasionally flooded	1.42	2.7%		IIw	76		84	72	38	82
451D2	Caleb loam, 9 to 14 percent slopes, moderately eroded	1.39	2.7%		IVe	47	38	80	80	57	61
Weighted Average						71.4	*-	*n 74.4	*n 71.1	*n 41.5	*n 71.8

**IA has updated the CSR values for each county to CSR2.

*- CSR weighted average cannot be calculated on the current soils data, use prior data version for csr values.

*n: The aggregation method is "Weighted Average using all components"

*c: Using Capabilities Class Dominant Condition Aggregation Method

Soils data provided by USDA and NRCS.