

Tillable Soils Map

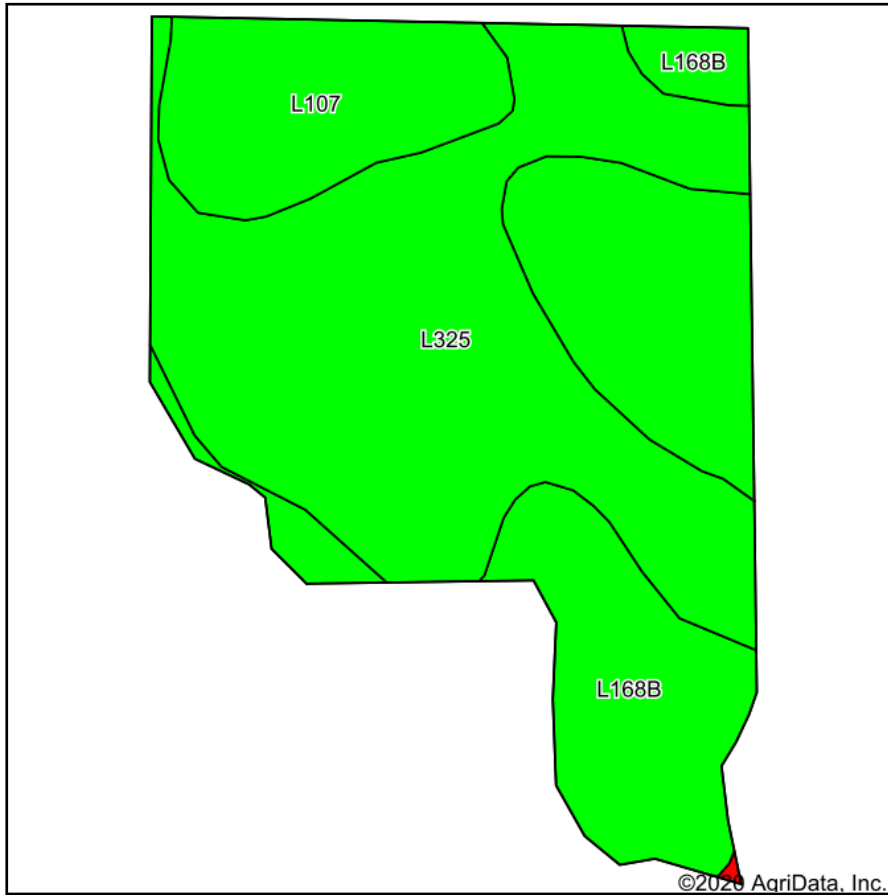

Soils data provided by USDA and NRCS.

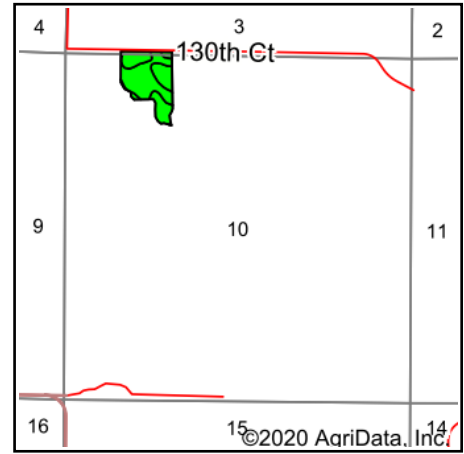

State: **Iowa**
 County: **Dallas**
 Location: **10-81N-26W**
 Township: **Des Moines**
 Acres: **14.54**
 Date: **12/14/2020**



Maps Provided By:



Code	Soil Description	Acres	Percent of field	CSR2 Legend	Non-Irr Class *c	*i Corn	*i Soybeans	CSR2**	CSR	*n NCCPI Overall
L325	Le Sueur loam, Bemis moraine, 1 to 3 percent slopes	7.35	50.6%		le	0	0	78		92
L168B	Hayden loam, Bemis moraine, 2 to 6 percent slopes	5.08	34.9%		lle	0	0	76		86
L107	Webster clay loam, Bemis moraine, 0 to 2 percent slopes	2.11	14.5%		llw	0	0	88		84
Weighted Average						*-	*-	78.8	*-	*n 88.7

**IA has updated the CSR values for each county to CSR2.

*- CSR weighted average cannot be calculated on the current soils data, use prior data version for csr values.

*i Yield data provided by the ISPAID Database version 8.1.1 developed by IA State University.

*n: The aggregation method is "Weighted Average using all components"

*c: Using Capabilities Class Dominant Condition Aggregation Method

Soils data provided by USDA and NRCS.