

Four Mile Farm 500 +/- acres \$ 2,895,000

Shelby County

Four Mile Farm - 500 acres of beautiful pasture and timber land. A short drive down HWY 280 from Birmingham, This farm and recreational paradise is a rare offering and a special piece of Shelby County, Alabama.

Beautiful pasture for horses or cattle, miles of roads and trails for riding, diverse habitat supporting healthy populations of deer, turkey, dove, duck, and other wildlife.

- ▶ **Less than 1 hour from Birmingham, 1 hour from Montgomery**
- ▶ **130+/- acres of open ground, including pasture (fenced and cross fenced), quail courses, and a dove field**
- ▶ **300+ acres of Timber, predominantly mature hardwood**
- ▶ **5+ acre bass lake**
- ▶ **Three Duck Ponds with water control**
- ▶ **Three Residences**
 - ▶ **Main house (3 bedroom, in-ground pool, rock fireplace)**
 - ▶ **Hunting Cabin**
 - ▶ **Guest House**
- ▶ **Almost 1.5 miles of frontage on Four Mile Creek**

Contact: **Chas Pell**
 cpell@blackridgeland.com
 205.919.6504 (mobile)



TEL 205/322/2647
FAX 205/322/8563
EML info@blackridgeland.com

www.BLACKRIDGELAND.com

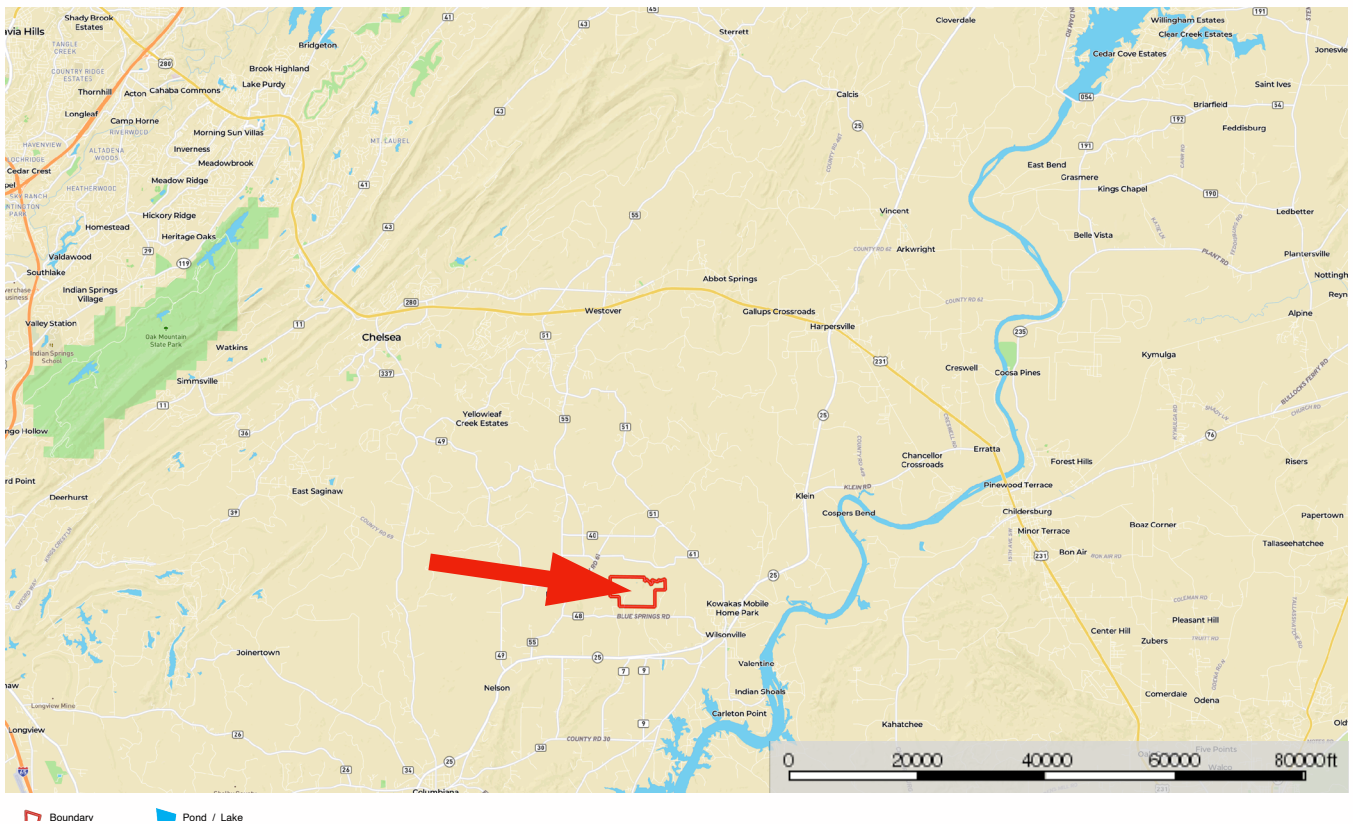

BOUNDARIES AND ACREAGES ARE APPROXIMATE