

# EAST ABERDEEN LAKE SOUTH

440.85 +/- acres  
Monroe County, MS



**Sartain's Heritage**  
Properties, LLC.  
[www.sartainsheritage.com](http://www.sartainsheritage.com)

**"Guiding Your Land Decisions for Over 60 Years"**

FARM | TIMBER | HUNTING

**J Parker Sartain 601.506.2398 cell**  
[psartain@sartainsheritage.com](mailto:psartain@sartainsheritage.com)

601-856-2720

All information contained herein is supplied by sources deemed reliable, but is not guaranteed by Sartain's Heritage Properties, its Brokers or Agents. Properties are subject to errors, omissions, correction, price change, prior sale or withdrawal without notice.



440.85 acres in S2, T14S, R19W and S35, T13S, R19W, Monroe County, MS fronting Acker Road.

The timber consists of approximately 69 acres of nine year pine plantation, 140 acres of 18 and 19 year pine plantation and 188 acres of Hardwood Streamside Management Zones the bulk being along Halfway Creek creating a great wildlife travel corridor across the property.

Located just east of Aberdeen Lake, one mile west of the Monroe County Airport and only minutes from the town of Aberdeen make this a very accessible property for deer, duck and turkey hunting.

\$2150 per acre/\$947,817.40

Contact: J. Parker Sartain 601.506.2398

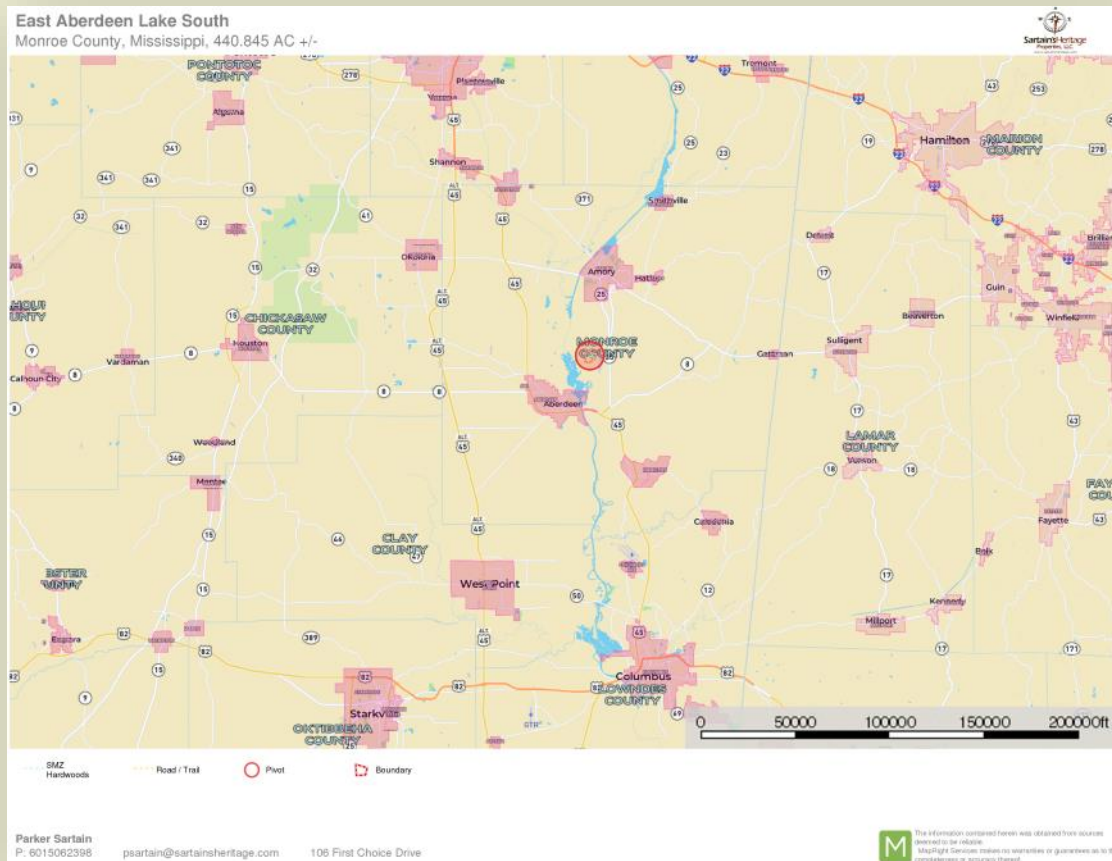

**Sartain's Heritage**  
Properties, LLC.  
www.sartainsheritage.com

**"Guiding Your Land Decisions for Over 60 Years"**  
FARM | TIMBER | HUNTING

**J Parker Sartain 601.506.2398 cell**  
**psartain@sartainsheritage.com**

**601-856-2720**

All information contained herein is supplied by sources deemed reliable, but is not guaranteed by Sartain's Heritage Properties, its Brokers or Agents. Properties are subject to errors, omissions, correction, price change, prior sale or withdrawal without notice.