

SELLER'S DISCLOSURE NOTICE

©Texas Association of REALTORS®, Inc. 2019

Section 5.008, Property Code requires a seller of residential property of not more than one dwelling unit to deliver a Seller's Disclosure Notice to a buyer on or before the effective date of a contract. This form complies with and contains additional disclosures which exceed the minimum disclosures required by the Code.

CONCERNING THE PROPERTY AT

1064 Live Oak Lane
Weimar, Tex 78962

THIS NOTICE IS A DISCLOSURE OF SELLER'S KNOWLEDGE OF THE CONDITION OF THE PROPERTY AS OF THE DATE SIGNED BY SELLER AND IS NOT A SUBSTITUTE FOR ANY INSPECTIONS OR WARRANTIES THE BUYER MAY WISH TO OBTAIN. IT IS NOT A WARRANTY OF ANY KIND BY SELLER, SELLER'S AGENTS, OR ANY OTHER AGENT.

Seller ___ is ___ is not occupying the Property. If unoccupied (by Seller), how long since Seller has occupied the Property? ___ (approximate date) or ___ never occupied the Property

Section 1. The Property has the items marked below: (Mark Yes (Y), No (N), or Unknown (U).)

This notice does not establish the items to be conveyed. The contract will determine which items will & will not convey.

Item	Y	N	U
Cable TV Wiring	✓		
Carbon Monoxide Det.		✓	
Ceiling Fans	✓		
Cooktop		✓	
Dishwasher	✓		
Disposal	✓		
Emergency Escape Ladder(s)		✓	
Exhaust Fans	✓		
Fences	✓		
Fire Detection Equip.	✓		
French Drain		✓	
Gas Fixtures		✓	
Natural Gas Lines		✓	

Item	Y	N	U
Liquid Propane Gas:	✓		
-LP Community (Captive)		✓	
-LP on Property	✓		
Hot Tub		✓	
Intercom System		✓	
Microwave	✓		
Outdoor Grill	✓		
Patio/Decking	✓		
Plumbing System	✓		
Pool		✓	
Pool Equipment		✓	
Pool Maint. Accessories		✓	
Pool Heater		✓	

Item	Y	N	U
Pump: sump grinder		✓	
Rain Gutters		✓	
Range/Stove	✓		
Roof/Attic Vents	✓		
Sauna		✓	
Smoke Detector	✓		
Smoke Detector - Hearing Impaired		✓	
Spa		✓	
Trash Compactor		✓	
TV Antenna		✓	
Washer/Dryer Hookup	✓		
Window Screens	✓		
Public Sewer System		✓	

Item	Y	N	U	Additional Information
Central A/C	✓			✓ electric gas number of units: 2
Evaporative Coolers		✓		number of units:
Wall/Window AC Units		✓		number of units:
Attic Fan(s)		✓		if yes, describe:
Central Heat	✓			electric ✓ gas number of units: 2
Other Heat		✓		if yes, describe:
Oven		✓		number of ovens: electric gas other:
Fireplace & Chimney	✓			wood gas logs mock other:
Carport	✓			attached not attached
Garage	✓			attached not attached
Garage Door Openers	✓			number of units: number of remotes:
Satellite Dish & Controls	✓			✓ owned leased from:
Security System WIRED			✓	owned leased from:
Solar Panels		✓		owned leased from:
Water Heater 2	✓			✓ electric ✓ gas other: number of units: 2
Water Softener	✓			✓ owned leased from:
Other Leased Items(s)		✓		if yes, describe:

(TXR-1406) 09-01-19

Initialed by: Buyer:  and Seller:  7B

Page 1 of 6

Concerning the Property at _____

Underground Lawn Sprinkler	<input checked="" type="checkbox"/>	<input type="checkbox"/>	<input checked="" type="checkbox"/> automatic <input type="checkbox"/> manual	areas covered:
Septic / On-Site Sewer Facility	<input checked="" type="checkbox"/>	<input type="checkbox"/>	if yes, attach Information About On-Site Sewer Facility (TXR-1407)	

Water supply provided by: ☒ city ☒ well ☐ MUD ☐ co-op ☐ unknown ☐ other: _____

Was the Property built before 1978? ☐ yes ☒ no ☐ unknown

(If yes, complete, sign, and attach TXR-1906 concerning lead-based paint hazards).

Roof Type: SHINGLES (Architectural) Age: 13 (25 year Warranty) (approximate)

Is there an overlay roof covering on the Property (shingles or roof covering placed over existing shingles or roof covering)? ☐ yes ☒ no ☐ unknown

Are you (Seller) aware of any of the items listed in this Section 1 that are not in working condition, that have defects, or are need of repair? ☐ yes ☐ no If yes, describe (attach additional sheets if necessary): _____

Section 2. Are you (Seller) aware of any defects or malfunctions in any of the following? (Mark Yes (Y) if you are aware and No (N) if you are not aware.)

Item	Y	N
Basement	<input type="checkbox"/>	<input checked="" type="checkbox"/>
Ceilings	<input type="checkbox"/>	<input checked="" type="checkbox"/>
Doors	<input type="checkbox"/>	<input checked="" type="checkbox"/>
Driveways	<input type="checkbox"/>	<input checked="" type="checkbox"/>
Electrical Systems	<input type="checkbox"/>	<input checked="" type="checkbox"/>
Exterior Walls	<input type="checkbox"/>	<input checked="" type="checkbox"/>

Item	Y	N
Floors	<input checked="" type="checkbox"/>	<input type="checkbox"/>
Foundation / Slab(s)	<input type="checkbox"/>	<input checked="" type="checkbox"/>
Interior Walls	<input type="checkbox"/>	<input checked="" type="checkbox"/>
Lighting Fixtures	<input type="checkbox"/>	<input checked="" type="checkbox"/>
Plumbing Systems	<input type="checkbox"/>	<input checked="" type="checkbox"/>
Roof	<input type="checkbox"/>	<input checked="" type="checkbox"/>

Item	Y	N
Sidewalks	<input type="checkbox"/>	<input checked="" type="checkbox"/>
Walls / Fences	<input type="checkbox"/>	<input checked="" type="checkbox"/>
Windows	<input type="checkbox"/>	<input checked="" type="checkbox"/>
Other Structural Components	<input type="checkbox"/>	<input checked="" type="checkbox"/>

If the answer to any of the items in Section 2 is yes, explain (attach additional sheets if necessary): _____

Section 3. Are you (Seller) aware of any of the following conditions? (Mark Yes (Y) if you are aware and No (N) if you are not aware.)

Condition	Y	N
Aluminum Wiring	<input type="checkbox"/>	<input checked="" type="checkbox"/>
Asbestos Components	<input type="checkbox"/>	<input checked="" type="checkbox"/>
Diseased Trees: <u>oak wilt</u>	<input type="checkbox"/>	<input checked="" type="checkbox"/>
Endangered Species/Habitat on Property	<input type="checkbox"/>	<input checked="" type="checkbox"/>
Fault Lines	<input type="checkbox"/>	<input checked="" type="checkbox"/>
Hazardous or Toxic Waste	<input type="checkbox"/>	<input checked="" type="checkbox"/>
Improper Drainage	<input type="checkbox"/>	<input checked="" type="checkbox"/>
Intermittent or Weather Springs	<input type="checkbox"/>	<input checked="" type="checkbox"/>
Landfill	<input type="checkbox"/>	<input checked="" type="checkbox"/>
Lead-Based Paint or Lead-Based Pt. Hazards	<input type="checkbox"/>	<input checked="" type="checkbox"/>
Encroachments onto the Property	<input type="checkbox"/>	<input checked="" type="checkbox"/>
Improvements encroaching on others' property	<input type="checkbox"/>	<input checked="" type="checkbox"/>
Located in Historic District	<input type="checkbox"/>	<input checked="" type="checkbox"/>
Historic Property Designation	<input type="checkbox"/>	<input checked="" type="checkbox"/>
Previous Foundation Repairs	<input type="checkbox"/>	<input checked="" type="checkbox"/>
Previous Roof Repairs	<input type="checkbox"/>	<input checked="" type="checkbox"/>
Previous Other Structural Repairs	<input type="checkbox"/>	<input checked="" type="checkbox"/>
Previous Use of Premises for Manufacture of Methamphetamine	<input type="checkbox"/>	<input checked="" type="checkbox"/>

Condition	Y	N
Radon Gas	<input type="checkbox"/>	<input checked="" type="checkbox"/>
Settling	<input checked="" type="checkbox"/>	<input type="checkbox"/>
Soil Movement	<input type="checkbox"/>	<input checked="" type="checkbox"/>
Subsurface Structure or Pits	<input type="checkbox"/>	<input checked="" type="checkbox"/>
Underground Storage Tanks	<input type="checkbox"/>	<input checked="" type="checkbox"/>
Unplatted Easements	<input type="checkbox"/>	<input checked="" type="checkbox"/>
Unrecorded Easements	<input type="checkbox"/>	<input checked="" type="checkbox"/>
Urea-formaldehyde Insulation	<input type="checkbox"/>	<input checked="" type="checkbox"/>
Water Damage Not Due to a Flood Event	<input type="checkbox"/>	<input checked="" type="checkbox"/>
Wetlands on Property	<input type="checkbox"/>	<input checked="" type="checkbox"/>
Wood Rot	<input type="checkbox"/>	<input checked="" type="checkbox"/>
Active infestation of termites or other wood destroying insects (WDI)	<input type="checkbox"/>	<input checked="" type="checkbox"/>
Previous treatment for termites or WDI	<input checked="" type="checkbox"/>	<input type="checkbox"/>
Previous termite or WDI damage repaired	<input type="checkbox"/>	<input checked="" type="checkbox"/>
Previous Fires	<input type="checkbox"/>	<input checked="" type="checkbox"/>
Termite or WDI damage needing repair	<input type="checkbox"/>	<input checked="" type="checkbox"/>
Single Blockable Main Drain in Pool/Hot Tub/Spa*	<input type="checkbox"/>	<input checked="" type="checkbox"/>

Concerning the Property at _____

If the answer to any of the items in Section 3 is yes, explain (attach additional sheets if necessary): _____

Settling of concrete

Property Treated for Termites (Preventive)

*A single blockable main drain may cause a suction entrapment hazard for an individual.

Section 4. Are you (Seller) aware of any item, equipment, or system in or on the Property that is in need of repair, which has not been previously disclosed in this notice? yes ☒ no ☐ If yes, explain (attach additional sheets if necessary): _____

Section 5. Are you (Seller) aware of any of the following conditions?* (Mark Yes (Y) if you are aware and check wholly or partly as applicable. Mark No (N) if you are not aware.)

Y N

- ☒ Present flood insurance coverage (if yes, attach TXR 1414).
- ☒ Previous flooding due to a failure or breach of a reservoir or a controlled or emergency release of water from a reservoir.
- ☒ Previous flooding due to a natural flood event (if yes, attach TXR 1414).
- ☒ Previous water penetration into a structure on the Property due to a natural flood event (if yes, attach TXR 1414).
- ☒ Located wholly partly in a 100-year floodplain (Special Flood Hazard Area-Zone A, V, A99, AE AO, AH, VE, or AR) (if yes, attach TXR 1414).
- ☒ Located wholly partly in a 500-year floodplain (Moderate Flood Hazard Area-Zone X (shaded)).
- ☒ Located wholly partly in a floodway (if yes, attach TXR 1414).
- ☒ Located wholly partly in a flood pool.
- ☒ Located wholly partly in a reservoir.

If the answer to any of the above is yes, explain (attach additional sheets as necessary): _____

*For purposes of this notice:

"100-year floodplain" means any area of land that: (A) is identified on the flood insurance rate map as a special flood hazard area, which is designated as Zone A, V, A99, AE, AO, AH, VE, or AR on the map; (B) has a one percent annual chance of flooding, which is considered to be a high risk of flooding; and (C) may include a regulatory floodway, flood pool, or reservoir.

"500-year floodplain" means any area of land that: (A) is identified on the flood insurance rate map as a moderate flood hazard area, which is designated on the map as Zone X (shaded); and (B) has a two-tenths of one percent annual chance of flooding, which is considered to be a moderate risk of flooding.

"Flood pool" means the area adjacent to a reservoir that lies above the normal maximum operating level of the reservoir and that is subject to controlled inundation under the management of the United States Army Corps of Engineers.

"Flood insurance rate map" means the most recent flood hazard map published by the Federal Emergency Management Agency under the National Flood Insurance Act of 1968 (42 U.S.C. Section 4001 et seq.).

"Floodway" means an area that is identified on the flood insurance rate map as a regulatory floodway, which includes the channel of a river or other watercourse and the adjacent land areas that must be reserved for the discharge of a base flood, also referred to as a 100-year flood, without cumulatively increasing the water surface elevation more than a designated height.

"Reservoir" means a water impoundment project operated by the United States Army Corps of Engineers that is intended to retain water or delay the runoff of water in a designated surface area of land.

Concerning the Property at _____

Section 6. Have you (Seller) ever filed a claim for flood damage to the Property with any insurance provider, including the National Flood Insurance Program (NFIP)?* ☐ yes ☒ no If yes, explain (attach additional sheets as necessary): _____

*Homes in high risk flood zones with mortgages from federally regulated or insured lenders are required to have flood insurance. Even when not required, the Federal Emergency Management Agency (FEMA) encourages homeowners in high risk, moderate risk, and low risk flood zones to purchase flood insurance that covers the structure(s) and the personal property within the structure(s).

Section 7. Have you (Seller) ever received assistance from FEMA or the U.S. Small Business Administration (SBA) for flood damage to the Property? ☐ yes ☒ no If yes, explain (attach additional sheets as necessary): _____

Section 8. Are you (Seller) aware of any of the following? (Mark Yes (Y) if you are aware. Mark No (N) if you are not aware.)

Y N

- ☒ ☐ Room additions, structural modifications, or other alterations or repairs made without necessary permits, with unresolved permits, or not in compliance with building codes in effect at the time.
- ☒ ☐ Homeowners' associations or maintenance fees or assessments. If yes, complete the following:
Name of association: _____
Manager's name: _____ Phone: _____
Fees or assessments are: \$ _____ per _____ and are: ☐ mandatory ☐ voluntary
Any unpaid fees or assessment for the Property? ☐ yes (\$ _____) ☐ no
If the Property is in more than one association, provide information about the other associations below or attach information to this notice.
- ☒ ☐ Any common area (facilities such as pools, tennis courts, walkways, or other) co-owned in undivided interest with others. If yes, complete the following:
Any optional user fees for common facilities charged? ☐ yes ☐ no If yes, describe: _____
- ☒ ☐ Any notices of violations of deed restrictions or governmental ordinances affecting the condition or use of the Property.
- ☒ ☐ Any lawsuits or other legal proceedings directly or indirectly affecting the Property. (Includes, but is not limited to: divorce, foreclosure, heirship, bankruptcy, and taxes.)
- ☒ ☐ Any death on the Property except for those deaths caused by: natural causes, suicide, or accident unrelated to the condition of the Property.
- ☒ ☐ Any condition on the Property which materially affects the health or safety of an individual.
- ☒ ☐ Any repairs or treatments, other than routine maintenance, made to the Property to remediate environmental hazards such as asbestos, radon, lead-based paint, urea-formaldehyde, or mold.
If yes, attach any certificates or other documentation identifying the extent of the remediation (for example, certificate of mold remediation or other remediation).
- ☒ ☐ Any rainwater harvesting system located on the Property that is larger than 500 gallons and that uses a public water supply as an auxiliary water source.
- ☒ ☐ The Property is located in a propane gas system service area owned by a propane distribution system retailer.
- ☒ ☐ Any portion of the Property that is located in a groundwater conservation district or a subsidence district.

If the answer to any of the items in Section 8 is yes, explain (attach additional sheets if necessary): _____

Concerning the Property at _____

1064 Live Oak Lane
Weimar, Tex 78962

Hot WATER leaked over closet near garage & Laundry Room.
Sheet Rock Repaired & Flooring removed & repaired

Section 9. Seller has has not attached a survey of the Property.

Section 10. Within the last 4 years, have you (Seller) received any written inspection reports from persons who regularly provide inspections and who are either licensed as inspectors or otherwise permitted by law to perform inspections? yes ☒ no If yes, attach copies and complete the following:

Inspection Date	Type	Name of Inspector	No. of Pages

*Note: A buyer should not rely on the above-cited reports as a reflection of the current condition of the Property.
A buyer should obtain inspections from inspectors chosen by the buyer.*

Section 11. Check any tax exemption(s) which you (Seller) currently claim for the Property:

☒ Homestead Senior Citizen Disabled
 Wildlife Management Agricultural Disabled Veteran
 Other: Unknown

Section 12. Have you (Seller) ever filed a claim for damage, other than flood damage, to the Property with any insurance provider? ☒ yes no

Section 13. Have you (Seller) ever received proceeds for a claim for damage to the Property (for example, an insurance claim or a settlement or award in a legal proceeding) and not used the proceeds to make the repairs for which the claim was made? yes ☒ no If yes, explain:

Section 14. Does the Property have working smoke detectors installed in accordance with the smoke detector requirements of Chapter 766 of the Health and Safety Code?* unknown no ☒ yes. If no or unknown, explain.
(Attach additional sheets if necessary):

**Chapter 766 of the Health and Safety Code requires one-family or two-family dwellings to have working smoke detectors installed in accordance with the requirements of the building code in effect in the area in which the dwelling is located, including performance, location, and power source requirements. If you do not know the building code requirements in effect in your area, you may check unknown above or contact your local building official for more information.*

A buyer may require a seller to install smoke detectors for the hearing impaired if: (1) the buyer or a member of the buyer's family who will reside in the dwelling is hearing-impaired; (2) the buyer gives the seller written evidence of the hearing impairment from a licensed physician; and (3) within 10 days after the effective date, the buyer makes a written request for the seller to install smoke detectors for the hearing-impaired and specifies the locations for installation. The parties may agree who will bear the cost of installing the smoke detectors and which brand of smoke detectors to install.

Seller acknowledges that the statements in this notice are true to the best of Seller's belief and that no person, including the broker(s), has instructed or influenced Seller to provide inaccurate information or to omit any material information.

Lyndell Bisbee
Signature of Seller

Date

Carolyn C. Bisbee 2-27-21
Signature of Seller Date

Printed Name: Lyndell Bisbee

Printed Name: Carolyn C. Bisbee 2/27/21

(TXR-1406) 09-01-19

Initialed by: Buyer: and Seller: CB

Page 5 of 6

Concerning the Property at _____

11 1064 Live Oak Lane
Weimar, Tex 78962

ADDITIONAL NOTICES TO BUYER:

- (1) The Texas Department of Public Safety maintains a database that the public may search, at no cost, to determine if registered sex offenders are located in certain zip code areas. To search the database, visit www.txdps.state.tx.us. For information concerning past criminal activity in certain areas or neighborhoods, contact the local police department.
- (2) If the Property is located in a coastal area that is seaward of the Gulf Intracoastal Waterway or within 1,000 feet of the mean high tide bordering the Gulf of Mexico, the Property may be subject to the Open Beaches Act or the Dune Protection Act (Chapter 61 or 63, Natural Resources Code, respectively) and a beachfront construction certificate or dune protection permit may be required for repairs or improvements. Contact the local government with ordinance authority over construction adjacent to public beaches for more information.
- (3) If the Property is located in a seacoast territory of this state designated as a catastrophe area by the Commissioner of the Texas Department of Insurance, the Property may be subject to additional requirements to obtain or continue windstorm and hail insurance. A certificate of compliance may be required for repairs or improvements to the Property. For more information, please review *Information Regarding Windstorm and Hail Insurance for Certain Properties* (TXR 2518) and contact the Texas Department of Insurance or the Texas Windstorm Insurance Association.
- (4) This Property may be located near a military installation and may be affected by high noise or air installation compatible use zones or other operations. Information relating to high noise and compatible use zones is available in the most recent Air Installation Compatible Use Zone Study or Joint Land Use Study prepared for a military installation and may be accessed on the Internet website of the military installation and of the county and any municipality in which the military installation is located.
- (5) If you are basing your offers on square footage, measurements, or boundaries, you should have those items independently measured to verify any reported information.
- (6) The following providers currently provide service to the Property:
- | | |
|--|------------------------------|
| Electric: <u>SAN BERNARD Electric COOP</u> | phone #: <u>979-732-8346</u> |
| Sewer: <u>BURCHFIELD SEPTIC</u> | phone #: <u>979-732-4486</u> |
| Water: _____ | phone #: _____ |
| Cable: <u>DIRECT TV (ATTN)</u> | phone #: <u>800-288-2020</u> |
| Trash: <u>TEXAS DISPOSAL SYSTEMS</u> | phone #: <u>800-375-8375</u> |
| Natural Gas: _____ | phone #: _____ |
| Phone Company: _____ | phone #: _____ |
| Propane: <u>COLUMBUS BUTANE CO</u> | phone #: <u>979-732-2074</u> |
| Internet: _____ | phone #: _____ |
- (7) This Seller's Disclosure Notice was completed by Seller as of the date signed. The brokers have relied on this notice as true and correct and have no reason to believe it to be false or inaccurate. YOU ARE ENCOURAGED TO HAVE AN INSPECTOR OF YOUR CHOICE INSPECT THE PROPERTY.

The undersigned Buyer acknowledges receipt of the foregoing notice.

Signature of Buyer _____ Date _____ Signature of Buyer _____ Date _____
Printed Name: _____ Printed Name: _____

(TXR-1406) 09-01-19

Initialed by: Buyer: _____ and Seller: CE. YB

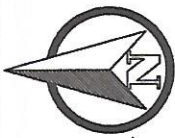

0' 80' 160'

LIVE OAK LANE
(60' R.O.W.)

P.O.B.
Texas South Central Zone
NAD 83/2011
State Plane Grid Coords
NXY: 13,804,315.22 USft
EX: 2,711,809.08 USft

LOUISE L. DAVIS III, ET AL
TO
CHARLES R. LA GRANGE, ET UX
NOVEMBER 8, 2011
CALLED 5.00 ACRES
VOLUME 685, PAGE 104
O.R.C.C.T.

(S 01°45'33" E 306.83')
(S 03°02'40" E 306.76')

(S 87°58'17" E 142.20')
(S 86°43'50" E (142.08'))

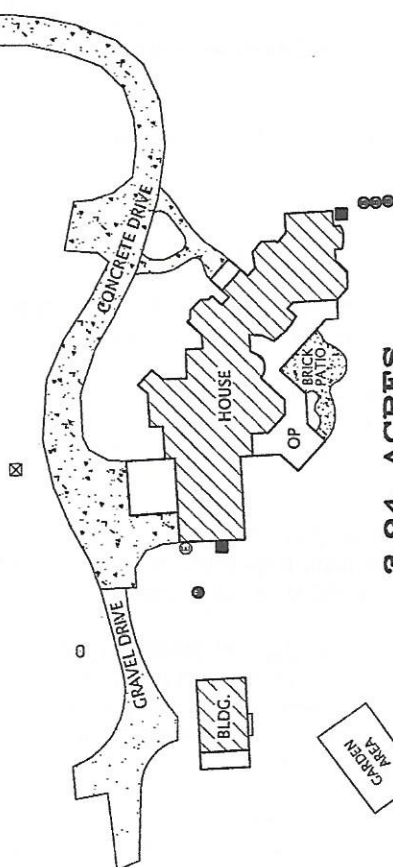

3.94 ACRES
DAVID W. STROUD, ET UX
TO
LYNDELL D. BISBEE, ET UX
JANUARY 4, 2005
CALLED 3.94 ACRES
VOLUME 482, PAGE 554
O.R.C.C.T.

(S 88°14'25" W 554.15')
(S 87°00'01" W 554.49')

405.75'

(N 84°43'34" E 405.55')
(N 85°57'18" E 405.55')

LOUISE DAVIS III, ET UX
TO
BRUCE BOSL, ET UX
OCTOBER 1, 2010
CALLED 2.930 ACRES
VOLUME 651, PAGE 616
O.R.C.C.T.

(N 00°21'49" W 303.21')
(N 01°38'40" W 303.21')

PROPERTY ADDRESS: 1064 LIVE OAK LN., WEIMAR, TX 78962

**SURVEY PLAT OF 3.94 ACRES
ALFRED KELSO SURVEY, A-368
COLORADO COUNTY, TEXAS**

FRANK
SURVEYING COMPANY INC
2205 Walnut Street - Columbus, TX 78934
Ph: 979,732,3114 - Fax: 979,732,5271
www.franksurveying.com
LAND SURVEYING/ENERGY/GIS SERVICES

DATE: 05/30/2013
DRAWN BY: WLL
CHECKED BY: MWL
FIELD CREW: CDL/DFS
PROJECT NO: 201305148
COUNTY: COLORADO
SCALE: 1" = 80'
SHEET: 1 OF 1

LEGEND

- ⊗ 5/8" IRON ROD SET W/ 2" ALUM. CAP
- ⊗ MAG NAIL W/DISK SET IN FENCE POST
- 1/2" IRON ROD FOUND
- A/C PAD
- ⊕ ELECTRIC METER
- ⊗ ELECTRIC JUNCTION BOX
- PROpane TANK
- ⊕ POWER POLE
- ⊗ SEPTIC/CLEANOUT
- ⊗ WATER WELL
- OVERHEAD ELECTRIC LINE
- GAME FENCE
- WIRE FENCE
- () RECORD INFORMATION

MELVIN W. HATTERMANN
TO
ALAN HATTERMANN, ET UX
JANUARY 16, 1980
CALLED 62.50 ACRES
VOLUME 405, PAGE 138
D.R.C.C.T.

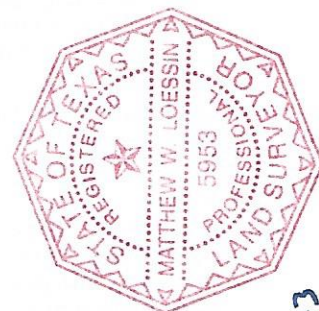

3-29, 2013 UNDER
FOUND AT THE

05/30/2013