

STATE OF ALABAMA
COUNTY OF ESCAMBIA

I, SIDNEY J. ORRELL JR., A REGISTERED LAND SURVEYOR IN THE STATE OF ALABAMA, HEREBY CERTIFY THAT THE FOREGOING IS A TRUE AND CORRECT PLAT OF THE FOLLOWING DESCRIBED PROPERTY, TO WIT:

COMMENCE AT THE SOUTHWEST CORNER OF THE SOUTHEAST QUARTER OF THE SOUTHWEST QUARTER OF SECTION 18, T-1-N, R-6-E; THENCE EAST FOR 400.0 FEET; THENCE NORTH FOR 32.0 FEET; THENCE EAST FOR 223.0 FEET TO THE WEST RIGHT-OF-WAY LINE OF AN EXISTING 50' WIDE RIGHT-OF-WAY; THENCE N11°39'00"W FOR 413.43 FEET ALONG SAID WEST RIGHT-OF-WAY LINE TO THE SOUTH RIGHT-OF-WAY LINE OF AN EXISTING 30' WIDE RIGHT-OF-WAY; THENCE WEST FOR 11.65 FEET ALONG SAID SOUTH RIGHT-OF-WAY LINE; THENCE NORTH 30.0 FEET TO THE POINT OF BEGINNING; THENCE CONTINUE NORTH 208.71 FEET; THENCE WEST 208.71 FEET; THENCE SOUTH 208.71 FEET; THENCE EAST 208.71 FEET TO THE POINT OF BEGINNING. CONTAINING ONE ACRE, MORE OR LESS

I FURTHER CERTIFY THAT THE BUILDINGS NOW ERECTED ON SAID LOT ARE WITHIN THE BOUNDARIES OF SAME; THERE ARE NO ENCROACHMENTS BY ADJOINING PROPERTY, EXCEPT AS SHOWN; THERE ARE NO RIGHTS OF WAY EASEMENTS OR JOINT DRIVEWAYS OVER OR ACROSS SAID LAND VISIBLE ON THE SURFACE, EXCEPT AS SHOWN, THERE ARE NO ELECTRIC OR TELEPHONE WIRES (EXCLUDING WIRES WHICH SERVE THE PREMISES ONLY) OR STRUCTURES OR SUPPORTS THEREFOR INCLUDING POLES, ANCHORS AND GUY WIRES ON OR OVER SAID PREMISES, EXCEPT AS SHOWN; ALSO THAT I HAVE CONSULTED THE FEDERAL INSURANCE ADMINISTRATION FLOOD HAZARD BOUNDARY MAP AND FOUND THAT THE ABOVE DESCRIBED IS LOCATED IN ZONE "C" OF THE SPECIAL FLOOD HAZARD AREA.

ACCORDING TO MY SURVEY THIS, THE 23RD DAY OF JULY 1985.

ALA. REG. NO. 9982

POLYSURVEYING OF MOBILE
POST OFFICE BOX 6404
MOBILE, ALABAMA 36660

Kenneth R. Barnhill
 Sandra E. Barnhill

BOX 12315, PENSACOLA, FLORIDA, 32581



SCALE: 1"=50'

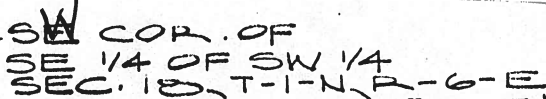

ESCAMBIA COUNTY, STATE OF ALABAMA

SEC. 10 TWP. 1-N RGE. 6-E RECORDED - BOOK - PAGE -

DATE 6-23-85 SCALE 1"=50' FIELD BOOK PAGE

REQUESTED BY CARL WATFORD JOB NO. 103P

I HEREBY CERTIFY THE SURVEY SHOWN HEREON TO BE TRUE AND CORRECT TO THE BEST OF MY KNOWLEDGE AND BELIEF, AND IT MEETS THE MINIMUM TECHNICAL STANDARDS SET BY THE ALABAMA BOARD OF LAND SURVEYORS.

REGISTERED SURVEYOR NO. 2729 STATE OF ALABAMA



**Not Valid Unless Sealed
With An Embossed Seal.**