

Soils Map

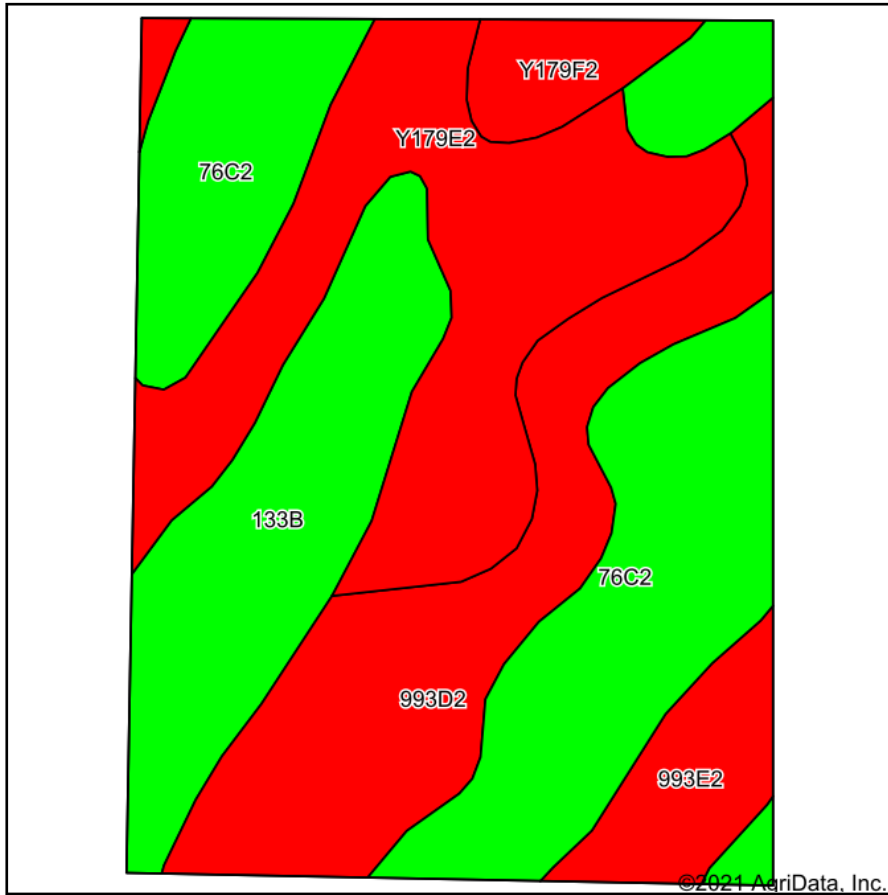

Soils data provided by USDA and NRCS.

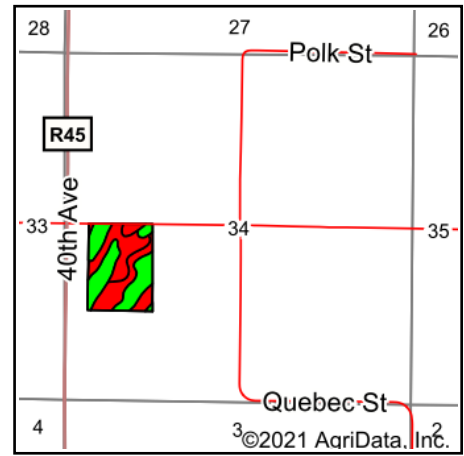

State: **Iowa**
 County: **Warren**
 Location: **34-75N-25W**
 Township: **Jackson**
 Acres: **30.35**
 Date: **4/22/2021**

PC PEOPLES
 COMPANY
 INNOVATIVE. REAL ESTATE. SOLUTIONS.

Maps Provided By:

surety
 CUSTOMIZED ONLINE MAPPING
 © AgriData, Inc. 2021 www.AgriDataInc.com



Area Symbol: IA181, Soil Area Version: 25

Code	Soil Description	Acres	Percent of field	CSR2 Legend	Non-Irr Class *c	CSR2**	CSR	*n NCCPI Overall	*n NCCPI Corn	*n NCCPI Small Grains	*n NCCPI Soybeans
76C2	Ladoga silt loam, dissected till plain, 5 to 9 percent slopes, eroded	8.97	29.6%		IIIe	75	65	78	78	69	66
Y179E2	Gara loam, dissected till plain, 14 to 18 percent slopes, eroded	7.56	24.9%		VIe	32		72	72	54	50
993D2	Armstrong-Gara loams, 9 to 14 percent slopes, moderately eroded	5.89	19.4%		IVe	23	20	68	68	52	47
133B	Colo silty clay loam, dissected till plain, 2 to 5 percent slopes, occasionally flooded	5.19	17.1%		IIw	74	75	83	80	38	82
993E2	Armstrong-Gara loams, 14 to 18 percent slopes, moderately eroded	1.68	5.5%		VIe	17	5	63	63	45	43
Y179F2	Gara loam, dissected till plain, 18 to 25 percent slopes, eroded	1.06	3.5%		VIIe	16		57	57	36	37
Weighted Average						48.8	*-	*n 73.9	*n 73.3	*n 54.2	*n 58.8

**IA has updated the CSR values for each county to CSR2.

*- CSR weighted average cannot be calculated on the current soils data, use prior data version for csr values.

*n: The aggregation method is "Weighted Average using all components"

*c: Using Capabilities Class Dominant Condition Aggregation Method

Soils data provided by USDA and NRCS.