

Soils Map

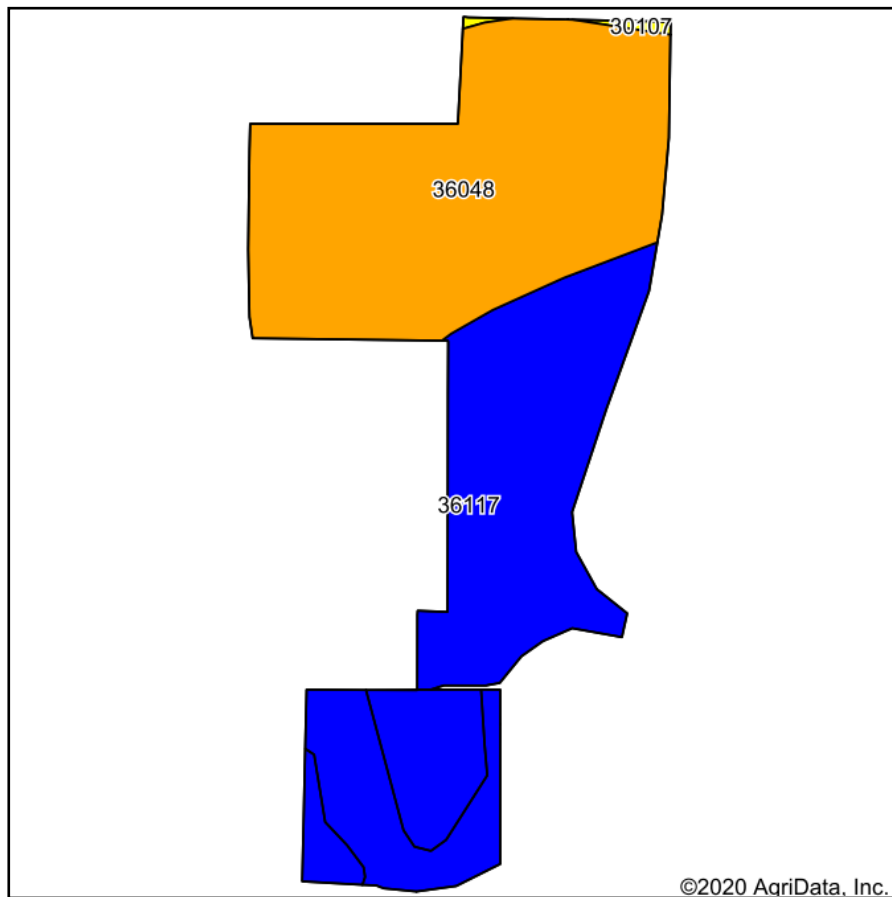

Soils data provided by USDA and NRCS.

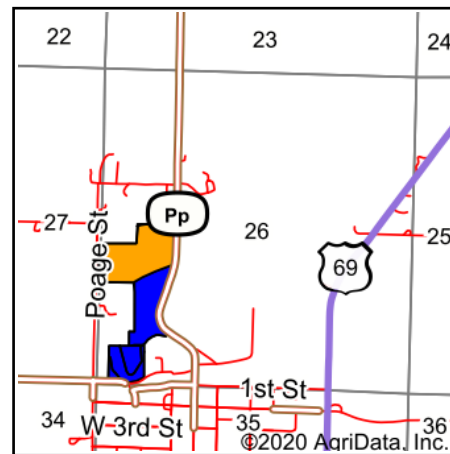

State: **Missouri**
 County: **Daviess**
 Location: **26-61N-29W**
 Township: **Benton**
 Acres: **41.84**
 Date: **12/20/2020**

United
Country
Property
Solutions, LLC

Maps Provided By:

surety
CUSTOMIZED ONLINE MAPPING
© AgriData, Inc. 2020 www.AgriDataInc.com



Code	Soil Description	Acres	Percent of field	Non-Irr Class Legend	Non-Irr Class *c	*n NCCPI Overall	*n NCCPI Corn	*n NCCPI Soybeans
36117	Nodaway silt loam, heavy till, 0 to 2 percent slopes, occasionally flooded	20.87	49.9%		IIw	84	84	81
36048	Zook silt loam, overwash, 0 to 2 percent slopes, occasionally flooded	20.78	49.7%		IIIw	71	61	71
30107	Greenton silt loam, 9 to 14 percent slopes	0.19	0.5%		IVe	57	57	55
Weighted Average						*n 77.4	*n 72.5	*n 75.9

*n: The aggregation method is "Weighted Average using all components"

*c: Using Capabilities Class Dominant Condition Aggregation Method

Soils data provided by USDA and NRCS.