

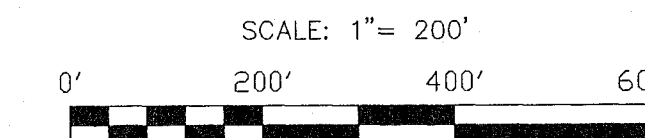

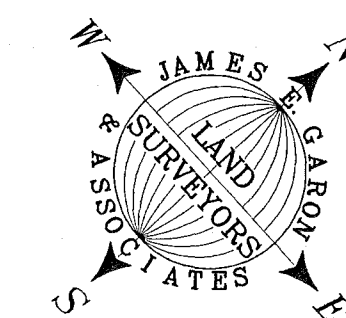







| LINE | BEARING | DISTANCE |
|------|---------------|----------|
| L1 | N 40°21'47" W | 60.05' |
| L2 | S 57°39'42" E | 112.71' |
| L3 | N 08°45'54" E | 311.62' |
| L4 | N 13°28'34" E | 114.91' |
| L5 | N 53°00'35" E | 222.02' |
| L6 | N 70°41'58" E | 432.46' |
| L7 | N 77°01'47" E | 159.31' |
| L8 | S 30°11'12" E | 531.82' |
| L9 | S 14°02'21" W | 149.77' |
| L10 | S 42°46'31" W | 492.79' |
| L11 | S 10°53'59" W | 384.77' |
| L12 | S 25°22'36" E | 217.49' |
| L13 | S 84°23'15" E | 231.45' |
| L14 | N 75°51'47" E | 166.01' |
| L15 | N 73°09'35" E | 374.09' |
| L16 | N 59°13'09" E | 259.15' |
| L17 | S 11°59'31" W | 64.07' |
| L18 | S 84°59'54" W | 307.25' |
| L19 | N 89°59'21" W | 575.97' |
| L20 | N 37°57'32" W | 128.38' |
| L21 | N 23°27'33" W | 92.69' |

| LINE | BEARING | DISTANCE |
|-------|---------------|----------|
| (L1) | N 40°16'56" W | 60.00' |
| (L2) | S 56°13'47" E | 112.90' |
| (L3) | N 07°04'05" E | 159.21' |
| (L12) | S 31°56'45" E | 236.08' |
| (L16) | N 56°55'12" E | 293.51' |
| (L17) | S 11°47'21" W | 63.76' |
| (L18) | S 84°59'54" W | 307.25' |
| (L19) | N 89°57'01" W | 575.75' |
| (L20) | N 38°02'59" W | 125.52' |
| (L21) | N 23°21'49" W | 92.59' |



| LEGEND | |
|---|--------------------------------|
|  | CALCULATED POINT ON RIVER BANK |
|  | 5/8" REBAR FOUND |
|  | 1/2" REBAR SET W/CAP |
|  | STAMPED J.E. GARON RPLS 4302 |
|  | 1/2" PIPE FOUND (UNLESS NOTED) |
|  | WIRE FENCE |
|  | POWER POLE |
|  | OVERHEAD ELECTRIC LINE |
|  | DOWN GUY |
|  | RECORD CALL |
| (BRG.-DIST.) | |

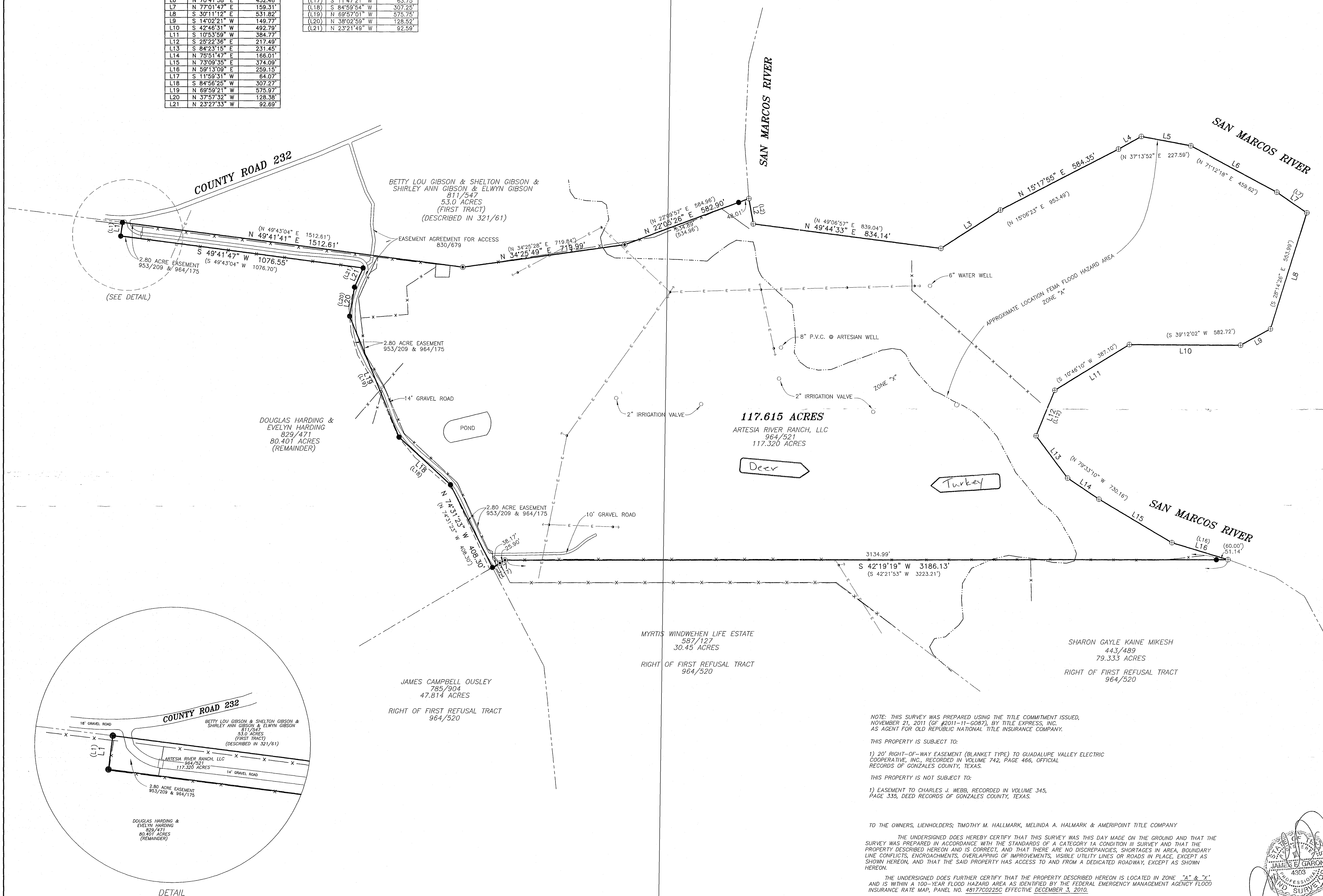

**SURVEY MAP
OF
117.615 ACRES
OUT OF THE
JOSE MARIA SALINAS
FOUR LEAUGE GRANT,
ABSTRACT NO. 59,
SITUATED IN
GONZALES COUNTY, TEXAS**

NOTE: THIS SURVEY WAS PREPARED USING THE TITLE COMMITMENT ISSUED, NOVEMBER 21, 2011 (GF #2011-11-G087), BY TITLE EXPRESS, INC. AS AGENT FOR OLD REPUBLIC NATIONAL TITLE INSURANCE COMPANY.

THIS PROPERTY IS SUBJECT TO:

1) 20' RIGHT-OF-WAY EASEMENT (BLANKET TYPE) TO GUADALUPE VALLEY ELECTRIC COOPERATIVE, INC., RECORDED IN VOLUME 742, PAGE 466, OFFICIAL RECORDS OF GONZALES COUNTY, TEXAS.

THIS PROPERTY IS NOT SUBJECT TO:

1) EASEMENT TO CHARLES J. WEBB, RECORDED IN VOLUME 345, PAGE 335, DEED RECORDS OF GONZALES COUNTY, TEXAS.

TO THE OWNERS, LIENHOLDERS; TIMOTHY M. HALLMARK, MELINDA A. HALLMARK & AMERPOINT TITLE COMPANY

THE UNDERSIGNED DOES HEREBY CERTIFY THAT THIS SURVEY WAS THIS DAY MADE ON THE GROUND AND THAT THE SURVEY WAS PREPARED IN ACCORDANCE WITH THE STANDARDS OF A CATEGORY 1A CONDITION III SURVEY AND THAT THE PROPERTY DESCRIBED HEREON AND IS CORRECT, AND THAT THERE ARE NO DISCREPANCIES, SHORTAGES IN AREA, BOUNDARY LINE CONFLICTS, ENDOACHMENTS, OVERLAPPING OF IMPROVEMENTS, VISIBLE UTILITY LINES OR ROADS IN PLACE, EXCEPT AS SHOWN HEREON, AND THAT THE SAID PROPERTY HAS ACCESS TO AND FROM A DEDICATED ROADWAY, EXCEPT AS SHOWN HEREON.

THE UNDERSIGNED DOES FURTHER CERTIFY THAT THE PROPERTY DESCRIBED HEREON IS LOCATED IN ZONE "A" & "X" AND IS WITHIN A 100-YEAR FLOOD HAZARD AREA AS IDENTIFIED BY THE FEDERAL EMERGENCY MANAGEMENT AGENCY FLOOD INSURANCE RATE MAP, PANEL NO. 481700220C, EFFECTIVE DECEMBER 3, 2010.

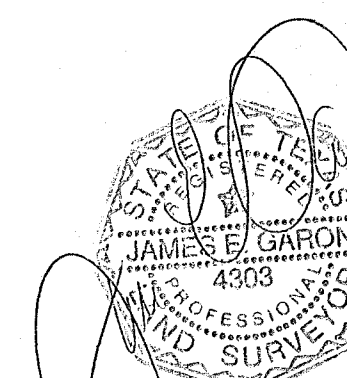

REFERENCE: TIMOTHY M. HALLMARK & MELINDA A. HALLMARK, G.F. NO. 2011-11-G087
ADDRESS: COUNTY ROAD 232
LEGAL DESCRIPTION: 117.615 ACRES OUT OF THE JOSE MARIA SALINAS FOUR LEAUGE GRANT, ABSTRACT NO. 59, GONZALES COUNTY, TEXAS
FIELD BOOK: B-420/40-47
FILE: Server\Co\Gonzales\Surveys\Jose Maria Salinas\39511.dwg

JAMES E. GARON & ASSOC.
PROFESSIONAL LAND SURVEYORS
924 Main Street
Bastrop, Texas 78602
(512) 303-4185
(512) 321-2107 fax