

Franklin County, VA Property Information



DISCLAIMER: While every effort has been made to ensure the accuracy of the information presented, Franklin County is not responsible for the accuracy of the content contained herein and will not be liable for its mis-use or any decisions based on this report's contents.

Property Owner: COMER BENJAMIN B & KATHERINE A & SARAH R
Owner Address: 2368 SCENIC VIEW RD

Tax Map #: 0150008400

MONETA VA 24121

Map: 015 . 00 - 084 . 00
Parcel:

Record #: 2,919

Legal Desc 1: RT 666

Legal Desc 2: LOT 1

Legal Desc 3:

Assessed Values

Acreage: 16.29

Land Value: \$ 564,400.00
Bldg Value: \$ 372,900.00

Total Assessed Value:
\$ 937,300.00

Land Use Program Value:
\$.00

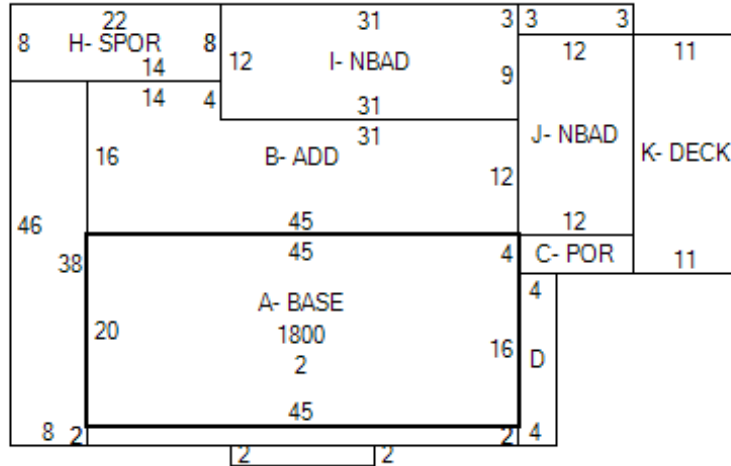

Zoning Information

Zoning Classification:
R1

Transfer History

Most Recent Transfer

Deed Bk: 1155 **Deed Pg:** 264 **Instrument Type:** DG **Instrument Yr:** 2021 **Instrument #:** 554
Plat Bk: **Plat Pg:** 0 **Date:** 01/19/2021 **Price:** \$ 0.00
Grantor: COMER BENJAMIN B

Most Recent Transfer 1

Deed Book: 1154 **Deed Page:** 539 **Instrument Type:** DD **Instrument Yr:** 2021 **Instrument #:** 87
Grantor: RING ELFLEDA A (ESTATE) **Price:** \$ 0.00 **Date:** 1/4/2021

Most Recent Transfer 2

Deed Book: **Deed Page:** 0 **Instrument Type:** WB **Instrument Yr:** 2021 **Instrument #:** 67757
Grantor: RING ELFLEDA ARMISTEAD **Price:** \$ 0.00 **Date:** 1/4/2021

Most Recent Transfer 3

Deed Book: 323 **Deed Page:** 112 **Instrument Type:** **Instrument Yr:** 0 **Instrument #:** 0
Grantor: ARMISTEAD M W III **Price:** \$ 0.00 **Date:** 0/0/0

Improvement Details:

Exterior

Year Built: 1978 **Foundation:** CONCRETE **Garage:** NONE
Occupancy Type: DWELLING **Ext. Walls:** FRAME **No. of Cars:** 0
Condition: AVERAGE **Roofing:** COMPOSITION SHINGLE **Carport:** NONE
Roof Type: GABLE **No. of Cars:** 0

Interior

Stories: 2 **Heating:** HEAT PUMP **Base Living Sq Ft:** 1,496
Total Rooms: 8 **A/C:** YES **Finished Sq Ft:** 3,772
Bedrooms: 4 **Fireplaces:** 2 **Finished Bsmt Sq Ft:** 748
Full Baths: 3 **Flues:** 0 **Total Bsmt Sq Ft:** 1,496
Half Baths: 1 **Unfinished Bsmt Sq Ft:** 748
Interior Walls: DRYWALL
Floor Covering: WOOD FLOORING

Franklin County, VA Property Information



DISCLAIMER: While every effort has been made to ensure the accuracy of the information presented, Franklin County is not responsible for the accuracy of the content contained herein and will not be liable for its mis-use or any decisions based on this report's contents.

Site Information:

Right of Way: PUBLIC

Terrain Characteristics: ON GRADE

Water: WELL

Electric: YES

Easements:

PAVED

Sewer: SEPTIC

Gas: NO