

Soils Map - Total Acres

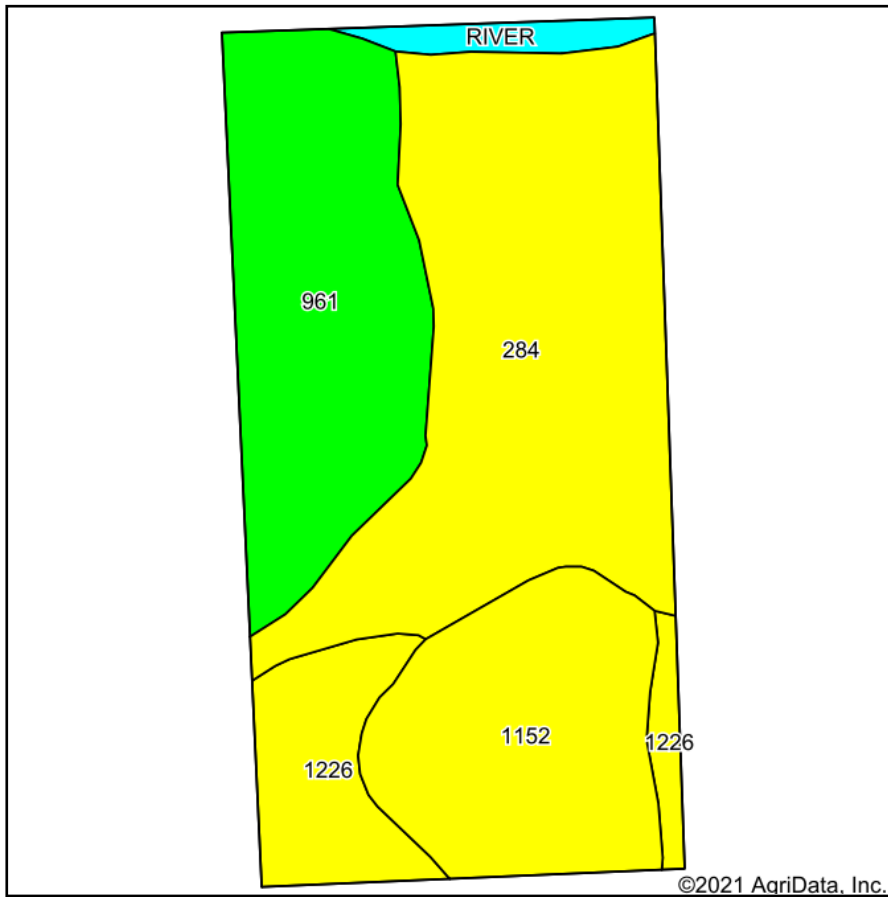

Soils data provided by USDA and NRCS.

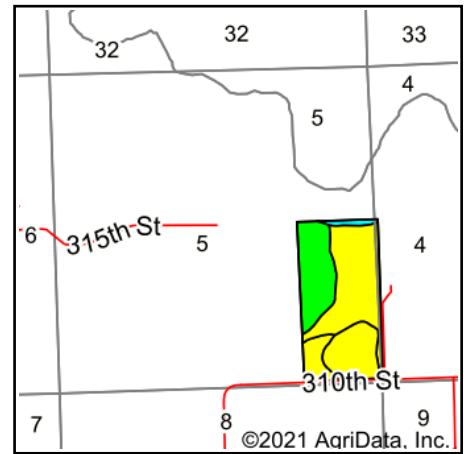

State: **Iowa**
 County: **Scott**
 Location: **5-80N-4E**
 Township: **Butler**
 Acres: **80**
 Date: **6/18/2021**



Maps Provided By:



Area Symbol: IA163, Soil Area Version: 29

Code	Soil Description	Acres	Percent of field	CSR2 Legend	Non-Irr Class *c	*i Corn	*i Alfalfa	*i Soybeans	CSR2**	Corn	Oats	Soybeans	*n NCCPI Corn	*n NCCPI Soybeans
284	Flagler sandy loam, 0 to 2 percent slopes	33.05	41.3%		Ills	80	2.2	23.2	56				65	36
961	Ambraw clay loam, 0 to 2 percent slopes	20.89	26.1%		Ilw	196.8	4.1	57.1	73				73	79
1152	Marshan clay loam, 0 to 2 percent slopes, rarely flooded	16.01	20.0%		Ilw	80	1.7	23.2	54	90	57	30	82	61
1226	Lawler loam, 0 to 2 percent slopes, rarely flooded	8.26	10.3%		Ills	80	2.1	23.2	59				84	61
RIVER	Water, rivers and streams	1.79	2.2%						0					
Weighted Average						108.7	2.5	31.5	59.1	18	11.4	6	*n 71	*n 54

**IA has updated the CSR values for each county to CSR2.

*i Yield data provided by the ISPAID Database version 8.1.1 developed by IA State University.

*n: The aggregation method is "Weighted Average using all components"

*c: Using Capabilities Class Dominant Condition Aggregation Method

Soils data provided by USDA and NRCS.