

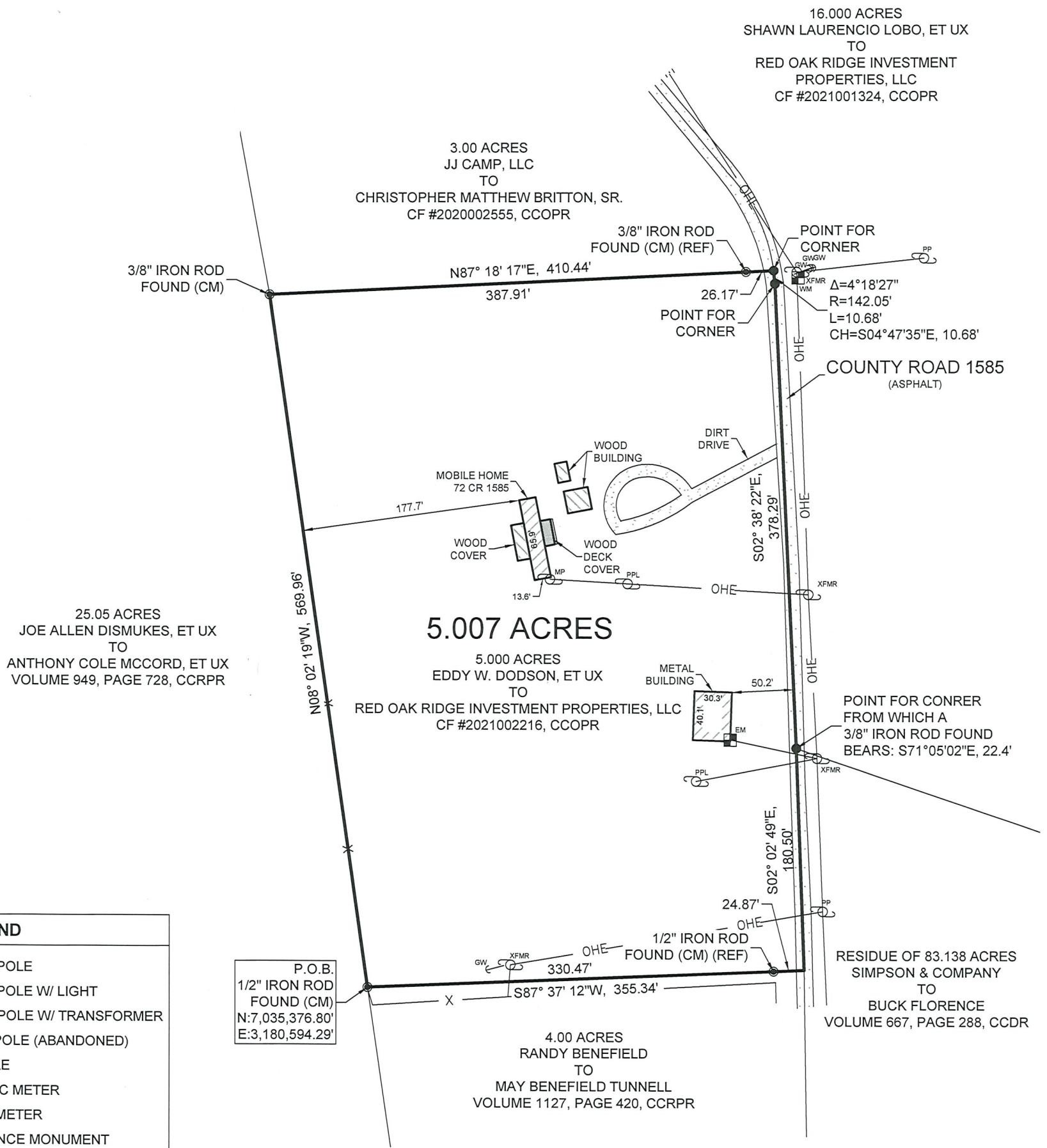

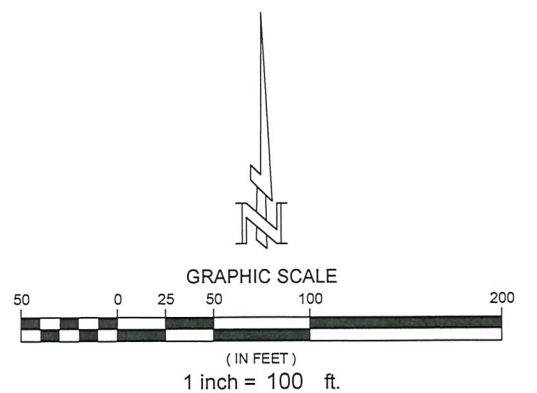







1. BEARINGS ARE BASED UPON THE TEXAS COORDINATE SYSTEM OF 1983 (NAD83), NORTH CENTRAL ZONE.
2. A CERTIFIED METES AND BOUNDS DESCRIPTION HAS BEEN PREPARED UNDER THE SAME JOB NUMBER AS A PART OF THIS PROFESSIONAL SERVICE.
3. THIS PROFESSIONAL SERVICE WAS PERFORMED WITHOUT BENEFIT OF HAVING BEEN FURNISHED A TITLE COMMITMENT. EASEMENTS AND/OR OTHER MATTERS AND/OR ISSUES RELATING TO TITLE COULD AND MAY EXIST.
4. ACCORDING TO TEXAS LOCAL GOVERNMENT CODE, CHAPTER 212.004 AND 212.005, DIVIDING ANY TRACT OR LOT INTO TWO OR MORE PARTS WITHOUT BENEFIT OF A SUBDIVISION PLAT APPROVED AND RECORDED WITH THE COUNTY CLERK, IS A VIOLATION OF CITY ORDINANCE AND/OR STATE LAW, SUBJECTING THE VIOLATOR TO FINES AND/OR THE WITHHOLDING OF UTILITIES AND BUILDING PERMITS.



## LEGEND

	POWER POLE
	POWER POLE W/ LIGHT
	POWER POLE W/ TRANSFORMER
	METER POLE (ABANDONED)
	GUY WIRE
	ELECTRIC METER
	WATER METER
(REF)	REFERENCE MONUMENT
(CM)	CONTROLLING MONUMENT
	BARBED WIRE FENCE
	OVERHEAD ELECTRIC

I HEREBY CERTIFY THIS PLAT AS A REPRESENTATION OF A SURVEY  
MADE ON THE GROUND UNDER MY SUPERVISION, THAT IT REFLECTS  
THE FACTS AS FOUND AT THE TIME OF SAID SURVEY, AND THAT IT  
SUBSTANTIALLY CONFORMS TO THE CURRENT GENERAL RULES OF  
PROCEDURES AND PRACTICES, ESTABLISHED BY THE BOARD OF  
PROFESSIONAL LAND SURVEYING, AS AUTHORIZED BY THE  
PROFESSIONAL LAND SURVEYING PRACTICES ACT. (ART 5282C, VES)

  
BRET READ  
PROFESSIONAL LAND SURVEYOR  
TEXAS REGISTRATION NO. 6610

MAY 26, 2021  
DATE

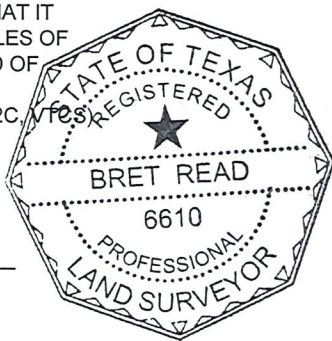

PLAT OF SURVEY OF  
5.007 ACRES  
IN THE JAMES ANDERS SURVEY, A-22  
CASS COUNTY, TEXAS



**360 SURVEYING**  
310 H. G. MOSLEY PKWY, LONGVIEW, TEXAS 75604  
(903) 387-2577 WWW.360SURV.COM  
TBPELS 10194293

MAY 28, 2021	DRAWN BY: MTW	CHECKED BY: JBR	JOB #1446-018
--------------	---------------	-----------------	---------------