

PEDRO BERMEA SURVEY
ABSTRACT 9

Called 107,802 Acres
Alejandro Cruz-Tirado
Instrument No. 1400257

Tract. No. 1
Called 112,724 Acres
Eldon D. Monk & Janet K. Monk
Instrument No. 1402256

8.883 ACRES
BEING ALL OF LOT E-68
MEADOWOOD SUBDIVISION
VOLUME 1, PAGE 216 (PLAT RECORDS)
HOUSTON COUNTY, TEXAS

HENRY MASTERS SURVEY
ABSTRACT 53

LOT E-67

LOT E-68

A.A. Davis Title
GF # 15445FNT

SCHEDULE 'B'

(Note: Any easements not shown hereon were not provided, located or visible. Cain Surveying Company does not certify to any easements that are not visible and not provided to us by said Title company. Easement research was limited to the following: Easements and Data provided to CSC by said Title Company.)

- 1) Restrictions, Volume 644, Page 64 - Does affect subject tract.
Volume 1006, Page 227 - Does affect subject tract as shown.

- 10) Utility Easement, Volume 1, Page 216 (Plat Records) - Does affect subject tract as shown.

Note: Bearings are based on the east line of Lot E-68, Meadowood Subdivision as recorded in Volume 1, Page 216 of the Plat Records of Houston County, Texas.

I, Waylon R. Adams, do hereby certify that this Plat accurately represents an on the ground survey made under my direct supervision on December 14, 2015 and is being submitted along with a Legal Description of the tract(s) shown hereon.

Waylon R. Adams
Registered Professional Land Surveyor
State of Texas No. 5748

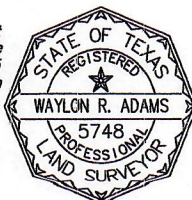

DRAWN BY: W.R.A.
DATE: 12/28/2015
DWG. NO.: J2405
FB/PG: 266/39

REVISIONS:

A SURVEY FOR
CLIFTON W. LENHART
900 MEADOWVIEW ROAD, CROCKETT
HOUSTON COUNTY, TEXAS

CAIN
SURVEYING COMPANY
315 HWY. 110 SOUTH-WHITEHOUSE, TEXAS 75791
PHONE: 803-839-1104 FAX: 803-839-1184

LEGEND:

- { } DEED CALL
- 3/4" IRF
- ⊗ A/C
- POWER POLE
- ⊗ WATER METER
- ⊗ ELECTRIC METER
- SEPTIC TANK

UNLESS OTHERWISE NOTED.

0 100 200



1400257

Instrument No. 1
112.724 Acres
D. Monk & Janet K. Monk
Instrument No. 1402256

1/2" IRF w/Cap

N 57°38'43" E - 399.66'
{400.00'}

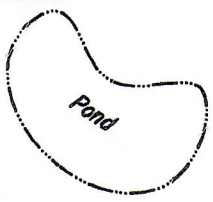

3/4" IRF
1/2" IRF w/Cap brs.
S 63°25'29" W - 15.34'

VOLUME 1
HOUSE

HENRY MASTERS SURVEY
ABSTRACT 53

LOT E-68

LOT E-67

10' SBL (1006/227)
N 32°21'31" W - 967
{967.54'}

10' SBL (1006/227)
S 32°23'18" E - 967.54'
{Bearing Base}
{967.54'}

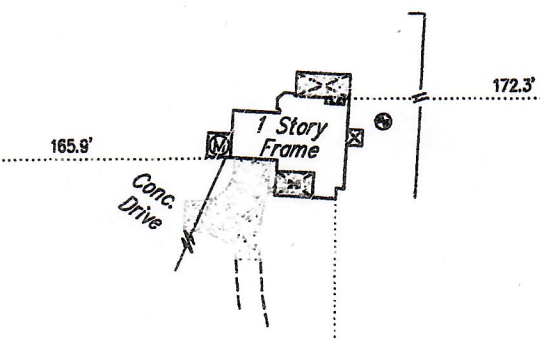

Gravel Drive

60' Road & Utility Esmt.
Volume 1, Page 216 (Plat Records)
table. Coin
and not
following:

1/2" IRF

40' SBL (1006/227)

{400.00'}
S 57°38'43" W - 400.16'

30'
60'