

*APPLICATION FOR A PERMIT

To appropriate the Public Waters of the State of Oregon

I, H. O. Stults
 (Name of applicant)
 of McMinnville, Oregon.
 (Postoffice), County of Yamhill,
 State of Oregon, do hereby make application for a permit to appropriate the
 following described public waters of the State of Oregon, subject to existing rights:

If the applicant is a corporation, give date and place of incorporation _____

1. The source of the proposed appropriation is Salt Creek
 (Name of stream)
 _____, a tributary of Yamhill River

2. The amount of water which the applicant intends to apply to beneficial use is 0.6
 cubic feet per second.
 (If water is to be used from more than one source, give quantity from each)

3. The use to which the water is to be applied is Irrigation
 (Irrigation, power, mining, manufacturing, domestic supplies, etc.)

4. The point of diversion is located 220 ft. S. and 200 ft. E. from the NW
 (N. or S.) (E. or W.)
 corner of NE $\frac{1}{4}$ of NW $\frac{1}{4}$, Sec. 8, T. 5 S., R. 4 W.
 (Section or subdivision)

(If preferable, give distance and bearing to Sec. Cor.)

(If there are more than one points of diversion, each must be described. Use separate sheet if necessary)

being within the NE $\frac{1}{4}$ of NW $\frac{1}{4}$ of Sec. 8, Tp. 5 S,
 (Give smallest legal subdivision) (No. N. or S.)
 R. 4 W, W. M., in the county of Yamhill
 (No. E. or W.)

5. The Main ditch to be 750 feet.
 (Main ditch, canal or pipe line) (No. miles or feet)
 in length, terminating in the NW $\frac{1}{4}$ of NE $\frac{1}{4}$ of Sec. 8, Tp. 5 S,
 (Smallest legal subdivision) (No. N. or S.)
 R. 4 W, W. M., the proposed location being shown throughout on the accompanying map.
 (No. E. or W.)

6. The name of the ditch, canal or other works is _____

DESCRIPTION OF WORKS

DIVERSION WORKS—

7. (a) Height of dam _____ feet, length on top _____ feet, length at bottom
 _____ feet; material to be used and character of construction _____
 (Loose rock, concrete, masonry,
 rock and brush, timber crib, etc., wasteway over or around dam)

(b) Description of headgate _____
 (Timber, concrete, etc., number and size of openings)

* A different form of application is provided where storage works are contemplated. These forms can be secured without charge, together with instructions, by addressing the State Engineer, Salem, Oregon.

CANAL SYSTEM OR PIPE LINE

8. (a) Give dimensions at each point of canal where materially changed in size, stating miles from headgate. At headgate: width on top (at water line) feet; width on bottom feet; depth of water feet; grade feet fall per one thousand feet.

(b) At miles from headgate: width on top (at water line) feet; width on bottom feet; depth of water feet; grade feet fall per one thousand feet.

(c) Length of pipe, pump ft.; size at intake, in.; size at ft. from intake in.; size at place of use in.; difference in elevation between intake and place of use, ft. Is grade uniform? Estimated capacity, sec. ft.

FILL IN THE FOLLOWING INFORMATION WHERE THE WATER IS USED FOR IRRIGATION—

9. The land to be irrigated has a total area of 30 acres acres, located in each smallest legal subdivision, as follows:

| Township | Range | Section | Forty-acre Tract | Number Acres to be Irrigated |
|----------|-------|---------|--------------------------------------|------------------------------|
| 5 S | 4 W | 8 | NE $\frac{1}{4}$ of NW $\frac{1}{4}$ | 24 |
| | | | NW $\frac{1}{4}$ of NW $\frac{1}{4}$ | 4 |
| | | | NW $\frac{1}{4}$ of NE $\frac{1}{4}$ | 2 |
| | | | | |
| | | | | |
| | | | | |
| | | | | |
| | | | | |
| | | | | |

(If more space required, attach separate sheet)

(a) Character of soil Chehalis

(b) Kind of crops raised Clover

POWER OR MINING PURPOSES—

10. (a) Total amount of power to be developed theoretical horsepower.

(b) Quantity of water to be used for power sec. ft.

(c) Total fall to be utilized feet.
(Head)

(d) The nature of the works by means of which the power is to be developed

(e) Such works to be located in of Sec.
(Legal subdivision)

Tp., R., W. M.
(No. N. or S.) (No. E. or W.)

(f) Is water to be returned to any stream?
(Yes or No)

(g) If so, name stream and locate point of return

....., Sec., Tp., R., W. M.
(No. N. or S.) (No. E. or W.)

(h) The use to which power is to be applied is

(i) The nature of the mines to be served

MUNICIPAL SUPPLY—

11. To supply the city of
 County, having a present population of
 (Name of)
 and an estimated population of in 192.....

(Answer questions 12, 13, 14, and 15 in all cases)

12. Estimated cost of proposed works, \$.....
 13. Construction work will begin on or before
 14. Construction work will be completed on or before
 15. The water will be completely applied to the proposed use on or before

H. O. Stults

(Name of applicant)

Signed in the presence of us as witnesses:

- (1) S. T. White
 (Name) (Address of witness)
 (2) W. E. Martin
 (Name) (Address of witness)

Remarks:

STATE OF OREGON, }
 County of Marion, } ss.

This is to certify that I have examined the foregoing application, together with the accompanying maps and data, and return the same for

In order to retain its priority, this application must be returned to the State Engineer, with corrections on or before, 192.....

WITNESS my hand this day of, 192.....

STATE ENGINEER

Application No. 13242

Permit No. 9488

PERMIT
TO APPROPRIATE THE PUBLIC
WATERS OF THE STATE
OF OREGON

Division No. District No.

*This instrument was first received in the
office of the State Engineer at Salem, Ore-*

gon, on the 21st day of Jan.

19230, at 8:00 o'clock A. M.

Returned to applicant:

Corrected application received:

Approved:

March 6, 1930

Recorded in book No. 31 of

Permits on page 9488

R H E A L U P E R

STATE ENGINEER

2 p. 51 c.

\$9.50

STATE OF OREGON, }
County of Marion, } ss.

PERMIT

This is to certify that I have examined the foregoing application and do hereby grant the same, subject to the following limitations and conditions:

The right herein granted is limited to the amount of water which can be applied to beneficial use and shall not exceed 0.38 cubic feet per second, or its equivalent in case of rotation with other water users, from Salt Creek, tributary of Yamhill River

The use to which this water is to be applied is Irrigation

If for irrigation, this appropriation shall be limited to 1/80th of one cubic foot per second or its equivalent for each acre irrigated and shall be subject to such reasonable rotation system as may be ordered by the proper state officer.

The priority date of this permit is January 21, 1930

Actual construction work shall begin on or before March 6, 1931 and shall thereafter be prosecuted with reasonable diligence and be completed on or before

October 1, 1932 Extended to Oct. 1, 1933
Extended to Oct. 1, 1934

Complete application of the water to the proposed use shall be made on or before

October 1, 1933

WITNESS my hand this 6th day of March, 19230

R H E A L U P E R

STATE ENGINEER.

Yamhill Co.

H.O. STUTTS
McMINNIE R.

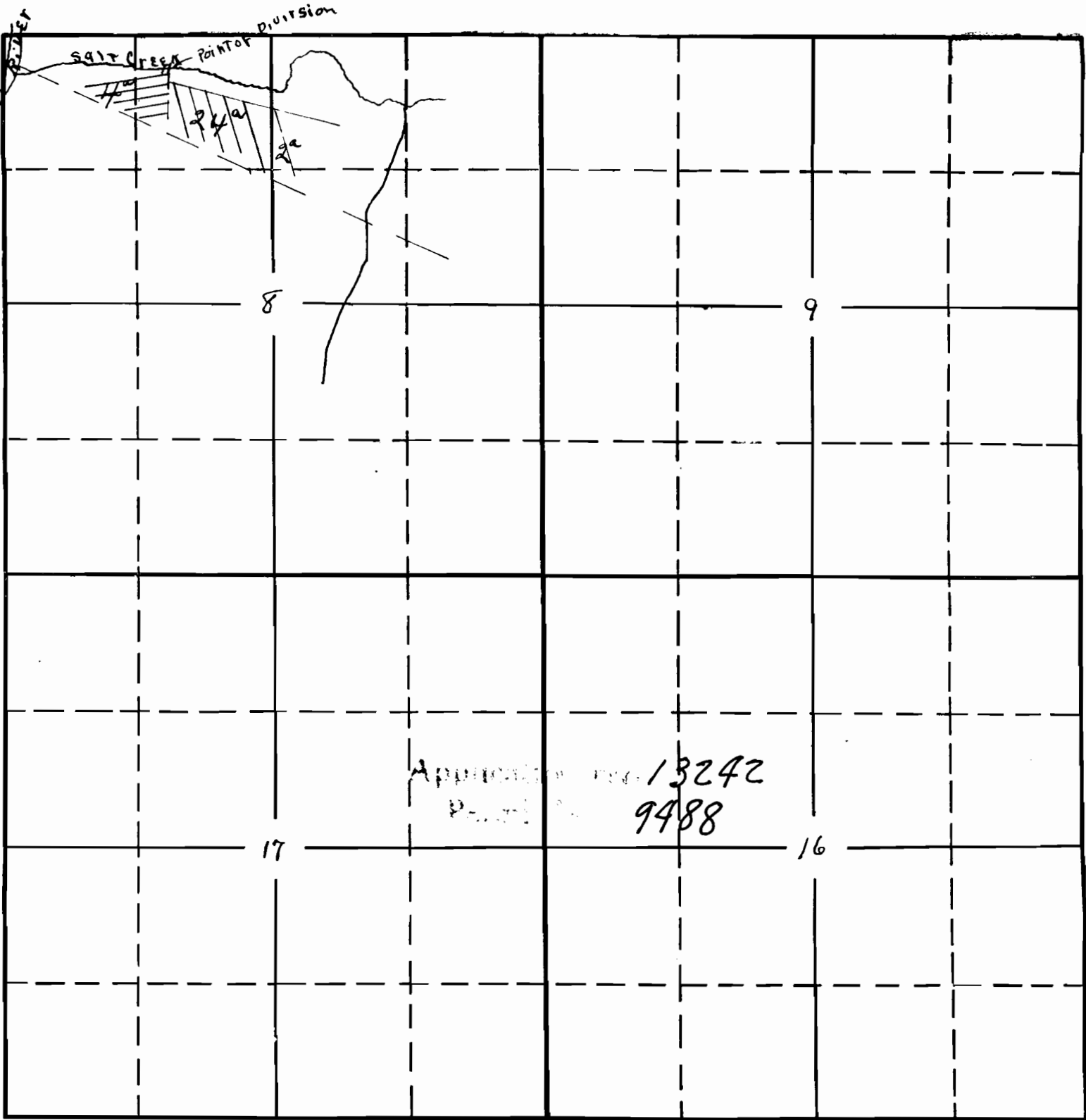

Sec. 8

Tp. 5 S.

R. 4 W.

Applicant No. 13242
Patent No. 9488

IN THE MATTER OF APPLICATION)
 FOR EXTENSION OF TIME TO COMPLETE)
 CONSTRUCTION WORK AND APPLY THE)
 WATER TO THE PROPOSED USE UNDER)
 STATE ENGINEER'S PERMITS.)

O R D E R

It appearing that good cause has been shown by the following permittees for the granting of extensions of time within which to complete their respective appropriations made under their permits, the following extensions of time were granted by the State Engineer:

| NAME | APP. NO. | PERMIT NO. | TO COMPLETE | TO APPLY |
|-------------------------------|-------------|---------------|-----------------|-----------------|
| F. W. Triska | U-20 | U-18 | October 1, 1933 | October 1, 1933 |
| Charles C. Richmond | U-21 | U-21 | October 1, 1933 | |
| Teel Irrigation Dist. | 415 | E-106 | October 1, 1937 | October 1, 1937 |
| Drewsey Reclamation Co. | 2384 | E-144 | October 1, 1933 | October 1, 1933 |
| Geo. A. Parker | 4944 | R-363 | October 1, 1933 | |
| Chas. E. Chevalley, et al | 4996 | R-367 | October 1, 1933 | |
| A. C. Lee | 7113 | R-477 | October 1, 1933 | |
| Chas. O. Maher | 7531 | R-501 | October 1, 1933 | |
| E. D. Lutz | 5047 | R-545 | October 1, 1934 | |
| S. E. Ross | 8339 | R-552 | October 1, 1933 | |
| U. S. Reclamation Service | 7526 | R-584 | October 1, 1942 | |
| Frank Calderwood | 12094 | R-604 | October 1, 1933 | |
| John McFall | 13450 | R-639 | October 1, 1933 | |
| Inland Power & Light Co. | 468 | 261 | October 1, 1934 | October 1, 1934 |
| Town of Paisley | 2771 | 1454 | October 1, 1937 | October 1, 1937 |
| Geo. A. Parker | 4045 | 2947 | October 1, 1933 | October 1, 1933 |
| Chas. E. Chevalley, et al | 4997 | 3008 | October 1, 1933 | October 1, 1933 |
| S. P. Morrison | 5214 | 3150 | October 1, 1933 | October 1, 1933 |
| Big Creek Ditch Co. | 6175 | 3852 | October 1, 1933 | October 1, 1933 |
| Big Creek Ditch Co. | 6521 | 4082 | October 1, 1933 | October 1, 1933 |
| Mark S. Mack | 6818 | 4263 | October 1, 1933 | October 1, 1933 |
| Bruce Locke | 7040 | 4409 | October 1, 1933 | October 1, 1933 |
| B. M. & L. H. Clute | 7144 | 4499 | October 1, 1933 | October 1, 1933 |
| A. C. Lee | 7111 | 4536 | October 1, 1933 | October 1, 1933 |
| Oregon State Fish & Game Com. | 6667 | 4638 | October 1, 1933 | October 1, 1933 |
| Meadows Drainage Dist. | 7535 | 4791 | October 1, 1933 | October 1, 1933 |
| Arthur M. Geary | 6587 | 4861 | October 1, 1933 | October 1, 1933 |
| C. C. Pursel | 7639 | 4909 | October 1, 1933 | October 1, 1933 |
| Chas. O. Maher | 7772 | 4964 | October 1, 1933 | October 1, 1933 |
| Peter S. Rice | 8216 | 5338 | October 1, 1933 | October 1, 1933 |
| John Lawless | 8321 | 5392 | October 1, 1933 | October 1, 1933 |
| H. V. Gates | 8392 | 5592 | July 1, 1934 | July 1, 1934 |
| James Z. Faucett | 8833 | 5779 | October 1, 1933 | October 1, 1933 |
| E. D. Lutz | 5048 | 5851 | October 1, 1934 | October 1, 1934 |
| O. W. Train | 9071 | 5971 | | October 1, 1933 |
| Chas. E. Hutchinson | 9113 | 5986 | | October 1, 1933 |
| F. M. Taylor | 9134 | 6022 | October 1, 1933 | October 1, 1933 |

| | | | | | |
|--------------------------------|-------|------|-----------------|-----------------|-----------------|
| S. L. Moss | | | | October 1, 1933 | October 1, 1933 |
| J. J. O'Dair | 8972 | 8041 | October 1, 1933 | October 1, 1933 | October 1, 1933 |
| Nelson Nye, et al | 7371 | 6119 | October 1, 1933 | October 1, 1933 | October 1, 1933 |
| Geo. W. H. Albert | 3406 | 6217 | | October 1, 1933 | October 1, 1933 |
| A. W. Thorpe & Lewis Tons | 3561 | 6225 | October 1, 1933 | October 1, 1933 | October 1, 1933 |
| U. S. Forest Service | 3400 | 6242 | October 1, 1933 | October 1, 1933 | October 1, 1933 |
| L. W. Magee | 9569 | 6323 | October 1, 1933 | October 1, 1933 | October 1, 1933 |
| Isaac D. Hunt | 3667 | 6420 | October 1, 1933 | October 1, 1933 | October 1, 1933 |
| O. W. Train | 3731 | 5690 | | October 1, 1933 | October 1, 1933 |
| City of Tillamook | 3415 | 6673 | October 1, 1941 | October 1, 1941 | October 1, 1941 |
| Miriam Sheldon Ripley | 10233 | 6779 | October 1, 1933 | October 1, 1933 | October 1, 1933 |
| A. L. Aikins | 10206 | 6860 | October 1, 1933 | October 1, 1933 | October 1, 1933 |
| J. B. & Floyd E. Hart | 10365 | 6948 | October 1, 1933 | October 1, 1933 | October 1, 1933 |
| W. A. Brown | 10409 | 6965 | October 1, 1933 | October 1, 1933 | October 1, 1933 |
| Estate of James Pelton | 9909 | 6981 | | October 1, 1933 | October 1, 1933 |
| Alfons Mayens | 10556 | 7140 | October 1, 1933 | October 1, 1933 | October 1, 1933 |
| Henry Geo. A. Steger | 10582 | 7164 | October 1, 1933 | October 1, 1933 | October 1, 1933 |
| M. A. Pierson | 10576 | 7176 | October 1, 1933 | October 1, 1933 | October 1, 1933 |
| Myrtle A. Miles | 10691 | 7269 | October 1, 1933 | October 1, 1933 | October 1, 1933 |
| Louis E. Springer, et al | 10796 | 7345 | | October 1, 1933 | October 1, 1933 |
| U. S. Reclamation Bureau | 9668 | 7400 | October 1, 1942 | October 1, 1942 | October 1, 1942 |
| I. P. & C. R. Crist | 10911 | 7454 | October 1, 1933 | October 1, 1933 | October 1, 1933 |
| Delbert Harrington | 10939 | 7473 | | October 1, 1933 | October 1, 1933 |
| J. H. Davenport | 10984 | 7483 | October 1, 1933 | October 1, 1933 | October 1, 1933 |
| Edw. F. Smith | 11112 | 7551 | October 1, 1933 | October 1, 1933 | October 1, 1933 |
| Frank Cook | 11134 | 7608 | October 1, 1933 | October 1, 1933 | October 1, 1933 |
| J. A. Worthington | 11342 | 7798 | October 1, 1933 | October 1, 1933 | October 1, 1933 |
| City of Seaside | 11403 | 7863 | October 1, 1933 | | |
| J. J. Meredith | 11408 | 7870 | October 1, 1933 | October 1, 1933 | October 1, 1933 |
| Mary A. Siddons | 11459 | 7919 | October 1, 1933 | October 1, 1933 | October 1, 1933 |
| Oregon Agricultural College | 11347 | 7943 | October 1, 1933 | October 1, 1933 | October 1, 1933 |
| A. D. Penrod | 11503 | 7957 | October 1, 1933 | October 1, 1933 | October 1, 1933 |
| Mabel Botkin | 11575 | 7977 | October 1, 1933 | October 1, 1933 | October 1, 1933 |
| D. Cuniff, Deceased | 11567 | 8010 | October 1, 1933 | October 1, 1933 | October 1, 1933 |
| Maud P. Wright | 11576 | 8012 | October 1, 1933 | October 1, 1933 | October 1, 1933 |
| H. L. Carl | 11597 | 8095 | October 1, 1933 | October 1, 1933 | October 1, 1933 |
| City of Astoria | 11632 | 8096 | | October 1, 1933 | October 1, 1933 |
| Powell Bros. | 11766 | 8176 | October 1, 1933 | October 1, 1933 | October 1, 1933 |
| Oscar Head | 11826 | 8227 | October 1, 1933 | October 1, 1933 | October 1, 1933 |
| C. E. Pratt | 11327 | 8275 | October 1, 1933 | October 1, 1933 | October 1, 1933 |
| Harold E. & Mable Wooster | 11932 | 8306 | October 1, 1933 | October 1, 1933 | October 1, 1933 |
| W. M. & Ruby G. Hartford | 11936 | 8326 | October 1, 1933 | October 1, 1933 | October 1, 1933 |
| Johnson Mountain Mining Co. | 11939 | 8327 | October 1, 1933 | October 1, 1933 | October 1, 1933 |
| Johnson Mountain Mining Co. | 11940 | 8328 | October 1, 1933 | October 1, 1933 | October 1, 1933 |
| Walter W. & Bertha A. Thiedell | 11943 | 8331 | October 1, 1933 | October 1, 1933 | October 1, 1933 |
| Leo Scherzinger | 11960 | 8395 | October 1, 1933 | October 1, 1933 | October 1, 1933 |
| S. H. Robison | 13176 | 8414 | October 1, 1933 | | |
| J. P. Egan | 12024 | 8432 | October 1, 1933 | October 1, 1933 | October 1, 1933 |
| Frank Calderwood | 12095 | 8506 | October 1, 1933 | October 1, 1933 | October 1, 1933 |
| H. B. Pierce | 12214 | 8564 | October 1, 1933 | October 1, 1933 | October 1, 1933 |
| Raphael S. Leonard | 12219 | 8568 | October 1, 1933 | October 1, 1933 | October 1, 1933 |
| Chas. Shelton | 12171 | 8572 | October 1, 1933 | October 1, 1933 | October 1, 1933 |
| Sam H. Webb | 12182 | 8577 | October 1, 1933 | October 1, 1933 | October 1, 1933 |
| Blanche E. Kirkpatrick | 12152 | 8584 | October 1, 1933 | October 1, 1933 | October 1, 1933 |
| Frank Roberts | 12018 | 8605 | October 1, 1933 | October 1, 1933 | October 1, 1933 |
| E. P. Blundell | 12194 | 8613 | October 1, 1933 | October 1, 1933 | October 1, 1933 |
| Vincent K. Holcomb | 12286 | 8668 | October 1, 1933 | October 1, 1933 | October 1, 1933 |
| Ladd & Bush Trust Co. | 12325 | 8678 | October 1, 1933 | October 1, 1933 | October 1, 1933 |
| R. F. Congdon | 12320 | 8685 | October 1, 1933 | October 1, 1933 | October 1, 1933 |
| John Nachter, Sr. | 12329 | 8695 | October 1, 1933 | October 1, 1933 | October 1, 1933 |
| Lewis W. Pitts | 12172 | 8705 | October 1, 1933 | October 1, 1933 | October 1, 1933 |
| A. D. Weir | 12331 | 8733 | October 1, 1933 | October 1, 1933 | October 1, 1933 |
| Willard D. Hess | 12341 | 8734 | October 1, 1933 | October 1, 1933 | October 1, 1933 |
| O. R. Gullion | 12366 | 8738 | October 1, 1933 | October 1, 1933 | October 1, 1933 |
| J. W. Fronk | 12387 | 8744 | October 1, 1933 | October 1, 1933 | October 1, 1933 |
| Oregon Copper Co. | 12246 | 8747 | October 1, 1933 | October 1, 1933 | October 1, 1933 |

| | | | | |
|-------------------------------|-------|------|-----------------|-----------------|
| B. I. Allen | 12392 | 8750 | October 1, 1933 | October 1, 1933 |
| J. B. Bristow | 12434 | 8776 | October 1, 1933 | October 1, 1933 |
| John Arnold | 12238 | 8786 | October 1, 1933 | October 1, 1933 |
| Edwin C. Bowen, et al | 12394 | 8793 | October 1, 1933 | October 1, 1933 |
| Harvey F. Ewens | 12398 | 8794 | October 1, 1933 | October 1, 1933 |
| Melvin M. Couch | 12410 | 8796 | October 1, 1933 | October 1, 1933 |
| C. E. Pullen | 12468 | 8817 | October 1, 1933 | October 1, 1933 |
| E. J. Laughlin | 12440 | 8801 | October 1, 1933 | October 1, 1933 |
| J. E. Tavenner | 12406 | 8836 | | October 1, 1933 |
| Wapato Farm Co. | 12500 | 8849 | October 1, 1933 | October 1, 1933 |
| V. W. Badley | 12513 | 8869 | October 1, 1933 | October 1, 1933 |
| Geo. S. & Temperence Campbell | 12555 | 8941 | October 1, 1933 | October 1, 1933 |
| John McFall | 12625 | 8976 | October 1, 1933 | October 1, 1933 |
| Victor Butler | 12658 | 8998 | | October 1, 1933 |
| Carl Hansen | 12672 | 9005 | October 1, 1933 | October 1, 1933 |
| E. J. Berneche | 12684 | 9036 | October 1, 1933 | October 1, 1933 |
| Louise Crow | 12711 | 9046 | October 1, 1933 | October 1, 1933 |
| Spencer W. Dunn | 12693 | 9050 | October 1, 1933 | October 1, 1933 |
| L. E. Gulker | 12743 | 9066 | October 1, 1933 | October 1, 1933 |
| Elmer Neiman | 12776 | 9084 | October 1, 1933 | October 1, 1933 |
| Frank Meredith | 9088 | 9091 | October 1, 1933 | October 1, 1933 |
| E. Beard | 12783 | 9098 | October 1, 1933 | October 1, 1933 |
| Daniel Rees | 12792 | 9145 | October 1, 1933 | October 1, 1933 |
| C. T. & Adrienne Steward | 12804 | 9149 | October 1, 1933 | October 1, 1933 |
| Leo D. Cook | 12827 | 9192 | October 1, 1933 | October 1, 1933 |
| E. F. Swingle | 12762 | 9251 | October 1, 1933 | October 1, 1933 |
| Fred Southworth | 12944 | 9265 | October 1, 1933 | October 1, 1933 |
| Martha A. Roberts | 12952 | 9267 | October 1, 1933 | October 1, 1933 |
| Geo. Allgeier | 12988 | 9275 | October 1, 1933 | October 1, 1933 |
| Guy C. Coon | 13004 | 9282 | October 1, 1933 | October 1, 1933 |
| A. S. Pattullo | 13005 | 9283 | October 1, 1933 | October 1, 1933 |
| Naomi Morton | 13011 | 9287 | October 1, 1933 | October 1, 1933 |
| Isabella Steed | 13024 | 9294 | | October 1, 1933 |
| B. J. Palmer | 13039 | 9298 | October 1, 1933 | October 1, 1933 |
| A. O. Fauske | 13070 | 9315 | October 1, 1933 | October 1, 1933 |
| E. E. Ridgway | 13082 | 9320 | October 1, 1933 | October 1, 1933 |
| John Arnold | 12989 | 9341 | October 1, 1933 | October 1, 1933 |
| Laurence Dailey | 12990 | 9342 | | October 1, 1933 |
| E. T. Bateson | 13057 | 9349 | October 1, 1933 | October 1, 1933 |
| R. C. Miller | 13095 | 9353 | October 1, 1933 | October 1, 1933 |
| Chas. C. Richmond | 12882 | 9369 | October 1, 1933 | |
| Wm. B. McCullough | 12980 | 9373 | October 1, 1933 | |
| Ed Backleff | 13136 | 9390 | October 1, 1933 | |
| Mrs. Chas. W. Lewis | 13155 | 9402 | October 1, 1933 | |
| Frank Laduron | 13172 | 9412 | October 1, 1933 | |
| F. J. Rice | 13177 | 9415 | October 1, 1933 | |
| E. L. Cockle | 13236 | 9420 | October 1, 1933 | |
| F. W. Blondell | 13162 | 9428 | October 1, 1933 | |
| C. F. St. Sure | 13185 | 9436 | October 1, 1933 | |
| Jacob Van Well | 13191 | 9442 | October 1, 1933 | |
| Henry J. Swain | 13220 | 9459 | October 1, 1933 | |
| H. O. Stults | 13242 | 9488 | October 1, 1933 | |
| A. A. Johnson | 13249 | 9493 | October 1, 1933 | |
| E. M. Porter | 13254 | 9497 | October 1, 1933 | |
| C. W. Atkins | 13257 | 9498 | October 1, 1933 | |
| E. Allen Lee | 13262 | 9500 | October 1, 1933 | |
| F. A. Carlson | 13265 | 9502 | October 1, 1933 | |
| Ralph R. Wolf | 13281 | 9530 | October 1, 1933 | |
| J. E. Marks | 13299 | 9540 | October 1, 1933 | |
| Henry F. Winters | 13309 | 9550 | October 1, 1933 | |
| Cyrus Williams | 13311 | 9552 | October 1, 1933 | |
| Chas. Peterson | 13326 | 9562 | October 1, 1933 | |
| F. M. Stover | 13334 | 9566 | October 1, 1933 | |
| Ada Fulgham | 13340 | 9571 | October 1, 1933 | |
| Ernest C. Hostutler | 13347 | 9575 | October 1, 1933 | |
| Paul S. Corrigan | 13356 | 9601 | October 1, 1933 | |

| | | | | |
|-------------------------------------|-------|------|-----------------|-----------------|
| C. W. & Emily Brookens | 13379 | 9608 | October 1, 1933 | |
| T. A. Coffin | 13402 | 9621 | October 1, 1933 | |
| R. R. Thompson | 13409 | 9624 | October 1, 1933 | |
| J. H. & Lucy Martinson | 13448 | 9657 | October 1, 1933 | |
| J. B. Wolters | 13467 | 9670 | October 1, 1934 | October 1, 1934 |
| Emil Fitze | 13496 | 9689 | October 1, 1933 | |
| Wm. Wager | 13335 | 9695 | October 1, 1933 | |
| A. D. Weir | 13532 | 9698 | October 1, 1933 | |
| F. T. Small | 13147 | 9702 | October 1, 1933 | |
| William Briot | 13540 | 9726 | October 1, 1934 | October 1, 1934 |
| Otis J. Elliott, et al | 13399 | 9738 | October 1, 1933 | |
| Earl Rankin | 13558 | 9748 | October 1, 1933 | |
| Leo E. Johnson | 13581 | 9752 | October 1, 1933 | |
| Claude Moisington | 13651 | 9778 | October 1, 1933 | |
| Ernest D. Moisington | 13652 | 9779 | October 1, 1933 | |
| George A. Thies | 13663 | 9786 | October 1, 1933 | |
| Geo. W. Ferrey | 13616 | 9805 | October 1, 1933 | |
| Wm. E. Yates | 13680 | 9819 | October 1, 1933 | |
| John McFall | 13451 | 9830 | October 1, 1933 | |
| William H. Hess | 13635 | 9834 | October 1, 1933 | |
| Oregon Light, Pow. & Irr. Co. | 13664 | 9836 | October 1, 1933 | |
| Floyd E. Blackburn | 13744 | 9857 | October 1, 1933 | |
| Gold Beach Water, Light & Power Co. | 13600 | 9862 | October 1, 1933 | |
| H. F. Fleming | 13657 | 9865 | October 1, 1933 | |
| L. F. Wilkes | 13698 | 9871 | October 1, 1933 | |
| W. S. Stringer | 13756 | 9889 | October 1, 1933 | |
| W. S. Walton | 13761 | 9893 | October 1, 1933 | |
| W. T. & Lucy Foster | 13768 | 9896 | October 1, 1933 | |
| Crossett Western Co. | 13782 | 9905 | October 1, 1933 | |
| Fred E. Werth | 13788 | 9908 | October 1, 1933 | |
| Methodist Episcopal Church | 13798 | 9914 | October 1, 1933 | |
| H. D. Bondy | 13480 | 9928 | October 1, 1933 | |
| E. M. Boothby | 13571 | 9931 | October 1, 1933 | |
| Percy Bitter | 13611 | 9932 | October 1, 1933 | |
| C. E. Haywood | 13814 | 9949 | October 1, 1933 | |
| Theodore Dickmann | 13867 | 9974 | October 1, 1933 | |

THEFORE, IT IS ORDERED that the extensions of time as above tabulated be and the same are hereby granted.

Dated at Salem, Oregon, this 9th day of January, 1933.

CHAS. F. STRICKLIN, State Engineer.

IN THE MATTER OF APPLICATION FOR
EXTENSION OF TIME TO COMPLETE CON-
STRUCTION WORK AND APPLY THE WATER
TO THE PROPOSED USE UNDER STATE
ENGINEER'S PERMITS.

O R D E R

It appearing that good cause has been shown by the following
permittees for the granting of extensions of time within which to complete
their respective appropriations made under their permits, the following
extensions of time were granted by the State Engineer:

| NAME | App. No. | PERMIT NO. | TO COMPLETE | TO APPLY |
|--------------------------------|-------------|---------------|-------------------|-----------------|
| H. H. Hawkins | U-9 | U-9 | October 1, 1934 | October 1, 1934 |
| John W. Mills | U-19 | U-19 | | October 1, 1934 |
| Chas. C. Richmond | U-21 | U-21 | October 1, 1934 | October 1, 1934 |
| E. C. Fitzgerald | U-34 | U-29 | October 1, 1935 | October 1, 1935 |
| O. I. Hittle | U-45 | U-40 | | October 1, 1934 |
| J. S. Cook | U-49 | U-42 | October 1, 1934 | |
| James C. Drewitt | U-67 | U-60 | October 1, 1934 | |
| Rogue River Valley Irr. Dist. | | | | |
| & Medford Irr. Dist. | 194 | E-19 | October 1, 1934 | October 1, 1934 |
| Geo. A. Parker | 4944 | R-363 | October 1, 1934 | |
| Holloway Bros. | 5192 | R-409 | October 1, 1934 | |
| A. C. Lee | 7113 | R-477 | October 1, 1934 | |
| Eagle Valley Irr. Co. | 6264 | R-491 | October 1, 1934 | |
| Chas. O. Maher | 7531 | R-501 | November 10, 1933 | |
| S. E. Ross | 8339 | R-552 | October 1, 1934 | |
| Victor Neault | 10510 | R-578 | October 1, 1934 | |
| S. S. Williams | 11019 | R-582 | October 1, 1934 | |
| Roy N. Bostwick | 12627 | R-620 | October 1, 1934 | |
| Clifford T. Schramneck | 12841 | R-624 | October 1, 1934 | |
| Ralph Barker | 13247 | R-631 | October 1, 1934 | |
| Ethel Green | 13288 | R-636 | October 1, 1934 | |
| Scott Conley Davis | 13314 | R-645 | October 1, 1934 | |
| Alvin M. Ohms | 13568 | R-646 | October 1, 1934 | |
| M. S. B. vee | 13995 | R-647 | October 1, 1934 | |
| The Oregon Iron & Steel Co. | 14236 | R-649 | October 1, 1934 | |
| Homer H. Huffman | 14257 | R-650 | October 1, 1934 | |
| E. Oke Henderson | 14437 | R-653 | October 1, 1934 | |
| Rogue River Valley Irr. Dist. | | | | |
| & Medford Irr. Dist. | 589 | 407 | October 1, 1934 | October 1, 1934 |
| Talent Irrigation Dist. | 2325 | 1382 | | October 1, 1934 |
| Talent Irrigation Dist. | 2326 | 1383 | | October 1, 1934 |
| Rogue River Valley Irr. Dist. | | | | |
| & Medford Irr. Dist. | 3036 | 1705 | October 1, 1934 | October 1, 1934 |
| Rogue River Valley Irr. Dist. | | | | |
| & Medford Irrigation Dist. | 3040 | 1706 | October 1, 1934 | October 1, 1934 |
| * Goose Lake Valley Irr. Dist. | 3928 | 2186 | | October 1, 1938 |
| Rogue River Valley Irr. Dist. | | | | |
| & Medford Irr. Dist. | 4139 | 2382 | October 1, 1934 | October 1, 1934 |
| Geo. A. Parker | 4945 | 2947 | October 1, 1934 | October 1, 1934 |
| Rogue River Valley Irr. Dist. | | | | |
| & Medford Irr. Dist. | 4903 | 2993 | October 1, 1934 | October 1, 1934 |
| Jordan Valley Cattle Co. | 5299 | 3247 | October 1, 1934 | October 1, 1934 |

| | | | | |
|-------------------------------|-------|------|-------------------|-------------------|
| City of Gold Hill | 5410 | 3275 | October 1, 1936 | October 1, 1936 |
| Perry A. South | 5531 | 3371 | October 1, 1934 | October 1, 1934 |
| Big Creek Pitch Co. | 6175 | 3852 | October 1, 1934 | October 1, 1934 |
| City of Dallas | 6385 | 4053 | October 1, 1942 | October 1, 1942 |
| Big Creek Pitch Co. | 6521 | 4082 | October 1, 1934 | October 1, 1934 |
| W. O. Kohler | 7034 | 4449 | October 1, 1934 | October 1, 1934 |
| B. M. & L. H. Clute | 7144 | 4499 | October 1, 1934 | October 1, 1934 |
| A. C. Lee | 7111 | 4536 | October 1, 1934 | October 1, 1934 |
| Talent Irr. Dist. | 4434 | 4537 | | October 1, 1934 |
| Eagle Valley Irr. Co. | 6730 | 4826 | October 1, 1934 | October 1, 1934 |
| Z. F. Antrim | 7580 | 4852 | | October 1, 1934 |
| Arthur M. Geary | 6387 | 4861 | October 1, 1934 | October 1, 1934 |
| Rogue River Valley Irr. Dist. | 77552 | | | |
| & Medford Irr. Dist. | 7353 | | | |
| | 7354 | | | |
| | 7355 | 4951 | October 1, 1934 | October 1, 1934 |
| Chas. C. Maher | 7772 | 4964 | November 10, 1933 | November 10, 1933 |
| T. C. Murray | 7832 | 5013 | October 1, 1934 | October 1, 1934 |
| Federal Land Bank of Spokane | 8109 | 5235 | October 1, 1934 | October 1, 1934 |
| John Lawless | 8321 | 5392 | October 1, 1934 | October 1, 1934 |
| H. E. Wehr | 8323 | 5394 | October 1, 1934 | October 1, 1934 |
| Pete Mann Irr. Co. | 7739 | 5733 | October 1, 1934 | October 1, 1934 |
| Wm. V. Sample | 9133 | 5993 | October 1, 1934 | October 1, 1934 |
| F. M. Taylor | 9144 | 6022 | October 1, 1934 | October 1, 1934 |
| S. E. Ross | 8340 | 6029 | October 1, 1934 | October 1, 1934 |
| Ed A. & Elva Smith | 9072 | 6030 | October 1, 1934 | October 1, 1934 |
| Ira Lemmon | 9306 | 6156 | October 1, 1934 | October 1, 1934 |
| Geo. W. H. Albert | 9406 | 6217 | October 1, 1934 | October 1, 1934 |
| E. W. Chandler | 9361 | 6225 | October 1, 1934 | October 1, 1934 |
| Mrs. Sarah M. Obrist | 9589 | 6227 | October 1, 1934 | October 1, 1934 |
| John C. Stille | 9514 | 6297 | October 1, 1934 | October 1, 1934 |
| Eldena M. Earl | 9747 | 6444 | October 1, 1934 | October 1, 1934 |
| J. Carl & Blanch Williams | 9974 | 6617 | October 1, 1934 | October 1, 1934 |
| A. L. Aikins | 10206 | 6860 | October 1, 1934 | October 1, 1934 |
| W. A. Brown | 10409 | 6965 | October 1, 1934 | October 1, 1934 |
| Estate of James Pelton | 9909 | 6981 | | October 1, 1934 |
| S. L. Knight | 10091 | 7136 | October 1, 1934 | October 1, 1934 |
| M. A. Pierson | 10576 | 7176 | October 1, 1934 | October 1, 1934 |
| Ruth Latourette Eaton | 10613 | 6223 | October 1, 1934 | October 1, 1934 |
| Victor Nault | 10511 | 7240 | October 1, 1934 | October 1, 1934 |
| John J. Rathkey | 10661 | 7296 | | October 1, 1934 |
| James W. Ford, Jr. | 10773 | 7348 | October 1, 1934 | October 1, 1934 |
| S. S. Williams | 10020 | 7351 | October 1, 1934 | October 1, 1934 |
| Delbert Harrington | 10939 | 7473 | October 1, 1934 | October 1, 1934 |
| Edward F. Smith | 1112 | 7581 | October 1, 1934 | October 1, 1934 |
| Wm. W. Brown | 11317 | 7809 | | October 1, 1934 |
| H. Rettig | 11387 | 7850 | October 1, 1934 | October 1, 1934 |
| Liberal Water Co. | 10652 | 7852 | October 1, 1934 | October 1, 1934 |
| City of Seaside | 11403 | 7863 | October 1, 1934 | October 1, 1934 |
| Geo. A. Mitsch | 11448 | 7909 | October 1, 1934 | October 1, 1934 |
| Mary A. Siddons | 11459 | 7919 | | October 1, 1934 |
| Ore. State College | 11347 | 7943 | October 1, 1934 | October 1, 1934 |
| A. D. Penrod | 11503 | 7957 | October 1, 1934 | October 1, 1934 |
| Mabel Botkin | 11575 | 7977 | October 1, 1934 | October 1, 1934 |
| Geo. W. Betts | 11247 | 7983 | October 1, 1934 | October 1, 1934 |
| Maud P. Wright | 11576 | 8012 | October 1, 1934 | October 1, 1934 |
| Clyde Thomas | 11303 | 8013 | October 1, 1934 | October 1, 1934 |
| Geo. W. Betts | 11633 | 8067 | October 1, 1934 | October 1, 1934 |
| W. F. Reed | 11635 | 8080 | October 1, 1934 | October 1, 1934 |
| H. L. Carl | 11597 | 8095 | October 1, 1934 | October 1, 1934 |
| City of Astoria | 11632 | 8096 | | October 1, 1938 |

| | | | | |
|---|-------|------|-----------------|-----------------|
| Gerda Olsen & Adeline Williams | 11729 | 8140 | October 1, 1934 | October 1, 1934 |
| H. F. Campion | 11774 | 8182 | October 1, 1934 | October 1, 1934 |
| Fred D. & Alva R. Miller | 11780 | 8188 | October 1, 1934 | October 1, 1934 |
| Oscar Head | 11826 | 8227 | October 1, 1934 | October 1, 1934 |
| Harold E. & Mable A. Wooster | 11932 | 8306 | October 1, 1934 | October 1, 1934 |
| Mrs. Isabelle Howell | 11929 | 8324 | October 1, 1934 | October 1, 1934 |
| W. M. & Ruby G. Hartford | 11936 | 8326 | October 1, 1934 | October 1, 1934 |
| Johnson Mountain Mining Co. | 11939 | 8327 | October 1, 1934 | October 1, 1934 |
| Johnson Mountain Mining Co. | 11940 | 8328 | October 1, 1934 | October 1, 1934 |
| Walter W. & Bertha A. Thiede | 11943 | 8331 | October 1, 1934 | October 1, 1934 |
| Leo Scherzinger | 11960 | 8395 | October 1, 1934 | October 1, 1934 |
| J. P. Egan | 12024 | 8432 | | October 1, 1934 |
| John W. & Nina C. Wynn | 11262 | 8460 | | October 1, 1934 |
| Raphael S. Leonard | 12219 | 8568 | October 1, 1934 | October 1, 1934 |
| Blanche E. Kirkpatrick | 12152 | 8584 | October 1, 1934 | October 1, 1934 |
| Dick Koopman, Floyd Pollard and E. K. Greener | 10833 | 8603 | October 1, 1934 | October 1, 1934 |
| Frank Roberts | 12018 | 8605 | October 1, 1934 | October 1, 1934 |
| E. P. Blundell | 12194 | 8613 | October 1, 1934 | October 1, 1934 |
| T. E. Nye | 12309 | 8678 | October 1, 1934 | October 1, 1934 |
| R. F. Congdon | 12320 | 8685 | October 1, 1934 | October 1, 1934 |
| Lewis W. Pitts | 12172 | 8705 | October 1, 1934 | October 1, 1934 |
| S. F. Clodfelter | 12257 | 8709 | October 1, 1934 | October 1, 1934 |
| Harry L. & Ralph F. White | 12357 | 8721 | October 1, 1934 | October 1, 1934 |
| Willard D. Hess | 12341 | 8734 | October 1, 1934 | October 1, 1934 |
| O. R. Gullion | 12366 | 8738 | October 1, 1934 | October 1, 1934 |
| J. W. Fronk | 12387 | 8744 | October 1, 1934 | October 1, 1934 |
| Omar C. Conger | 12420 | 8765 | October 1, 1934 | October 1, 1934 |
| J. B. Bristow | 12434 | 8776 | October 1, 1934 | October 1, 1934 |
| John Arnold | 12238 | 8786 | October 1, 1934 | October 1, 1934 |
| Edwin G. Bowen & Kenneth W. Robertson | 12394 | 8793 | October 1, 1934 | October 1, 1934 |
| Harvey E. Ewens | 12398 | 8794 | October 1, 1934 | October 1, 1934 |
| Melvin M. Couch | 12410 | 8796 | October 1, 1934 | October 1, 1934 |
| E. J. Laughlin | 12440 | 8801 | October 1, 1934 | October 1, 1934 |
| Wapato Farm Co. | 12500 | 8849 | October 1, 1934 | October 1, 1934 |
| V. W. Bodley | 12513 | 8869 | October 1, 1934 | October 1, 1934 |
| Edward E. Bond | 12552 | 8910 | October 1, 1934 | October 1, 1934 |
| Geo. S. & Temperance Campbell | 12555 | 8941 | October 1, 1934 | October 1, 1934 |
| Hulda J. Armstrong | 12592 | 8957 | October 1, 1934 | October 1, 1934 |
| R. B. Vincent | 12733 | 9060 | October 1, 1934 | October 1, 1934 |
| Mrs. H. J. Neiman | 12775 | 9083 | October 1, 1934 | October 1, 1934 |
| Elmer Neiman | 12776 | 9084 | October 1, 1934 | October 1, 1934 |
| Frank Meredith | 9088 | 9091 | October 1, 1934 | October 1, 1934 |
| Mt. Hood Investment Co. | 12785 | 9099 | October 1, 1934 | October 1, 1934 |
| Roy N. Bostwick | 12628 | 9109 | October 1, 1934 | October 1, 1934 |
| W. C. Runyan | 12790 | 9144 | October 1, 1934 | October 1, 1934 |
| C. T. & Adrienne Steward | 12804 | 9149 | October 1, 1934 | October 1, 1934 |
| J. W. Nance | 12993 | 9239 | October 1, 1934 | October 1, 1934 |
| Ralph E. Gilchrist | 12972 | 9240 | October 1, 1934 | October 1, 1934 |
| Ralph E. Gilchrist | 12971 | 9241 | October 1, 1934 | October 1, 1934 |
| Clifford T. Schrammeck | 12842 | 9254 | October 1, 1934 | October 1, 1934 |
| Guy C. Coon | 13004 | 3282 | October 1, 1934 | October 1, 1934 |
| A. S. Pattullo | 13005 | 9283 | | October 1, 1934 |
| Lars Berg | 13053 | 9307 | October 1, 1934 | October 1, 1934 |
| A. O. Fauske | 13070 | 9315 | October 1, 1934 | October 1, 1934 |
| John Arnold | 12989 | 9341 | October 1, 1934 | October 1, 1934 |
| Lawrence Dailey | 12990 | 9342 | | October 1, 1934 |
| E. T. Bateson | 13057 | 9349 | October 1, 1934 | October 1, 1934 |
| R. C. Miller | 13095 | 9353 | October 1, 1934 | October 1, 1934 |

| | | | | |
|-------------------------------------|-------|------|-----------------|-----------------|
| Wm. D. McCullough | 12980 | 9375 | October 1, 1934 | October 1, 1934 |
| Ed L. Bryan | 13054 | 9379 | October 1, 1934 | October 1, 1934 |
| L. H. Potter et al | 13135 | 9388 | October 1, 1934 | October 1, 1934 |
| Ed Rackleff | 13136 | 9390 | October 1, 1934 | October 1, 1934 |
| Oral M. & John Stormer | 13154 | 9401 | October 1, 1934 | October 1, 1934 |
| Mrs. C. W. Lewis | 13155 | 9402 | October 1, 1934 | October 1, 1934 |
| Frank Laduron | 13172 | 9412 | October 1, 1934 | October 1, 1934 |
| Walter W. Russell | 13173 | 9413 | | October 1, 1934 |
| S. H. Robison | 13176 | 9414 | October 1, 1934 | October 1, 1934 |
| Ralph Barker | 13167 | 9429 | October 1, 1934 | October 1, 1934 |
| Jacob Van Well | 13191 | 9442 | October 1, 1934 | October 1, 1934 |
| Joseph A. Banasco | 13203 | 9450 | | October 1, 1934 |
| Geo. Saum | 13228 | 9461 | October 1, 1934 | October 1, 1934 |
| Alfred G. & Gladys B. Olsen | 13202 | 9478 | | October 1, 1934 |
| G. E. Endicott | 13236 | 9485 | October 1, 1934 | October 1, 1934 |
| H. C. Stults | 13242 | 9488 | October 1, 1934 | October 1, 1934 |
| A. A. Johnson | 13249 | 9493 | October 1, 1934 | October 1, 1934 |
| M. M. Porter | 13254 | 9497 | October 1, 1934 | October 1, 1934 |
| G. E. Aikins | 13257 | 9498 | October 1, 1934 | October 1, 1934 |
| R. Allen Lee | 13262 | 9500 | October 1, 1934 | October 1, 1934 |
| F. A. Carlson | 13265 | 9502 | October 1, 1934 | October 1, 1934 |
| A. D. Shevlin | 12799 | 9516 | October 1, 1934 | October 1, 1934 |
| Ethel Green | 13289 | 9533 | October 1, 1934 | October 1, 1934 |
| R. A. Coolidge | 13293 | 9536 | October 1, 1934 | October 1, 1934 |
| Henry F. Winters | 13309 | 9550 | October 1, 1934 | October 1, 1934 |
| Ada Fulgham | 13340 | 9571 | | October 1, 1934 |
| C. J. Haas | 13351 | 9600 | October 1, 1934 | October 1, 1934 |
| John Amacher | 13356 | 9601 | October 1, 1934 | October 1, 1934 |
| N. A. Peterson | 13460 | 9664 | October 1, 1934 | October 1, 1934 |
| Foster Winslow | 13462 | 9666 | October 1, 1934 | October 1, 1934 |
| Emil Fitze | 13496 | 9689 | October 1, 1934 | October 1, 1934 |
| W. T. Small | 13147 | 9702 | October 1, 1934 | October 1, 1934 |
| Emil A. Johnson | 13455 | 9704 | October 1, 1934 | October 1, 1934 |
| Herbert L. Crissom | 13504 | 9712 | | October 1, 1934 |
| W. B. Frink | 13505 | 9713 | October 1, 1934 | October 1, 1934 |
| Roscoe R. Mitchell | 13520 | 9715 | October 1, 1934 | October 1, 1934 |
| Henry F. Cabell | 13559 | 9737 | October 1, 1934 | October 1, 1934 |
| Otis J. Elliott et al | 13399 | 9738 | October 1, 1934 | October 1, 1934 |
| Leo H. Johnson | 13581 | 9752 | October 1, 1934 | October 1, 1934 |
| Russell O. Reed | 13589 | 9757 | October 1, 1934 | October 1, 1934 |
| Glenn Green | 13601 | 9764 | October 1, 1934 | October 1, 1934 |
| Gardner Bros. | 13650 | 9777 | October 1, 1934 | October 1, 1934 |
| A. E. Carey | 13653 | 9780 | October 1, 1934 | October 1, 1934 |
| George A. Thies | 13663 | 9786 | October 1, 1934 | October 1, 1934 |
| Perry Murray & Clara H. Beggs | 13667 | 9788 | October 1, 1934 | October 1, 1934 |
| John R. & Florence Hill | 13575 | 9794 | October 1, 1934 | October 1, 1934 |
| Geo. W. Ferrey | 13616 | 9805 | October 1, 1934 | October 1, 1934 |
| Harold J. Hansen | 13622 | 9806 | October 1, 1934 | October 1, 1934 |
| Wm. M. Yates | 13680 | 9819 | October 1, 1934 | October 1, 1934 |
| Frank Davenport | 13692 | 9825 | October 1, 1934 | October 1, 1934 |
| Oregon Light, Power & Irr. Co. | 13664 | 9836 | October 1, 1934 | October 1, 1934 |
| Oscar Hukari | 13684 | 9837 | October 1, 1934 | October 1, 1934 |
| Gold Beach Light, Water & Power Co. | 13600 | 9862 | October 1, 1934 | October 1, 1934 |
| Iva Wittman | 13627 | 9863 | October 1, 1934 | October 1, 1934 |
| Harry H. Hixon | 13733 | 9881 | October 1, 1934 | October 1, 1934 |
| Will R. Chalmers | 13751 | 9888 | October 1, 1934 | October 1, 1934 |
| R. K. Seely | 13758 | 9891 | October 1, 1934 | October 1, 1934 |
| W. L. & Iva Frink | 13767 | 9895 | October 1, 1934 | October 1, 1934 |
| T. J. Werth | 13797 | 9913 | | October 1, 1934 |
| W. A. Doney | 13808 | 9921 | October 1, 1934 | October 1, 1934 |
| H. D. Bondy | 13480 | 9928 | October 1, 1934 | October 1, 1934 |
| E. M. Boothby | 13571 | 9931 | October 1, 1934 | October 1, 1934 |

| | | | | |
|---------------------------------|-------|-------|-----------------|-----------------|
| Percy Ritter | 13611 | 9932 | October 1, 1934 | October 1, 1934 |
| Eben Ray | 13754 | 9938 | October 1, 1934 | October 1, 1934 |
| Helen Johnson | 13780 | 9941 | October 1, 1934 | October 1, 1934 |
| J. R. Bunch | 13795 | 9944 | October 1, 1934 | October 1, 1934 |
| Gust Avgers | 13807 | 9946 | October 1, 1934 | October 1, 1934 |
| E. R. Kenny & W. B. Strawn | 13821 | 9953 | October 1, 1934 | October 1, 1934 |
| Robert Wade | 13834 | 9964 | October 1, 1934 | October 1, 1934 |
| Cecil O. Duke | 13847 | 9967 | October 1, 1934 | October 1, 1934 |
| J. N. Watt | 13872 | 9994 | October 1, 1934 | October 1, 1934 |
| M. A. Horn | 13884 | 9996 | October 1, 1934 | October 1, 1934 |
| Chas. & Odille A. Missing | 13897 | 10003 | October 1, 1934 | October 1, 1934 |
| A. W. Brink | 13908 | 10009 | October 1, 1934 | October 1, 1934 |
| Leonie Neill Blair | 13911 | 10010 | October 1, 1934 | October 1, 1934 |
| F. E. Clark | 13920 | 10015 | October 1, 1934 | October 1, 1934 |
| Vernon A. Rugg | 13932 | 10023 | October 1, 1934 | October 1, 1934 |
| Harry L. Coulter | 13940 | 10027 | October 1, 1934 | October 1, 1934 |
| Sarah P. Allyn | 13941 | 10028 | October 1, 1934 | October 1, 1934 |
| Geo. E. Sylvester | 13937 | 10051 | October 1, 1934 | October 1, 1934 |
| Scott Conley Davis | 13315 | 10041 | October 1, 1934 | October 1, 1934 |
| Alvin M. Ohms | 13955 | 10053 | October 1, 1934 | October 1, 1934 |
| R. A. Lierman | 13958 | 10056 | October 1, 1934 | October 1, 1934 |
| J. C. South | 13959 | 10057 | October 1, 1934 | October 1, 1934 |
| Albert M. Thronson | 13964 | 10062 | October 1, 1934 | October 1, 1934 |
| Reid Murdoch & Co. | 13969 | 10065 | October 1, 1934 | October 1, 1934 |
| F. D. Kropf | 14011 | 10082 | October 1, 1934 | October 1, 1934 |
| Paul C. Pommen | 14022 | 10110 | October 1, 1934 | October 1, 1934 |
| John H. & Mary Elsie M. Pearce | 14024 | 10112 | October 1, 1934 | October 1, 1934 |
| E. W. Long | 13915 | 10014 | October 1, 1934 | October 1, 1934 |
| Frank M. Williams | 14038 | 10128 | October 1, 1934 | October 1, 1934 |
| Mrs. Ella Grove | 14039 | 10129 | October 1, 1934 | October 1, 1934 |
| George A. Andrews | 14064 | 10144 | October 1, 1934 | October 1, 1934 |
| Harry Dayton | 14074 | 10149 | October 1, 1934 | October 1, 1934 |
| Marcus Parmenter | 14080 | 10153 | October 1, 1934 | October 1, 1934 |
| Lee L. Hershberger | 14098 | 10159 | October 1, 1934 | October 1, 1934 |
| F. A. Beltz | 14083 | 10180 | October 1, 1934 | October 1, 1934 |
| James A. Lovell | 14106 | 10187 | October 1, 1934 | October 1, 1934 |
| S. J. Taylor | 14114 | 10193 | October 1, 1934 | October 1, 1934 |
| C. I. Jones | 14141 | 10214 | October 1, 1934 | October 1, 1934 |
| Chas. W. Spiering | 14152 | 10219 | October 1, 1934 | October 1, 1934 |
| Lemuel & Sarah I. Feisell | 14160 | 10226 | October 1, 1934 | October 1, 1934 |
| W. T. Small | 13885 | 10234 | October 1, 1934 | October 1, 1934 |
| Overton Dowell Sr. & Son | 14176 | 10249 | October 1, 1934 | October 1, 1934 |
| Warren H. Bailey | 14199 | 10262 | October 1, 1934 | October 1, 1934 |
| Henry Saalfeld | 14203 | 10265 | October 1, 1934 | October 1, 1934 |
| Wm. E. Warren | 14205 | 10266 | October 1, 1934 | October 1, 1934 |
| Howard Dunlap | 14217 | 10274 | October 1, 1934 | October 1, 1934 |
| Geo. H. Atkinson | 14221 | 10278 | October 1, 1934 | October 1, 1934 |
| Oregon Iron & Steel Co. | 14237 | 10285 | October 1, 1934 | October 1, 1934 |
| Howard Stephens | 14246 | 10290 | October 1, 1934 | October 1, 1934 |
| Albert R. Potts | 14255 | 10296 | October 1, 1934 | October 1, 1934 |
| Homer H. Huffman | 14256 | 10297 | October 1, 1934 | October 1, 1934 |
| Salome S. C. Bernstein | 14262 | 10300 | October 1, 1934 | October 1, 1934 |
| C. R. Kruse | 14268 | 10303 | October 1, 1934 | October 1, 1934 |
| Clarence Taylor | 14270 | 10304 | October 1, 1934 | October 1, 1934 |
| Willie H. Kowitz | 14276 | 10310 | October 1, 1934 | October 1, 1934 |
| Joseph Rucek | 14289 | 10314 | October 1, 1934 | October 1, 1934 |
| City of Waldport | 14279 | 10315 | October 1, 1934 | October 1, 1934 |
| Geo. S. Smith | 14204 | 10320 | October 1, 1934 | October 1, 1934 |
| Walter D. Oliver | 14295 | 10321 | October 1, 1934 | October 1, 1934 |
| The Independent Quicksilver CO. | 14239 | 10336 | October 1, 1934 | October 1, 1934 |
| H. Wallen | 14285 | 10345 | October 1, 1934 | October 1, 1934 |
| H. E. Vogel | 14299 | 10350 | October 1, 1934 | October 1, 1934 |

| | | | |
|-----------------------------|-------|-------|-----------------|
| William W. Bennett | 14330 | 10362 | October 1, 1934 |
| Walter M. Hillar | 14344 | 10372 | October 1, 1934 |
| Birdie Williams | 14358 | 10384 | October 1, 1934 |
| Dean L. Stewart | 14373 | 10390 | October 1, 1934 |
| Walter Von Flue | 14380 | 10395 | October 1, 1934 |
| Robert J. Rothenberger | 14390 | 10403 | October 1, 1934 |
| Walter M. Britt | 14395 | 10423 | October 1, 1934 |
| E. B. Fish | 14396 | 10424 | October 1, 1934 |
| C. Vroman & J.P. Hammersley | 14401 | 10428 | October 1, 1934 |
| H. E. Wooden | 14417 | 10437 | October 1, 1934 |
| Iva Wittman | 14420 | 10440 | October 1, 1934 |
| P. Oke Henderson | 14438 | 10445 | October 1, 1934 |

THEREFORE, IT IS ORDERED that the extensions of time as above tabulated
be and the same are hereby granted.

Dated at Salem, Oregon this 17th day of January, 1934.

CHAS. E. STRICKLIN, STATE ENGINEER

STATE OF OREGON
COUNTY OF YAMHILL
CERTIFICATE OF WATER RIGHT

This Is to Certify, That H. O. STULTS

of Route 1, Box 186, McMinnville, , State of Oregon, has made proof to the satisfaction of the STATE ENGINEER of Oregon, of a right to the use of the waters of Salt Creek, tributary of South Yamhill River a tributary of Yamhill River for the purpose of Irrigation under Permit No. 13516 of the State Engineer, and that said right to the use of said waters has been perfected in accordance with the laws of Oregon; that the priority of the right hereby confirmed dates from April 13, 1939;

that the amount of water to which such right is entitled and hereby confirmed, for the purposes aforesaid, is limited to an amount actually beneficially used for said purposes, and shall not exceed 0.13 cubic foot per second,

or its equivalent in case of rotation, measured at the point of diversion from the stream. The point of diversion is located in the NW $\frac{1}{4}$ NE $\frac{1}{4}$, Section 8, Township 5 South, Range 4 West, W. M., being within William J. Garrison D. L. C. 40.

The amount of water used for irrigation, together with the amount secured under any other right existing for the same lands, shall be limited to one-eightieth of one cubic foot per second per acre, or its equivalent for each acre irrigated and shall be further limited to a diversion of not to exceed 2 $\frac{1}{2}$ acre feet per acre for each acre irrigated during the irrigation season of each year,

and shall conform to such reasonable rotation system as may be ordered by the proper state officer.

A description of the place of use under the right hereby confirmed, and to which such right is appurtenant, is as follows:

0.5 acre in the NE $\frac{1}{4}$ NW $\frac{1}{4}$
9.2 acres in the NW $\frac{1}{4}$ NE $\frac{1}{4}$
Section 8
Tp. 5 S., R. 4 W., W. M., being
within William J. Garrison D. L. C. 40.

The right to the use of the water for the purposes aforesaid is restricted to the lands or place of use herein described.

WITNESS the signature of the State Engineer, affixed

this 1st day of July, 1941.

CHAS. E. STRICKLIN

State Engineer

*APPLICATION FOR A PERMIT

To Appropriate the Public Waters of the State of Oregon

I, H. O. Stults
(Name of applicant)
 of McMinnville, R. R. 1, Box 186, County of Yamhill,
(Post office)
 State of Oregon, do hereby make application for a permit to appropriate the
 following described public waters of the State of Oregon, **SUBJECT TO EXISTING RIGHTS:**

If the applicant is a corporation, give date and place of incorporation _____

1. The source of the proposed appropriation is Salt Creek
(Name of stream)
 _____, a tributary of Yamhill River
 2. The amount of water which the applicant intends to apply to beneficial use is _____
 cubic feet per second. 0.3
(If water is to be used from more than one source, give quantity from each)
 - **3. The use to which the water is to be applied is Irrigation
(Irrigation, power, mining, manufacturing, domestic supplies, etc.)
- Any place between the following two pts.
 4. The point of diversion is located 396 ft. South and 34 chs. East from the NW Cor.
(N. or S.) (E. or W.)
corner of Section 8 and 17 chs. South & 46 chs. East from the NW Cor, Section 8,
(Section or subdivision)
(If preferable, give distance and bearing to section corner)
- (If there is more than one point of diversion, each must be described. Use separate sheet if necessary)
 being within the NE $\frac{1}{4}$ of NW $\frac{1}{4}$ & NW $\frac{1}{4}$ of NE $\frac{1}{4}$ of Sec. 8, Tp. 5 S.,
(Give smallest legal subdivision) (N. or S.)
 R. 4 W., W. M., in the county of _____
(E. or W.)
5. ~~The~~ 500' Approx. of Main Line ~~to be~~ & 280 ft. Approx.
(Main ditch, canal or pipe line) (Miles or feet)
 in length, terminating in the of lateral with Sprinklers of Sec. to be _____, ~~to be~~ located in,
(Smallest legal subdivision) (N. or S.)
 above $\frac{1}{4}$ Sections
 R. _____, W. M., the proposed location being shown throughout on the accompanying map.
(E. or W.)

DESCRIPTION OF WORKS

DIVERSION WORKS—

6. (a) Height of dam 4 feet, length on top 24 feet, length at bottom
16 feet; material to be used and character of construction Plank, Dirt
(Loose rock, concrete, masonry,
 rock and brush, timber crib, etc., wasteway over or around dam)

(b) Description of headgate None
(Timber, concrete, etc., number and size of openings)

(c) If water is to be pumped give general description 1 $\frac{1}{2}$ Centrifugal Pump
(Size and type of pump)
& 10 H.P. Gas Engine. 25 ft. Static head.
(Size and type of engine or motor to be used, total head water is to be lifted, etc.)
Seven 3 g.p.m. Sprinklers to be used.

* A different form of application is provided where storage works are contemplated. *

** Applications for permits to appropriate water for the generation of electricity, with the exception of municipalities, must be made to the Hydroelectric Commission. Either of the above forms may be secured, without cost, together with instructions by addressing the State Engineer, Salem, Oregon.

CANAL SYSTEM OR PIPE LINE—

7. (a) Give dimensions at each point of canal where materially changed in size, stating miles from headgate. At headgate: width on top (at water line) feet; width on bottom feet; depth of water feet; grade feet fall per one thousand feet.

(b) At miles from headgate: width on top (at water line)
 feet; width on bottom feet; depth of water feet;
 grade feet fall per one thousand feet.

(c) Length of pipe, 500' ft.; size at intake, 4" Main in.; size at ft. from intake in.; size at place of use 2" lateral in.; difference in elevation between intake and place of use, ft. Is grade uniform? No Estimated capacity, 0.3 sec. ft.

8. *Location of area to be irrigated, or place of use*

[illegible]

(If more space required, attach separate sheet)

(a) Character of soil **Chehalis**

(b) Kind of crops raisedClover

POWER OR MINING PURPOSES—

9. (a) Total amount of power to be developed theoretical horsepower.

(b) Quantity of water to be used for power sec. ft.

(c) Total fall to be utilized feet.
(Head)

(d) *The nature of the works by means of which the power is to be developed*

(e) Such works to be located in _____ of Sec. _____,
(Legal subdivision)

Tr. _____, *R.* _____, *W. M.* _____
(No. N. or S.) (No. E. or W.)

(f) Is water to be returned to any stream? _____
(Yes or No)

(g) If so, name stream and locate point of return

_____, *Sec.* _____, *Tp.* _____, *R.* _____, *W. M.* _____
(No. N. or S.) (No. E. or W.)

(h) *The use to which power is to be applied is*

(i) *The nature of the mines to be served*

MUNICIPAL OR DOMESTIC SUPPLY—

10. (a) To supply the city of _____
 _____ County, having a present population of _____
 (Name of)
 and an estimated populatoin of _____ in 193_____.

(b) If for domestic use state number of families to be supplied _____

(Answer questions 11, 12, 13, and 14 in all cases)

11. Estimated cost of proposed works, \$ 500.00
 12. Construction work will begin on or before Started Spring of 1938
 13. Construction work will be completed on or before Fall of 1939
 14. The water will be completely applied to the proposed use on or before Fall 1940

H. O. Stults

(Signature of applicant)

McMinnville, Oregon, R. 1.

Signed in the presence of us as witnesses:

- (1) Andrew Kneedler, McMinnville, Oregon - R. 1.
 (Name) (Address of witness)
 (2) H. M. Tolsor, McMinnville, Oregon - R. 1.
 (Name) (Address of witness)

Remarks: _____

STATE OF OREGON, }
 County of Marion, } ss.

This is to certify that I have examined the foregoing application, together with the accompanying maps and data, and return the same for _____

In order to retain its priority, this application must be returned to the State Engineer, with corrections on or before _____, 193_____.

WITNESS my hand this _____ day of _____, 193_____.

STATE ENGINEER

Application No. 17895

Permit No. 13516

PERMIT
TO APPROPRIATE THE PUBLIC
WATERS OF THE STATE
OF OREGON

Division No. District No.

This instrument was first received in the
office of the State Engineer at Salem, Oregon,
on the 13th day of April
1939, at 8:00 o'clock A. M.

Returned to applicant:

Corrected application received:

Approved:

May 6, 1939

Recorded in book No. 38 of

Permits on page 13516

CHAS. E. STRICKLIN
STATE ENGINEER

Drainage Basin No. 2 Page 90D

Fees Paid \$9.50

STATE OF OREGON, }
County of Marion, } ss.

PERMIT

This is to certify that I have examined the foregoing application and do hereby grant the same,
SUBJECT TO EXISTING RIGHTS and the following limitations and conditions:

The right herein granted is limited to the amount of water which can be applied to beneficial use
and shall not exceed 0.13 cubic feet per second measured at the point of diversion from the
stream, or its equivalent in case of rotation with other water users, from

Salt Creek

The use to which this water is to be applied is Irrigation

If for irrigation, this appropriation shall be limited to 1/80th of one cubic foot per
second or its equivalent for each acre irrigated and shall be further limited to a
diversion of not to exceed 2 1/2 acre feet per acre for each acre irrigated during the
irrigation season of each year,

and shall be subject to such reasonable rotation system as may be ordered by the proper state officer.

The priority date of this permit is April 13, 1939

Actual construction work shall begin on or before May 6, 1940 and shall
thereafter be prosecuted with reasonable diligence and be completed on or before
October 1, 1941

Complete application of the water to the proposed use shall be made on or before
October 1, 1942

WITNESS my hand this 6th day of May, 1939

CHAS. E. STRICKLIN

STATE ENGINEER

SECTION

TOWNSHIP 55 , RANGE 4W , W. M.

North

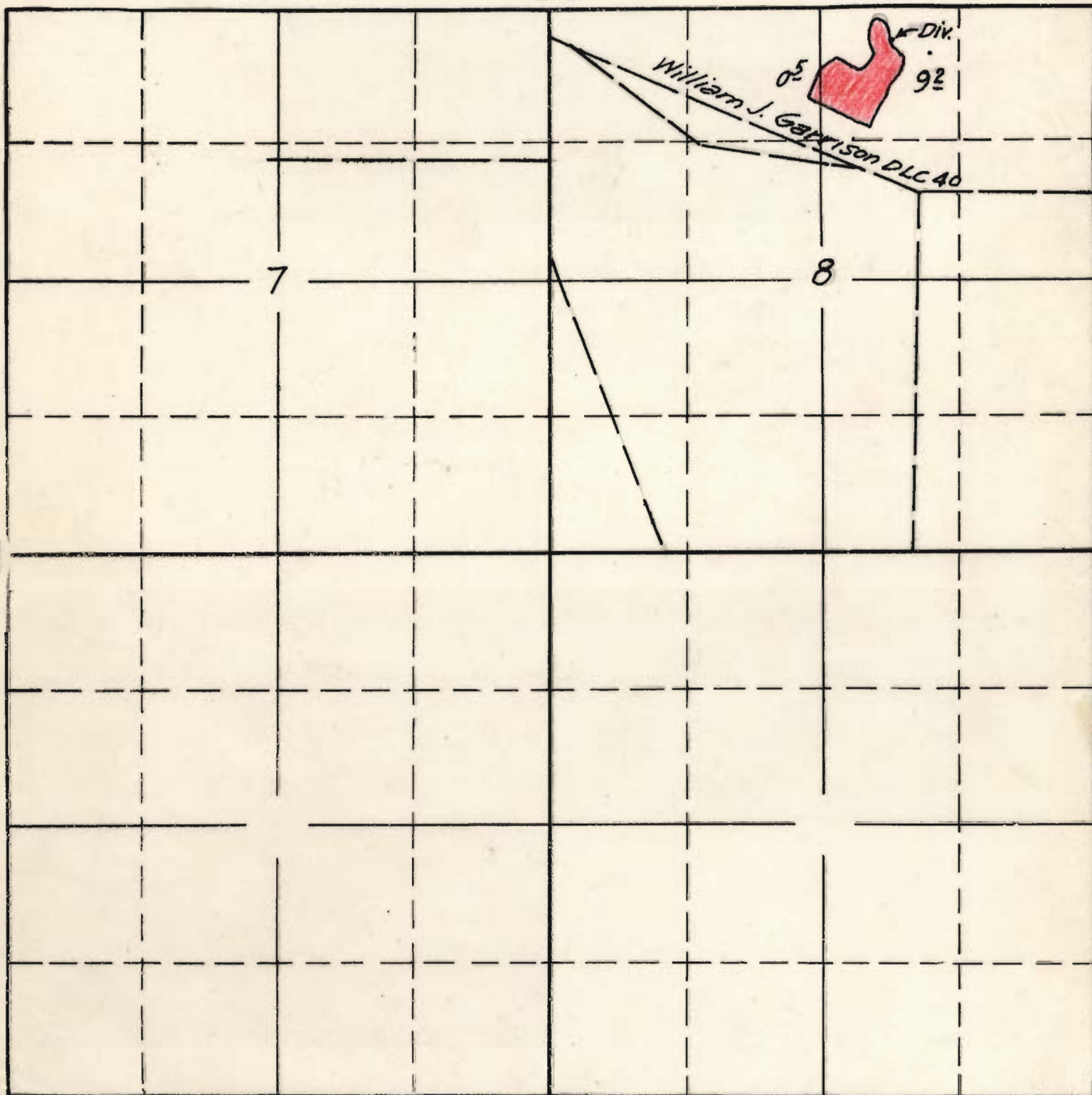

Surveyed June 8 1940 C.A.C.

South

APPLICATION No. 17895
PERMIT No. 13516

