

Soils Map

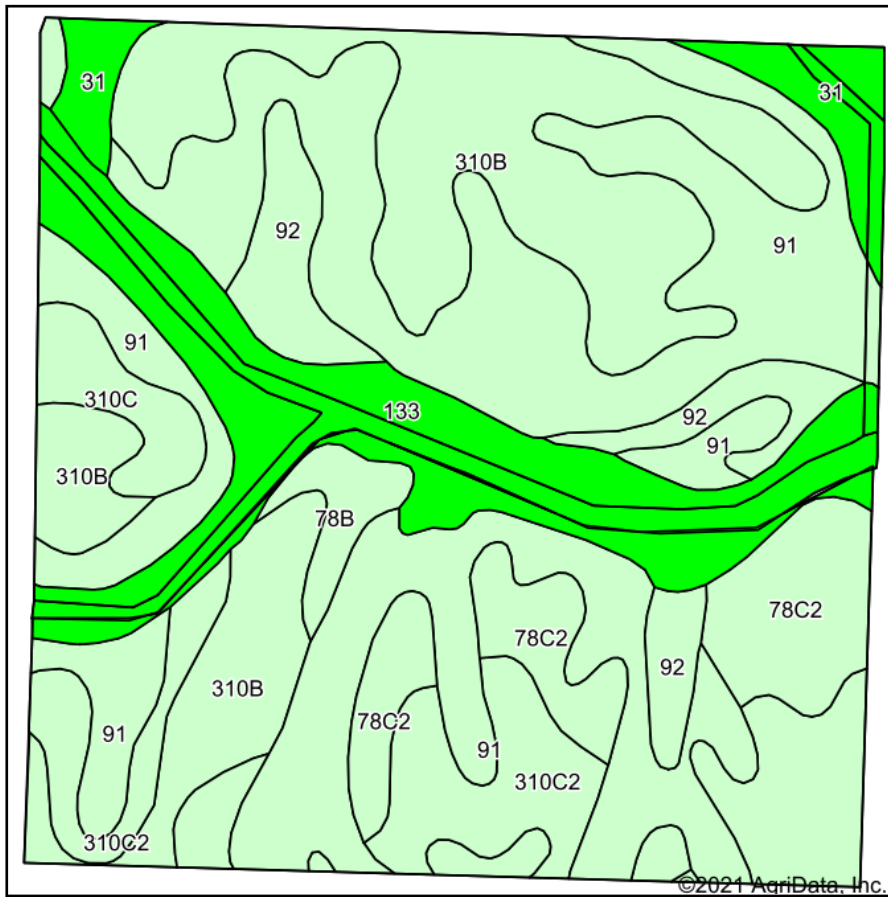

Soils data provided by USDA and NRCS.

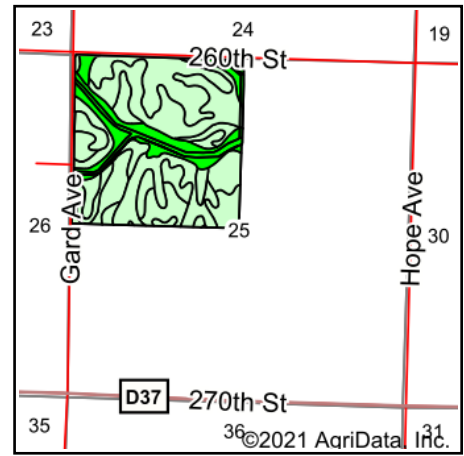

State: **Iowa**
 County: **Sac**
 Location: **25-88N-38W**
 Township: **Cook**
 Acres: **153.17**
 Date: **1/3/2021**

Green Real Estate & Auction Co.
 SAC CITY, IA 712-662-4442
greenrealestate-auction.com

Maps Provided By:
surety
 CUSTOMIZED ONLINE MAPPING
 © AgriData, Inc. 2020 www.AgriDataInc.com



Code	Soil Description	Acres	Percent of field	CSR2 Legend	Non-Irr Class *c	CSR2**	CSR
91	Primghar silty clay loam, 0 to 2 percent slopes	51.60	33.7%		Iw	100	84
310B	Galva silty clay loam, 2 to 5 percent slopes	38.08	24.9%		Ile	95	75
133	Colo silty clay loam, deep loess, 0 to 2 percent slopes, occasionally flooded	21.29	13.9%		Ilw	78	77
310C2	Galva silty clay loam, 5 to 9 percent slopes, eroded	11.84	7.7%		IIle	84	57
78C2	Sac silty clay loam, 5 to 9 percent slopes, eroded	11.78	7.7%		IIle	82	54
92	Marcus silty clay loam, 0 to 2 percent slopes	7.87	5.1%		Ilw	94	80
31	Afton silty clay loam, 0 to 2 percent slopes, occasionally flooded	5.06	3.3%		Ilw	80	77
310C	Galva silty clay loam, 5 to 9 percent slopes	3.34	2.2%		IIle	87	59
78B	Sac silty clay loam, 2 to 5 percent slopes	2.31	1.5%		Ile	89	71
Weighted Average						91.7	75.2

**IA has updated the CSR values for each county to CSR2.

*c: Using Capabilities Class Dominant Condition Aggregation Method

Soils data provided by USDA and NRCS.

FARM # 1 - SOIL MAP