

# Soils Map

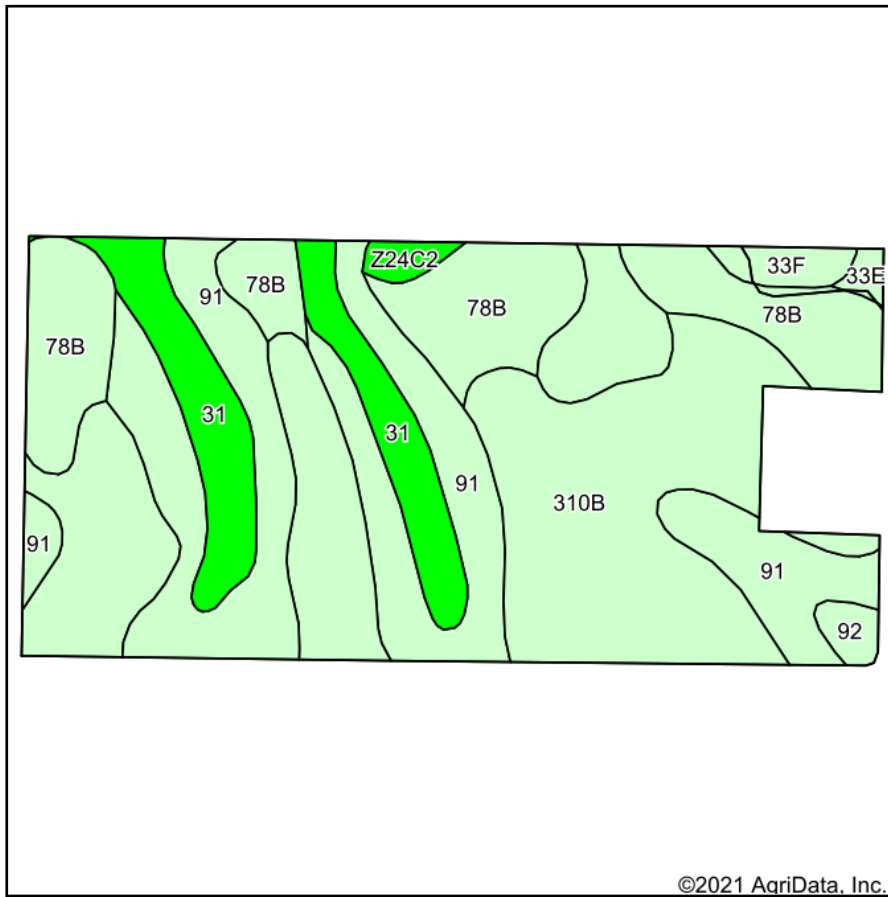

Soils data provided by USDA and NRCS.

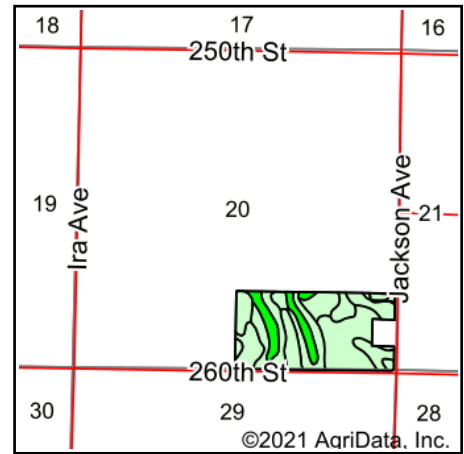

State: **Iowa**  
 County: **Sac**  
 Location: **20-88N-37W**  
 Township: **Boyer Valley**  
 Acres: **72.77**  
 Date: **1/3/2021**



Code	Soil Description	Acres	Percent of field	CSR2 Legend	Non-Irr Class *c	CSR2**	CSR
310B	Galva silty clay loam, 2 to 5 percent slopes	26.40	36.3%		Ile	95	75
91	Primghar silty clay loam, 0 to 2 percent slopes	22.31	30.7%		Iw	100	84
78B	Sac silty clay loam, 2 to 5 percent slopes	13.41	18.4%		Ile	89	71
31	Afton silty clay loam, 0 to 2 percent slopes, occasionally flooded	7.94	10.9%		Ilw	80	77
33F	Steinauer loam, 18 to 40 percent slopes	1.03	1.4%		Vle	5	8
92	Marcus silty clay loam, 0 to 2 percent slopes	0.69	0.9%		Ilw	94	80
Z24C2	Shelby clay loam, deep loess, 5 to 9 percent slopes, eroded	0.62	0.9%		IIIe	76	
33E	Steinauer loam, 9 to 18 percent slopes	0.37	0.5%		IVe	26	31
Weighted Average						92	*-

\*\*IA has updated the CSR values for each county to CSR2.

\*- CSR weighted average cannot be calculated on the current soils data, use prior data version for csr values.

\*c: Using Capabilities Class Dominant Condition Aggregation Method

Soils data provided by USDA and NRCS.

## FARM # 2 - SOIL MAP